



electronic touch controls • climatekeeper™ system • 2004 merchandising • integrated ice™ system • customcool™ technology

GE Profile™ and GE CustomStyle™ Refrigerators

Built-in appearance. Outstanding performance.

imagination at work





The Ultimate in Refrigeration.™



If you want a built-in look, without the built-in expense, GE offers a couple of **fitting solutions**. A GE Profile™ or new GE CustomStyle™ refrigerator **makes the most of your kitchen space** by blending in almost seamlessly with surrounding cabinetry. It **gives you the style you want** and features you need, without the cost and inconvenience of a kitchen redo. For a sleek, **modern appearance**, choose stainless or acrylic panels. Or, achieve a **custom look** with cabinet-matching wood panels. Whatever style you prefer, you'll find a CustomStyle refrigerator that **works beautifully with your décor and budget**.



**Standard
Side-by-Side**



**CustomStyle
Side-by-Side**

GE Profile CustomStyle™ side-by-side refrigerators make an impressive design statement, without standing out.

CustomStyle side-by-side models are the perfect solution for today's open-living kitchen designs. They extend only 26 3/4" from the wall, saving more than six inches of floor space.

GE Profile Arctica® and GE CustomStyle™ Side-by-Sides

An impressive design statement, without standing out.

For a built-in look, without the built-in expense, here's a fitting solution. A GE Profile CustomStyle™ refrigerator makes the most of your kitchen space by blending in almost seamlessly with surrounding cabinetry. It gives you the style you want and features you need, without the cost and inconvenience of remodeling. For a sleek, modern appearance, choose stainless or acrylic panels. Or, achieve a custom look with cabinet-matching wood panels. Whatever style you prefer, you'll find a CustomStyle refrigerator that works beautifully with your decor and budget.



Installed-trim side-by-side models

Designed for today's discriminating consumers.

CustomStyle refrigerators with installed trim accept stainless steel or acrylic panels in white, black or bisque, all of which can be ordered from GE. To achieve a custom look, you can order wood panels from your cabinetmaker. You'll discover all kinds of ways to enhance your kitchen.



Optional Panels

Choose stainless steel panels or acrylic panels in white, bisque or black.



Custom Wood Panels

Make and install your own custom wood panels to accent cabinetry.

Optional collar trim: adding the final touch.

The optional collar trim is just another way GE lets you integrate our CustomStyle refrigerators into your kitchen decor. Available in stainless steel, white, bisque and black, this trim frames the refrigerator facade, adding to the finished look of a built-in, custom kitchen.

Collar Trim

Model No.	Black Collar Trim	White Collar Trim	Bisque Collar Trim	Stainless Steel Collar Trim
PSI23NCP	TRMBISBB	TRMBISWW	TRMBISCC	—
PSI23SCR	—	—	—	TRMBISS
PSI23MGP	TRMBISBB	TRMBISWW	TRMBISCC	—
PSI23NGP	TRMBISBB	TRMBISWW	TRMBISCC	—
PSI23SGR	—	—	—	TRMBISS
PSH23PSR	—	—	—	TRMBISS
PSH23PGR	TRMBISBB	TRMBISWW	TRMBISCC	—

Acrylic and Stainless Steel Panels

Model No.	Black Acrylic Panels	White Acrylic Panels	Bisque Acrylic Panels	Stainless Steel Panels
PSI23NCP	PSPK23CBB	PSPK23CWW	PSPK23CCC	—
PSI23MGP	PSPK23DBB	PSPK23DWW	PSPK23DCC	PSPK23DSS
PSI23NGP	PSPK23DBB	PSPK23DWW	PSPK23DCC	PSPK23DSS
PSH23PGR	PSPK23DBB	PSPK23DWW	PSPK23DCC	PSPK23DSS

Trimless side-by-side models

Installation made easy: simply slide in.

Trimless CustomStyle units install by simply sliding into—way into—the space between cabinets. They align with counters, instantly look built-in, with nothing to attach or build. (Available in stainless steel, white, bisque and black.)



Installed-trim side-by-side models

Dispenser Models



PSH23PGR

Shown with optional black acrylic panels. Available in white, bisque or black.

Model PSH23PGR is **ENERGY STAR®-qualified**.



PSI23NGP

Shown with custom wood panels. Available in white, bisque or black.



PSI23MGP

Shown with optional white acrylic panels. Available in white, bisque or black.



PSI23MGP

Shown with custom wood panels. Available in white, bisque or black.

Non-Dispenser Models

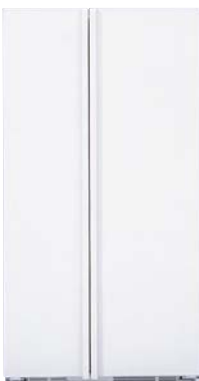

PSI23NCP

Shown with optional white acrylic panels. Available in white, bisque or black.



PSI23NCP

Shown with custom wood panels. Available in white, bisque or black.

Trimless side-by-side models

Dispenser Models



PSW23PSR

Stainless-wrapped with sculptured stainless steel handles.

Model PSW23PSR is **ENERGY STAR®-qualified**.



PSC23SHR

Stainless steel with sculptured stainless steel handles.



PSC23NHP

Available in white, bisque or black.



PSC23SGR

Stainless steel with sculptured stainless steel handles.



PSC23NGP/ PSC23MGP

Available in white, bisque or black.



PSH23PSR/PSI23SGR

Stainless steel with full-length visor handles.

Model PSH23PSR is **ENERGY STAR®-qualified**.

Non-Dispenser Model



GSC23LSR

Stainless steel with tubular handles. Available in stainless or white and black as GSC23LGQ.



GSC22KGR

Available in white or black.



PSI23SCR

Stainless steel with full-length visor handles.

Feature gallery.

Freshness at every level.



QuickSpace™ shelf

Quickly slides out of the way to make room for tall items.



Tall LightTouch! dispenser

Accommodates tall glassware and dispenses water and ice at the slightest touch.



SmartWater™ filtration system

Delivers clean, great-tasting water and ice through the LightTouch! dispenser.



It chills!

ONLY GE HAS IT!

Full-extension bin with CustomCool™ technology

Chills in minutes, thaws in hours and helps keep foods fresher, longer. For added convenience, it opens fully to allow easy access. (Limited lifetime warranty* on slides)



It thaws!



It preserves!



It fully extends!



Model PSW23PSR

*See written warranty for details.



Upfront electronic controls with digital temperature readout

Are precise and easy to use. Takes the guesswork out of selecting accurate temperatures.



TurboCool™ feature

Quickly cools the refrigerator after frequent door openings or when hot items are placed inside.

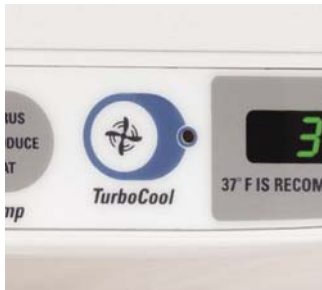

In-the-door beverage rack

Conveniently located inside the refrigerator door to increase flexibility and free up valuable shelf space.



Adjustable ClearLook™ bins

Hold gallon-size containers with style and ease, freeing up valuable shelf space.



Slide-out, spillproof glass shelves

Simplify loading, unloading and cleaning.



ONLY GE HAS IT!

ClimateKeeper™ system

Combines electronic touch controls, multiple electronic sensors and a multiframe air system to keep temperatures consistent and help preserve foods. The Best Temperature Management System You Can Buy!



Integrated shelf support system

Designed so that shelves are securely integrated into the cabinet, yet slide out with ease. It makes versatile use of every inch of storage space.

The inside story.

Freshness at every level.



ONLY GE HAS IT!

Integrated Ice™ system

The ice bucket is integrated into the icemaker, not the freezer door, freeing up valuable storage space. Tilt-down feature provides easy access to cubed ice.



ONLY GE HAS IT!

Slide 'n Store™ full-extension freezer baskets

Extends 16" for easy loading and unloading.



Model PSW23PSR



FrostGuard™ technology

Reduces defrosting to protect frozen items from freezer burn, monitoring door openings and defrosting only when needed.



NeverClean™ condenser

Condenser coils are encased, so they don't require cleaning in normal operating environments.



Deluxe Quiet Design

Significantly reduces operating noise, so the refrigerator doesn't intrude on dinner conversations.



ENERGY STAR®-qualified

PSW23PSR

PSH23PGR

PSH23PSR

Introducing GE CustomStyle™ Refrigerators.

New GE CustomStyle refrigerators **set your kitchen apart**, without standing out. Installed alongside counters or between cabinets, these refrigerators offer a stunning look that **enhances your décor** and **saves floor space**. Simply choose the style that best fits your style and budget: **stainless steel** with tubular handles, **white** or **black**.



GSC23LSRSS
Stainless steel with
tubular handles



GSC23LGQWW
White on white



GSC23LGQBB
Black on black



GSC22KGRWW
White on white



GSC22KGRBB
Black on black



Trimless side-by-side models

Installation made easy, simply slide in.

Trimless CustomStyle units install by simply sliding into—way into—the space between cabinets.

They align with counters, instantly look built-in, with nothing to attach or build.

Feature Gallery—GE CustomStyle Side-by-Sides



TurboCool™ feature

Quickly cools the refrigerator after frequent door openings or when hot items are placed inside.



Upfront electronic touch temperature controls

Are easy to see and to set.



QuickSpace™ shelf

Quickly slides out of the way to make room for tall items.



ClearLook™ adjustable gallon door bins

Provides maximum storage flexibility.



ONLY GE HAS IT!

FrostGuard™ technology

Reduces freezer burn, so foods retain their texture and flavor.



ONLY GE HAS IT!

Integrated Ice™ system

The ice bucket is integrated into the icemaker, not the freezer door, freeing up valuable storage space. Tilt-down feature provides easy access to cubed ice.



GE Profile Arctica CustomStyle™ Side-by-Side Installation Information & Specifications

Rough-In Dimensions

Standard, New Construction and Replacement Installation

Installation Tips to Maximize the Built-In Look

- All wall/floor molding should be removed prior to installation.
- Water recess on rear wall recommended to prevent water line damage. 48" minimum length, 1/4"-diameter water line tubing recommended.
- When possible, recess both copper water line and electrical outlet (see local codes).
- Front and rear leveling legs are adjustable for the built-in look (see owner's manual).
- If optional collar trim kit is to be used or anticipated, see collar trim installation on next page for different rough-in dimensions.

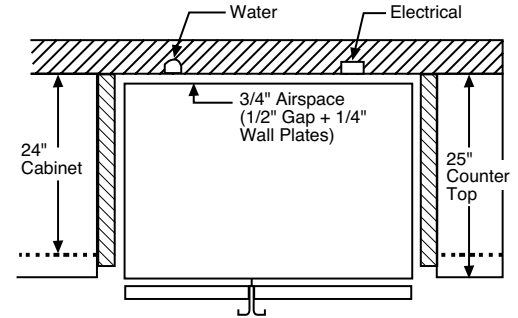
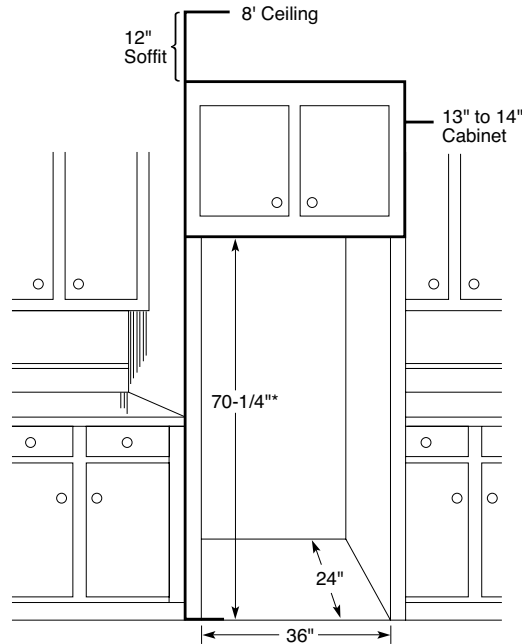

*The rough-in dimension of 70-1/4\" is minimum and is measured from the finished floor to top of opening (or the underside of the overhead cabinets). For Models with Trim Kit: If frameless style cabinets are planned for above the refrigerator, you may need to consider adding a maximum of 1/4\" (70-1/2\") to height of opening to allow additional clearance between cabinet doors and top of refrigerator trim when cabinet doors are in open position.

Installation of Water Outlets

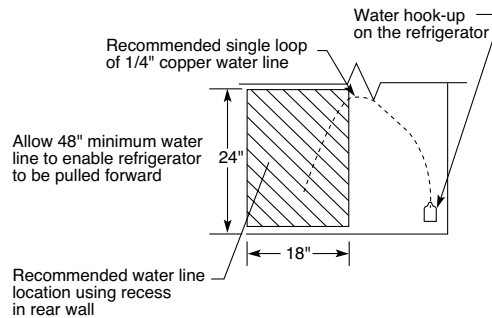
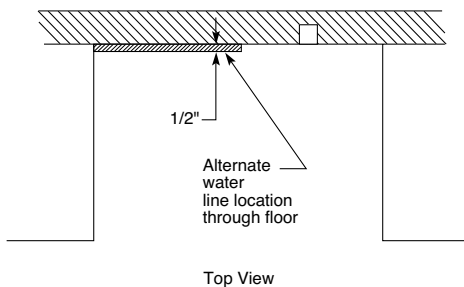

IMPORTANT: Before finalizing specifications for your GE Profile CustomStyle Refrigerator, please NOTE:

- A minimum width of 36\" is required for refrigerator installation
- Be sure to allow for 1/2\" or 3/4\" side panels in addition to the 36\" minimum

Create a Custom Look for Your GE Profile CustomStyle Side-by-Side Refrigerator

Still another advantage offered by GE Profile CustomStyle Refrigerators is ease of installation. For a refrigerator that does so much to enhance the beauty of your kitchen, the “behind-the-scenes” preparation and installation are surprisingly simple.

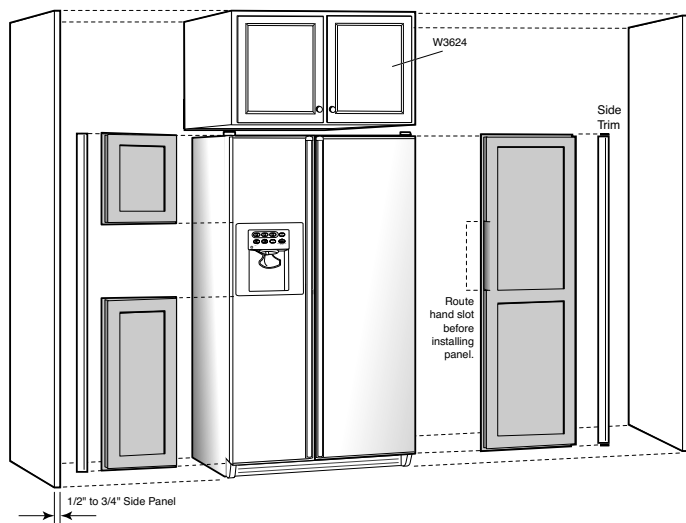

Fabricating the Enclosure

- The drawing shows an 84\" cabinet elevation. Adjust dimensions accordingly for other cabinet elevations.
- Cabinet pieces to order: (2) side panels and (1) wall cabinet.
- Side panels will typically be attached to adjacent cabinets and/or cleated to rear wall and floor.
- Refer to GE refrigerator installation instructions for proper plumbing, and electrical and air clearances.
- (1) Some framed cabinet lines will make a refrigerator enclosure with a cabinet 12\" high x 39\" wide with sides and 1-1/2\" face frame extended down to floor to create the refrigerator space. This will replace the above construction.
- (2) A tall cabinet on either side of the refrigerator can replace a side panel.
- Counter overhangs on either side of the refrigerator should have clipped corners to allow for full door swing.
- If the refrigerator has a wall returning beyond the front of the refrigerator on either side, a 2\" tall filler will help allow for movement of the door.

Door Panels

- See drawings for exact dimensions of the fresh-food and freezer door panels.
- Refrigerator door fronts from stock and most semi-custom cabinet manufacturers will be supplied as 1/4\"-thick panels cut to dimensions, with closest available standard door sizes applied to front.
 - This will leave a “reveal” at top/bottom and sides. Width of “reveal” will depend on manufacturer’s standard door sizes.
 - Door will be affixed on the 1/4\" panels at factory or in the field by the local supplier, depending on manufacturer.
- Local shop-built or custom cabinet supplier may fabricate custom 3/4\" panels. In this case, edges must be routed.
- Follow notes on drawing to assure room for fingers/hands to open handles.

Door Panel Dimensions

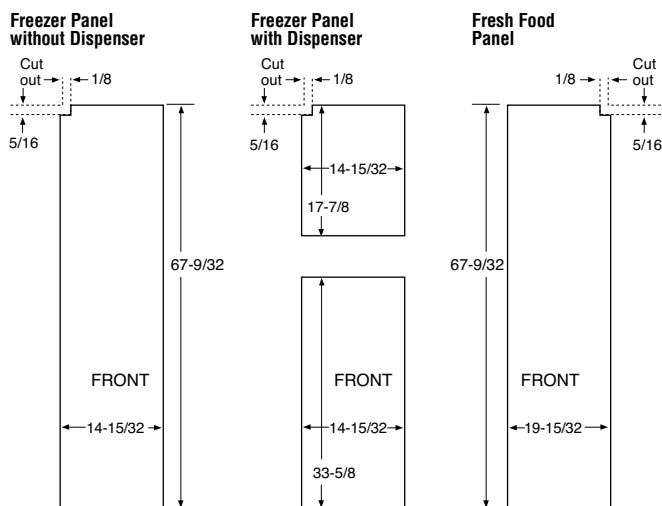

Order your own custom wood panels to match cabinetry or other decor.

Panels up to 1/4" thick will fit door frame with no special preparation. Add filler behind material thinner than 1/4" for proper fit.

Weight Limits: Total weight of panels (i.e., both freezer panels)—Fresh Food = 38 lbs., Freezer = 28 lbs.

Note: Panels up to 3/4" will require special routing area around handles. Dimensions may vary depending on depth of panel.

Detail C

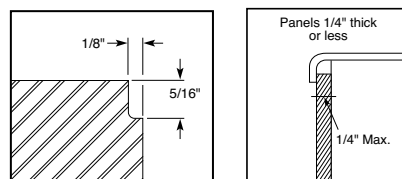

(Fresh Food panel shown)
Notch required at top corner as noted.

Collar Trim Installation

An enclosure is **required** to match up to the trim (see Typical Installation). To obtain the most integrated look, the cabinet or soffit above the refrigerator should extend out to the same depth as the side panels. The refrigerator opening must have minimum dimensions of 70-1/4" high x 36-1/8" wide x 24-1/2" deep as shown at right. If there is an overhead cabinet, allow 1" for cabinet door clearance with the top trim piece so the cabinet doors can be opened without hitting the top trim. If 1/2" side panels are used, then side trim and panel will be even. If 3/4" side panels are used, then some of the side panel will extend beyond the trim and must be finished.

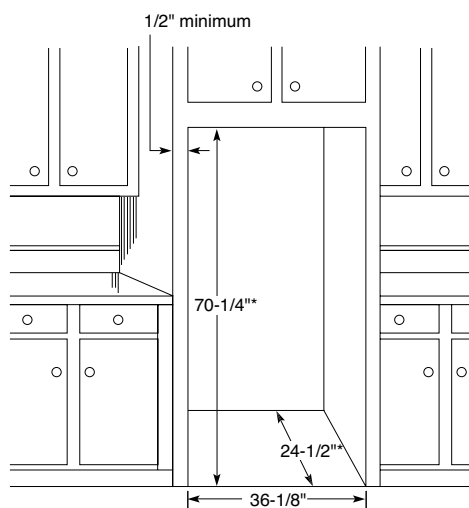

*The rough-in dimension of 70-1/4" is minimum and is measured from the finished floor to top of opening (or the underside of the overhead cabinets). For Models with Trim Kit: If frameless style cabinets are planned for above the refrigerator, you may need to consider adding a maximum of 1/4" (70-1/2") to height of opening to allow additional clearance between cabinet doors and top of refrigerator trim when cabinet doors are in open position.

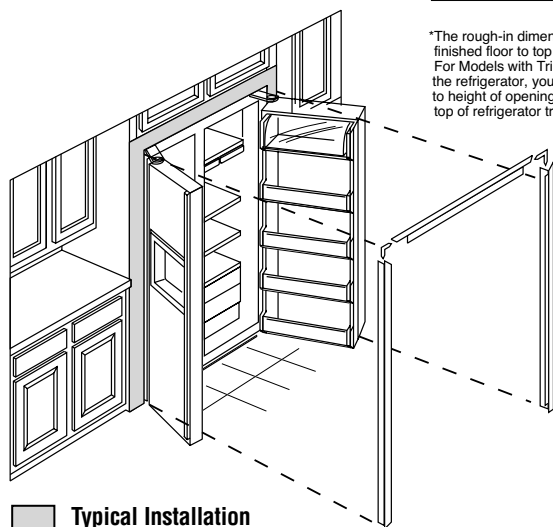
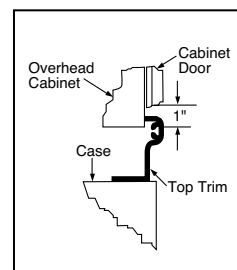
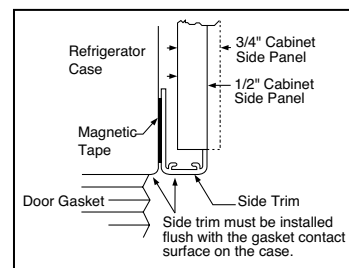

Typical Installation

Shaded areas represent front surfaces of side panels and overhead cabinet or soffit that contacts trim.

IMPORTANT: Before finalizing specifications for your GE Profile CustomStyle Refrigerator, please NOTE:

- A minimum width of 36-1/8" is required for refrigerator installation with collar
- Be sure to allow for 1/2" or 3/4" side panels in addition to the 36-1/8" minimum

GE Profile Arctica® and GE CustomStyle™ Side-by-Side Refrigerators

	GE Profile									
	PSW23PSR	PSH23PSR	PSH23PGR	PSC23SHR	PSC23NHP	PSI23SGR	PSI23NGP	PSC23SGR	PSC23NGP	
Stainless steel model	●	●		●		●		●		
Capacity										
Total (cu. ft.)	22.6	22.6	22.6	22.6	22.6	22.6	22.6	22.6	22.6	
Fresh food (cu. ft.)	14.23	14.23	14.38	14.38	14.38	14.38	14.38	14.38	14.38	
Freezer (cu. ft.)	8.38	8.38	8.38	8.17	8.17	8.24	8.24	8.17	8.17	
Shelf area (sq. ft.)	19.7	19.7	19.7	19.7	19.7	19.7	19.7	19.7	19.7	
Fresh Food Features										
Refreshment center				●	●					
ClimateKeeper™ system	ClimateKeeper ² ™	ClimateKeeper ²	ClimateKeeper ²	●	●	●	●	●	●	
Dual evaporator	●	●	●	●	●	●	●	●	●	
Multiflow air system	●	●	●	●	●	●	●	●	●	
Upfront electronic digital temp. display	●	●	●	●	●	●	●	●	●	
Upfront electronic touch temp. controls	●	●	●	●	●	●	●	●	●	
Electronic sensors	●	●	●	●	●	●	●	●	●	
TurboCool™ setting	●	●	●	●	●	●	●	●	●	
SmartWater™ filtration system	Plus	Plus	Plus	Plus	Plus	Plus	Plus	Plus	Plus	
LightTouch! dispenser	Crushed Ice, Cubes, Water	Crushed Ice, Cubes, Water	Crushed Ice, Cubes, Water	Crushed Ice, Cubes, Water	Crushed Ice, Cubes, Water	Crushed Ice, Cubes, Water	Crushed Ice, Cubes, Water	Crushed Ice, Cubes, Water	Crushed Ice, Cubes, Water	
Light	●	●	●	●	●	●	●	●	●	
Child lock	●	●	●	●	●	●	●	●	●	
Door alarm	●	●	●	●	●	●	●	●	●	
Quick Ice™ feature	●	●	●	●	●	●	●	●	●	
Water filter indicator light	●	●	●	●	●	●	●	●	●	
Cabinet shelves	3 Glass	3 Glass	3 Glass	3 Glass	3 Glass	3 Glass	3 Glass	3 Glass	3 Glass	
Adjustable	3	3	3	3	3	3	3	3	3	
Slide-out, spillproof	2	2	2	2	2	2	2	2	2	
QuickSpace™ shelf	●	●	●	●	●	●	●	●	●	
Integrated shelf support system	●	●	●	●	●	●	●	●	●	
Snuggler™ clip(s)	2	2	2	1	1	2	2	2	2	
3-Stack drawer system	●	●	●	●	●	●	●	●	●	
Deli drawer	Adj. Temp.	Adj. Temp.	Adj. Temp.	Adj. Temp.	Adj. Temp.	Adj. Temp.	Adj. Temp.	Adj. Temp.	Adj. Temp.	
Vegetable/fruit crisper	Adj. Humidity	Adj. Humidity	Adj. Humidity	Adj. Humidity	Adj. Humidity	Adj. Humidity	Adj. Humidity	Adj. Humidity	Adj. Humidity	
Sealed drawer	CustomCool™ w/full-extension	CustomCool w/full-extension	CustomCool w/full-extension	CustomCool w/full-extension	CustomCool w/full-extension	CustomCool w/full-extension	CustomCool w/full-extension	CustomCool w/full-extension	CustomCool w/full-extension	
ClearLook™ door bins	4 (3 Adj.)	4 (3 Adj.)	4 (3 Adj.)	3 (1 Adj.)	3 (1 Adj.)	4 (3 Adj.)	4 (3 Adj.)	4 (3 Adj.)	4 (3 Adj.)	
Dairy compartment (removable)	●	●	●	●	●	●	●	●	●	
Beverage rack	In-the-door	In-the-door	In-the-door	Can storage rack	Can storage rack	In-the-door	In-the-door	In-the-door	In-the-door	
Interior light system	Tri-level	Tri-level	Tri-level	Tri-level	Tri-level	Tri-level	Tri-level	Tri-level	Tri-level	
Quiet Design	Premium	Premium	Premium	Premium	Premium	Premium	Premium	Premium	Premium	
NeverClean™ condenser	●	●	●	●	●	●	●	●	●	
ENERGY STAR®	●	●	●							
Freezer Features										
FrostGuard™ technology	●	●	●	●	●	●	●	●	●	
Factory-installed icemaker	Integrated Ice™	Integrated Ice	Integrated Ice	Integrated Ice	Integrated Ice	Integrated Ice	Integrated Ice	Integrated Ice	Integrated Ice	
Wire slide-out baskets	4 (3 full-ext.)	4 (3 full-ext.)	4 (3 full-ext.)	4 (3 full-ext.)	4 (3 full-ext.)	4 (3 full-ext.)	4 (3 full-ext.)	4 (3 full-ext.)	4 (3 full-ext.)	
Wire cabinet shelves	2	2	2	2 (1 slide-out)	2 (1 slide-out)	2 (1 slide-out)	2 (1 slide-out)	2 (1 slide-out)	2 (1 slide-out)	
Wire tilt-out door bin(s)	3 (2 Adj.)	3 (2 Adj.)	3 (2 Adj.)	3 (2 Adj.)	3 (2 Adj.)	3 (2 Adj.)	3 (2 Adj.)	3 (2 Adj.)	3 (2 Adj.)	
Door shelves										
Interior light	Dual	Dual	Dual	Dual	Dual	Dual	Dual	Dual	Dual	
Exterior										
Color(s) available*	SS	SV	WW, CC, BB	SS	WW, CC, BB	SV	WW, CC, BB	SS	WW, CC, BB	
CustomStyle™ configuration	Trimless	Trimless	Trimless	Trimless	Trimless	Trimless	Trimless	Trimless	Trimless	
Door handles*	Sculptured stainless steel	Full-length visor	CM Full-length visor	Sculptured stainless steel	CM Profile	Full-length visor	CM Full-length visor	Sculptured stainless steel	CM Profile	
Exterior design	Full-wrap contoured	Squared doors	Squared doors	Rounded doors	Rounded doors	Squared doors	Squared doors	Rounded doors	Rounded doors	
Textured steel door and case		Case only (black)	●	Case only (black)	●	Case only (black)	Case only	Case only (black)	●	
Adjustable rollers	All	All	All	All	All	All	All	All	All	
Weights & Dimensions										
Height to top of hinge (in.) A	70-1/2†	69-1/4	69-1/4	69-1/4	69-1/4	69-1/4	69-1/4	69-1/4	69-1/4	
Height to top of case (in.) B	70-1/2	68-3/4	68-3/4	68-3/4	68-3/4	68-3/4	68-3/4	68-3/4	68-3/4	
Height to top of door trim (in.)		70-1/4	70-1/4			70-1/4	70-1/4			
Case depth without door (in.) C	24-3/8	23-7/8	23-7/8	23-7/8	23-7/8	23-7/8	23-7/8	23-7/8	23-7/8	
Case depth less door handle (in.) D	27-1/4	26-3/4	26-3/4	26-3/4	26-3/4	26-3/4	26-3/4	26-3/4	26-3/4	
Case depth with door handle (in.) E	29-11/16	28-5/16	28-5/16	29-3/16	29-3/16	28-5/16	28-5/16	29-3/16	29-3/16	
Depth w/fresh food door open 90° (in.) F	46-1/16	45-9/16	45-9/16	45-9/16	45-9/16	45-9/16	45-9/16	45-9/16	45-9/16	
Width (in.) G	36-3/16††	35-3/4	35-3/4	35-3/4	35-3/4	35-3/4	35-3/4	35-3/4	35-3/4	
Width w/door open 90° w/door handle (in.) H	41-5/16	40	40	41	41	40	40	41	41	
Air clearances	Each side (in.)	1/8	1/8	1/8	1/8	1/8	1/8	1/8	1/8	
Top (in.)	1	1	1	1	1	1	1	1	1	
Back (in.)	1	1	1	1/2	1/2	1/2	1/2	1/2	1/2	
Approx. shipping weight (lbs.)	350	338	338	334	334	334	334	334	334	
Power/Rating	120V, 60Hz, 15Amps									
Accessories										
Factory trim kit attached	N/A	N/A	●	N/A	N/A	N/A	●	N/A	N/A	
Black acrylic panels (optional)	N/A	N/A	PSPK23DBB	N/A	N/A	N/A	PSPK23DBB	N/A	N/A	
White acrylic panels (optional)	N/A	N/A	PSPK23DWW	N/A	N/A	N/A	PSPK23DWW	N/A	N/Av	
Bisque acrylic panels (optional)	N/A	N/A	PSPK23DCC	N/A	N/A	N/A	PSPK23DCC	N/A	N/A	
Stainless steel panels (optional)	N/A	N/A	PSPK23DSS	N/A	N/A	N/A	PSPK23DSS	N/A	N/A	
Black collar trim (optional)	N/A	N/A	TRMBISBB	N/A	N/A	N/A	TRMBISBB	N/A	N/A	
White collar trim (optional)	N/A	N/A	TRMBISWW	N/A	N/A	N/A	TRMBISWW	N/A	N/A	
Bisque collar trim (optional)	N/A	N/A	TRMBISCC	N/A	N/A	N/A	TRMBISCC	N/A	N/A	
Stainless steel collar trim (optional)	N/A	TRMBISS	N/A	N/A	N/A	TRMBISS	N/A	N/A	N/A	

*Color(s) available: SV = Stainless steel with visor handles, SS = Stainless steel, WW = White on white, CC = Bisque on bisque, BB = Black on black, CM = Color-Matched.

†When cap is removed: 69-1/4". ††Width excluding caps: 35-7/8".

If installed against a wall, allow clearance of 13-15/16" on freezer side to remove bin. Clearance required to remove fresh food full size pan without disassembling is 18-5/8".

ALL MODELS AVAILABLE IN U.S. AND CANADA.

					GE®		
	PSI23SCR	PSI23NCP	PSC23MGP	PSI23MGP	GSC23LSR	GSC23LGQ	GSC22KGR
	●				●		
	22.6	22.6	22.7	22.7	22.7	22.7	22.1
	14.38	14.38	14.38	14.38	14.38	14.38	14.25
	8.19	8.19	8.26	8.26	8.26	8.26	7.83
	20.6	20.6	19.0	19.0	18.5	18.5	18.2
	●	●	●	●			
	●	●	●	●			
	●	●	●	●	●	●	●
	●	●	●	●	●	●	●
	●	●	●	●	●	●	●
			Plus	Plus	Plus	Plus	Plus
			Crushed Ice, Cubes, Water	Crushed Ice, Cubes, Water	Crushed Ice, Cubes, Water	Crushed Ice, Cubes, Water	Crushed Ice, Cubes, Water
			●	●	●	●	●
			●	●	●	●	●
			●	●	●	●	●
	3 Glass	3 Glass	3 Glass	3 Glass	3 Glass	3 Glass	3 Glass
	3	3	3	3	3	3	3
	2	2	2	2	2	2	2
	●	●	●	●	●	●	●
	2	2	2	2	●	●	●
	●	●	●	●	●	●	●
	Adj. Temp.	Adj. Temp.	Adj. Temp.	Adj. Temp.	Sealed	Sealed	Sealed
	Adj. Humidity	Adj. Humidity	Adj. Humidity	Adj. Humidity	Adj. Humidity	Adj. Humidity	Adj. Humidity
	CustomCool w/full-extension	CustomCool w/full-extension	Full-extension	Full-extension	●	●	●
	4 (3 Adj.)	4 (3 Adj.)	4 (3 Adj.)	4 (3 Adj.)	4 (3 Adj.)	4 (3 Adj.)	4 (3 Adj.)
	●	●	●	●	●	●	●
	In-the-door	In-the-door	In-the-door	In-the-door			
	Tri-level	Tri-level	Dual-level	Dual-level	Dual-level	Dual-level	Dual-level
	Premium	Premium	Premium	Premium	Deluxe	Deluxe	Deluxe
	●	●	●	●	●	●	●
	●	●	●	●	●	●	●
	4 (3 full-ext.)	4 (3 full-ext.)	Integrated Ice 3	Integrated Ice 3	Integrated Ice 3	Integrated Ice 3	1
	2 (1 slide-out)	2 (1 slide-out)	2 (1 slide-out)	2 (1 slide-out)	2 (1 slide-out)	2 (1 slide-out)	2 (1 slide-out)
	4 (3 Adj.)	4 (3 Adj.)	3 (2 Adj.)	3 (2 Adj.)			
					4 (2 Adj.)	4 (2 Adj.)	3 (2 Adj.)
	Dual	Dual	Dual	Dual	Dual	Dual	Single
	SV	WW, CC, BB	WW, CC, BB	WW, CC, BB	SS	WW, BB	WW, BB
	Trimless	Installed Trim	Trimless	Installed Trim	Trimless	Trimless	Trimless
	Full-length visor	CM Full-length visor	CM Profile	CM Full-length visor	Tubular Stainless steel	CM	CM
	Squared doors	Squared doors	Rounded doors	Squared doors	Rounded doors	Rounded doors	Rounded doors
	Case only (black)	Case only	●	Case only	Case only (black)	●	●
	All	All	All	All	Front	Front	Front
	69-1/4	69-1/4	69-1/4	69-1/4	69-1/4	69-1/4	69-1/4
	68-3/4	68-3/4	68-3/4	68-3/4	68-3/4	68-3/4	68-3/4
	70-1/4	70-1/4		70-1/4			
	23-7/8	23-7/8	23-7/8	23-7/8	23-7/8	23-7/8	23-7/8
	26-3/4	26-3/4	26-3/4	26-3/4	26-3/4	26-3/4	26-3/4
	28-5/16	28-5/16	29-3/16	28-5/16	29-3/16	29-3/16	29-3/16
	45-9/16	45-9/16	45-9/16	45-9/16	45-9/16	45-9/16	45-9/16
	35-3/4	35-3/4	35-3/4	35-3/4	35-3/4	35-3/4	35-3/4
	40	40	41	40	41-3/16	40-3/4	40-3/4
	1/8	1/8	1/8	1/8	1/8	1/8	1/8
	1	1	1	1	1	1	1
	1/2	1/2	1/2	1/2	1/2	1/2	1/2
	334	334	334	334	334	334	334
120V, 60Hz, 15Amps							
	N/A	●	N/A	●	N/A	N/A	N/A
	N/A	PSPK23CBB	N/A	PSPK23DBB	N/A	N/A	N/A
	N/A	PSPK23CWW	N/A	PSPK23DWW	N/A	N/A	N/A
	N/A	PSPK23CCC	N/A	PSPK23DCC	N/A	N/A	N/A
	N/A	PSPK23CSS	N/A	PSPK23DSS	N/A	N/A	N/A
	N/A	TRMBISBB	N/A	TRMBISBB	N/A	N/A	N/A
	N/A	TRMBISWW	N/A	TRMBISWW	N/A	N/A	N/A
	N/A	TRMBISCC	N/A	TRMBISCC	N/A	N/A	N/A
	TRMBISSS	N/A	N/A	N/A	N/A	N/A	N/A

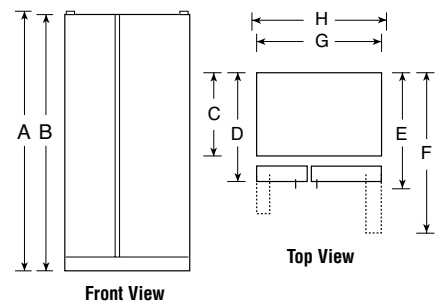

Listed by
Underwriters
Laboratories

Answers that click!

GE puts everything you need at your fingertips.



GE Appliances web site — 16 million visitors a year!
Visit us at GEAppliances.com

Everything you need to know about GE products is here. Access up-to-date information, find out “what’s new,” obtain dimensions, get installation tips and more. Extremely user-friendly, this one-stop site lets you research by brand, category or model number and even buy online through a local GE dealer.

GE Answer Center® saves you time.
800.626.2000

This 24-hour-a-day, 7-day-a-week service provides answers on product features, installation, service and more.



A Century of Quality and Innovation

For more than a century, GE has been committed to producing innovative products that change the way people live. The result of thorough research and rigorous testing, GE appliances are designed for years of dependable performance. Today, the GE tradition of quality and innovation continues.

Before purchasing an ENERGY STAR®-qualified appliance, read important information about its estimated annual energy consumption or energy efficiency rating that is available from your retailer or at GEAppliances.com.