

# MONOGRAM 36" BUILT-IN BOTTOM-FREEZER REFRIGERATOR    ZIC360NHRH

---

## SECTION 1

### FLUSH INSET INSTALLATION



---

## SECTION 2

### STANDARD INSTALLATION

#### 1/4" FRAMED PANELS



#### 3/4" OVERLAY PANELS



ELEVATE EVERYTHING™

**MONOGRAM**

# MONOGRAM 36" BUILT-IN BOTTOM-FREEZER REFRIGERATOR ZIC360NHRH



## SPECIFICATIONS

Overall Width	38" (96.5 cm) <sup>†</sup>
Overall Height	84 1/2" (214.6 cm) <sup>†</sup>
Overall Depth	26" (66.0 cm) <sup>†</sup>
Door Clearance	38 3/4" (98.4 cm)
Cutout Width	39" (99.1 cm)
Cutout Height	85" (215.9 cm)
Cutout Depth	26 3/16" (66.5 cm)
Plumbing Requirements	1/4" OD copper tubing or GE SmartConnect kit
Shipping Weight	640 lb (290.3 kg)

<sup>†</sup> Dimensions include 3/4" custom cabinet panel

## ATTENTION ELECTRICIAN:

A 115 volt 60Hz., 15 or 20 amp power supply is required. An individual properly grounded branch circuit or circuit breaker is recommended. Install a properly grounded 3-prong electrical receptacle recessed into the back wall.

## OVERALL DIMENSIONS AFTER PANEL INSTALL

## FLUSH INSET INSTALLATION

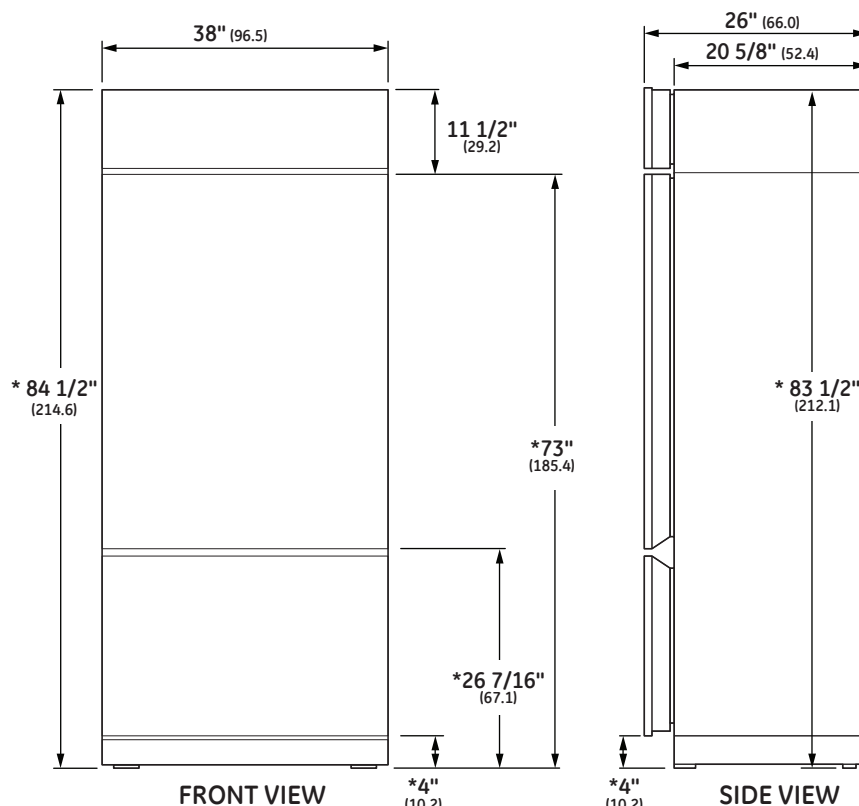

\* Shipping height. Use leveling legs and wheels for maximum 1" height adjustment from shipping height. Nominal installation height is 84"

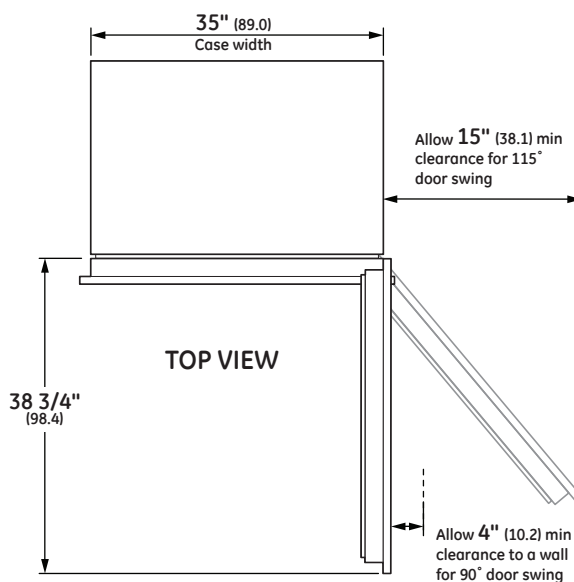

Dimensions in parentheses are in centimeters unless otherwise noted. Actual product dimensions may vary due to manufacturing tolerances.

ELEVATE EVERYTHING™

**MONOGRAM**

Product Specification Revised 1/18

# MONOGRAM 36" BUILT-IN BOTTOM-FREEZER REFRIGERATOR ZIC360NHRH

## FLUSH INSET INSTALLATION 3/4" PANELS

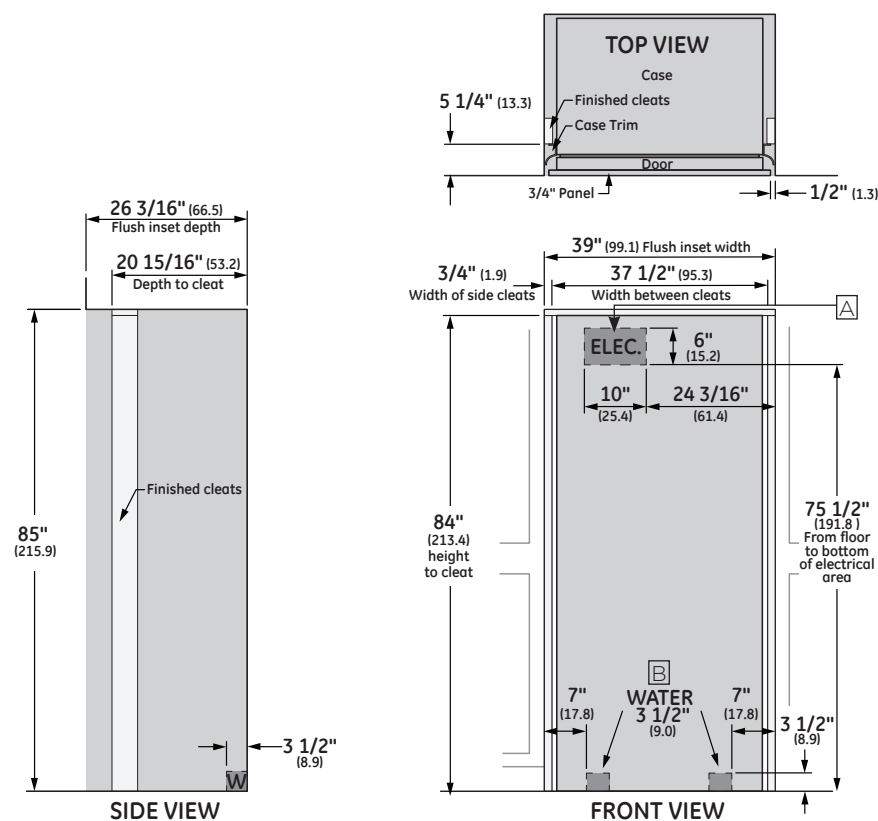

## FLUSH INSET INSTALLATION

### NOTES

- Ⓐ Mounting the junction box in this location will also allow for front accessibility through access panel.
- Ⓑ Water supply area.

### ⚠ WARNING:

The refrigerator is top heavy and must be secured to prevent the possibility of tipping forward. Failure to do so may result in death or serious injury.

The information below is for cabinet design only. When installing the anti-tip system you must use the product installation instructions.

The information below applies to all installation constructions:

- A wall bracket, bolts and toggles will be supplied with the unit.
- The bolts will be used to attach bracket to wall in 4 locations. Two of the locations must penetrate the center of the wall studs.
- The toggles are used for stability in drywall and when metal studs are encountered. Lag bolts are used in wood studs.
- In installation opening, measure 82" from floor and draw a horizontal line.
- Locate and mark the wall studs on horizontal line. Verify at least two studs have their centerlines within the center 32-1/2" of installation opening to ensure 2 wall studs are penetrated.
- The bracket will be centered left to right in opening with bottom of bracket on the horizontal line.
- When unit is placed in opening, the bracket tabs will align with openings in back of the unit. The unit will be secured to the bracket using supplied "L" bolts.

See Installation Instructions for detailed instructions.

## ANTI-TIP BRACKET

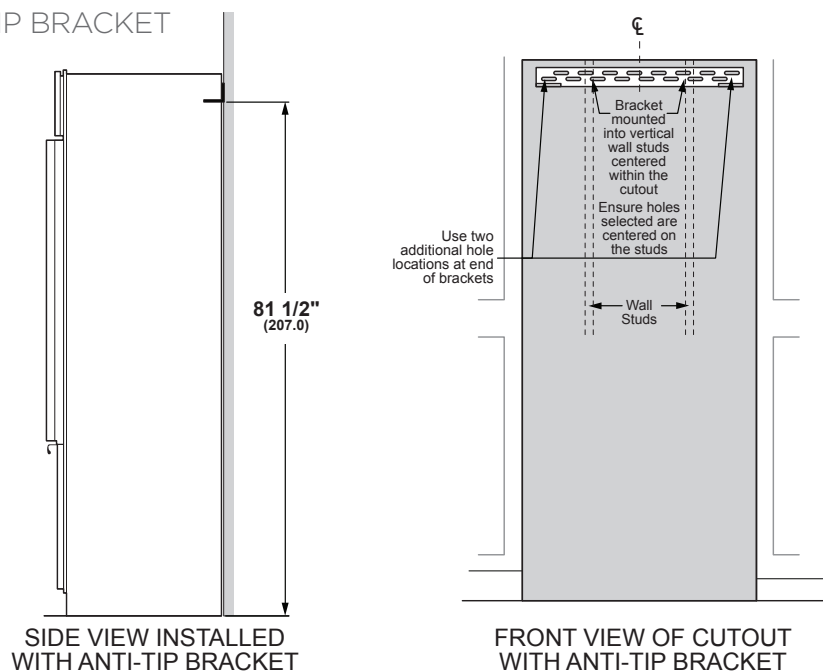

ELEVATE EVERYTHING™

MONOGRAM

FLUSH INSET 3/4" PANEL DIMENSIONS SINGLE INSTALLATION

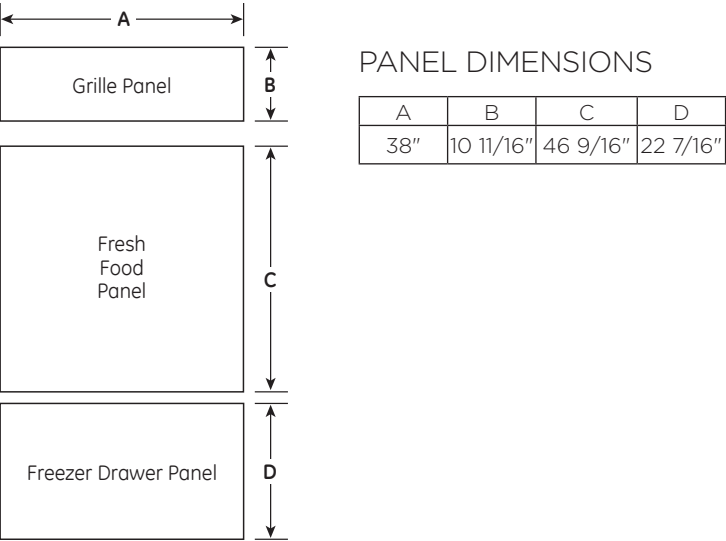

3/4" RAISED DOOR PANEL ROUTING

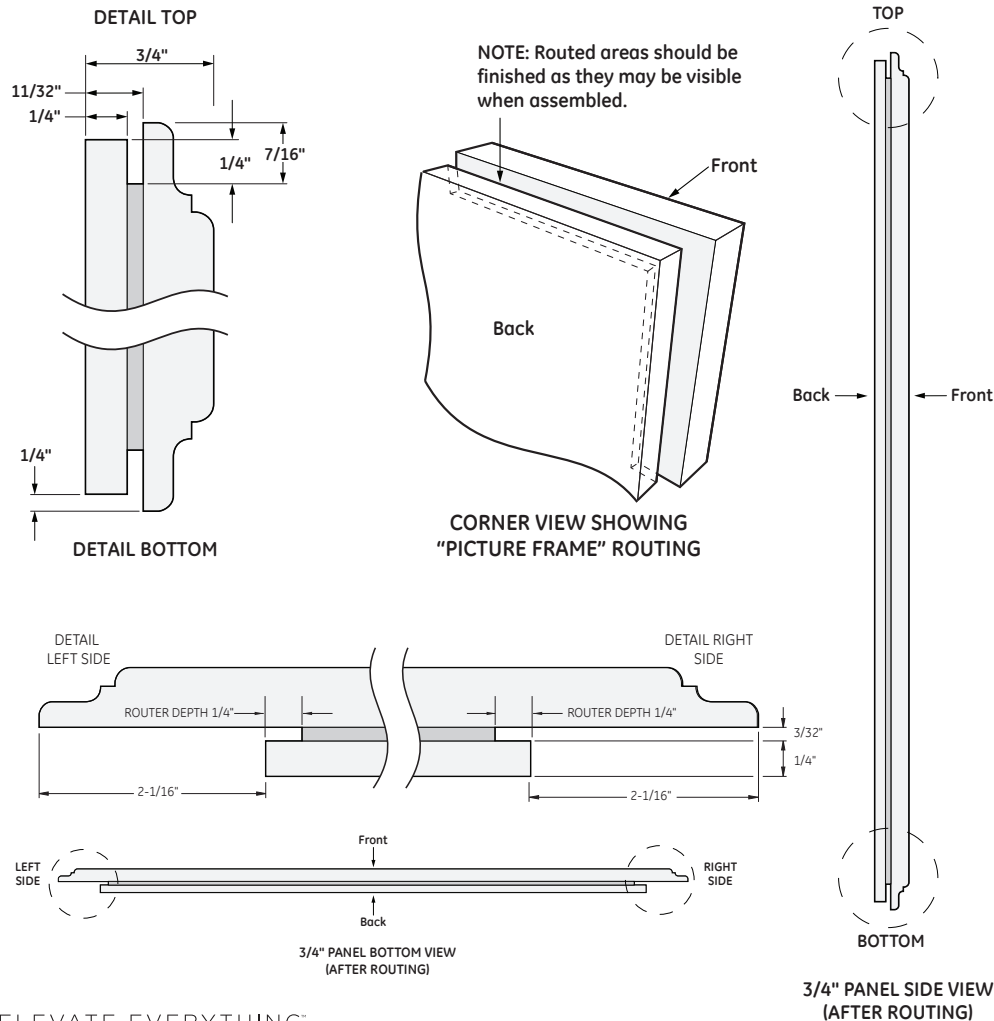

FLUSH INSET INSTALLATION

NOTES

Trimmed refrigerators are designed to be customized with decorative panels. Field-installed 1/2" or 3/4" custom door, drawer and grille panels are required. For 3/4" raised panels, routing is required. The router depth is 1/4" all the way around the panel's backs. Additional panel width reductions are required per the diagrams shown. This will create "picture frame" routing allowing the panels to slide into the attached door, drawer and grille trims.

Maximum total panel weight:

- Fresh food door panels - 58 lbs.
- Freezer drawer panel - 28 lbs.
- Grille panel - 11 lbs

Note: For panels constructed with rails and stiles (5-panel), the rails must be a minimum of 3" wide and stiles must be a minimum of 4" wide.

Door Handles  
Door handles not included. Custom handles supplied by your cabinet maker may be used.

ZKHPSS1: Professional tubular stainless steel handle designed to fit custom panels. Kit includes one handle - 30-1/2" long. Order 2 kits from your Monogram supplier.

ZKHCS2: Custom European tubular handle designed to fit custom panels. Kit includes 2 handles. Door handle is 44-3/16" and drawer handle is 33-3/16".

Order ZUG2: Unified grille kit for dual installation. Maximum total panel weight - 25 lbs.

ZKHCT: Handle side trim for left-hand and right-hand door. For use on a custom panel when using a custom handle.

### 3/4" RAISED GRILL PANEL ROUTING

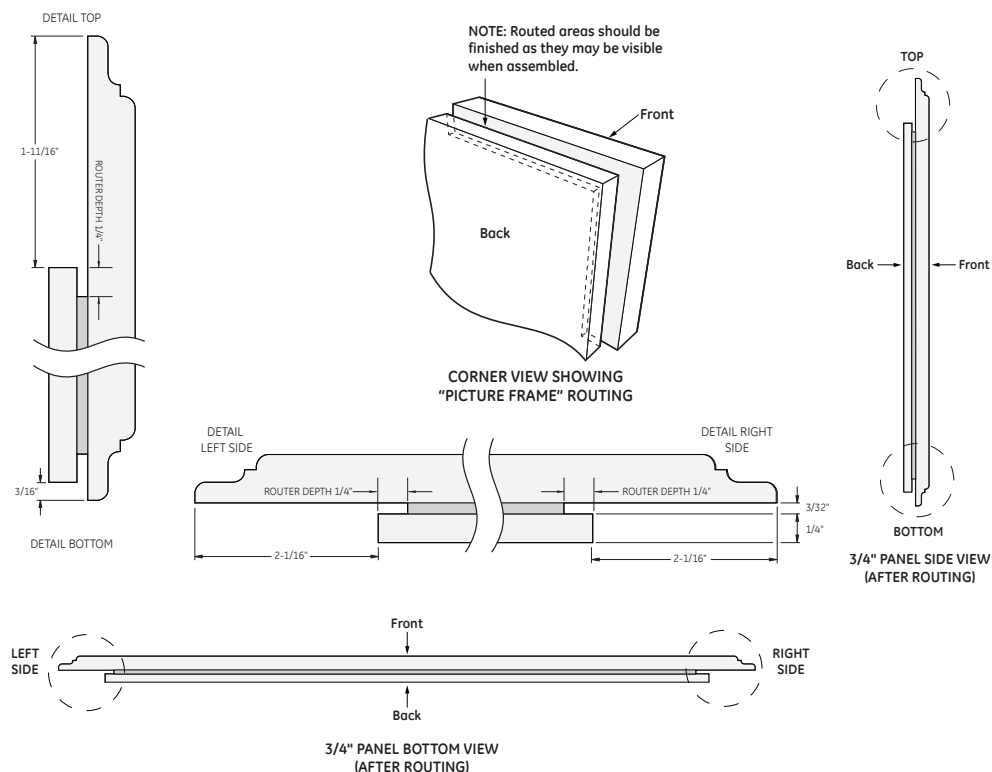

### FLUSH INSET INSTALLATION

#### NOTES

Trimmed refrigerators are designed to be customized with decorative panels. Field-installed 1/2" or 3/4" custom door, drawer and grille panels are required. For 3/4" raised panels, routing is required. The router depth is 1/4" all the way around the panel's backs. Additional panel width reductions are required per the diagrams shown. This will create "picture frame" routing allowing the panels to slide into the attached door, drawer and grille trims.

Maximum total panel weight:

- Fresh food door panels - 58 lbs.
- Freezer drawer panel - 28 lbs.
- Grille panel - 11 lbs

Note: For panels constructed with rails and stiles (5-panel), the rails must be a minimum of 3" wide and stiles must be a minimum of 4" wide.

#### Door Handles

Door handles not included. Custom handles supplied by your cabinet maker may be used.

ZKHPSS1: Professional tubular stainless steel handle designed to fit custom panels. Kit includes one handle - 30-1/2" long. Order 2 kits from your Monogram supplier.

ZKHCS2: Custom European tubular handle designed to fit custom panels. Kit includes 2 handles. Door handle is 44-3/16" and drawer handle is 33-3/16".

Order ZUG2: Unified grille kit for dual installation. Maximum total panel weight - 25 lbs.

ZKHCT: Handle side trim for left-hand and right-hand door. For use on a custom panel when using a custom handle.

### 3/4" RAISED DRAWER PANEL ROUTING

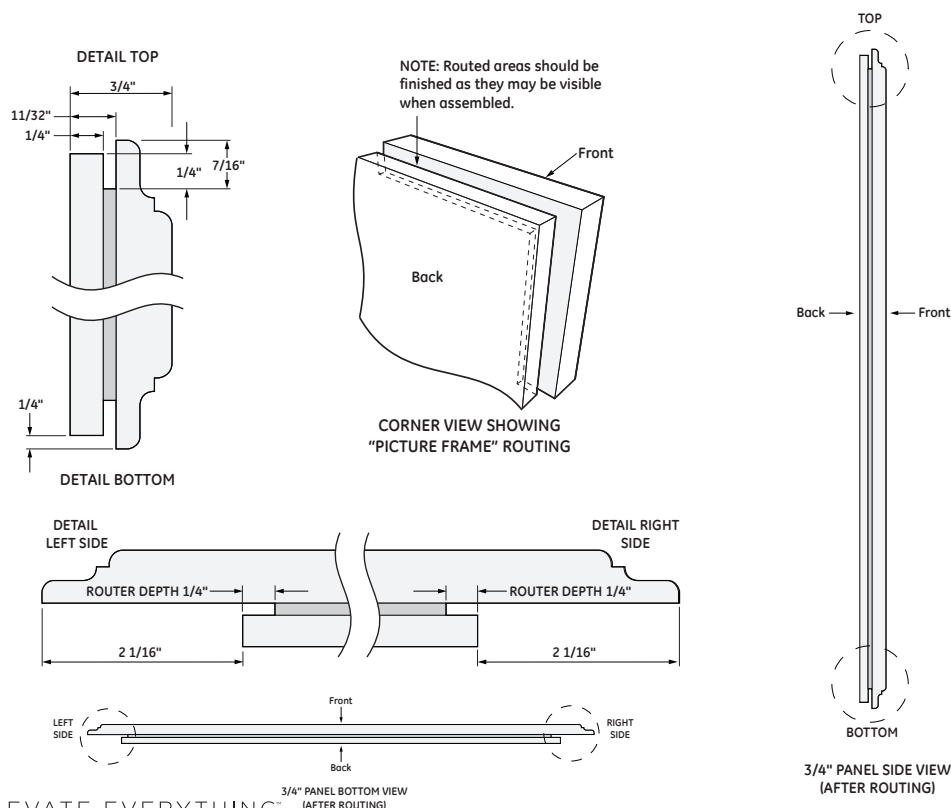

ELEVATE EVERYTHING

MONOGRAM

# MONOGRAM 36" BUILT-IN BOTTOM-FREEZER REFRIGERATOR ZIC360NHRH

## FLUSH INSET INSTALLATION 1/2" PANELS

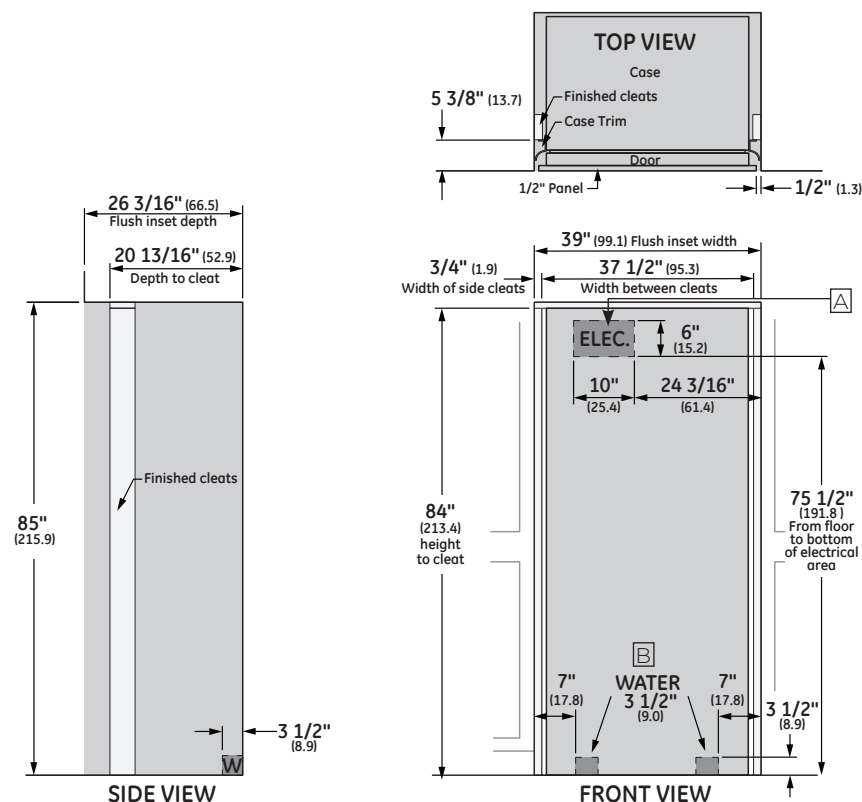

## FLUSH INSET INSTALLATION

### NOTES

Ⓐ Mounting the junction box in this location will also allow for front accessibility through access panel.

Ⓑ Water supply area.

### ⚠ WARNING:

The refrigerator is top heavy and must be secured to prevent the possibility of tipping forward. Failure to do so may result in death or serious injury.

The information below is for cabinet design only. When installing the anti-tip system you must use the product installation instructions.

The information below applies to all installation constructions:

- A wall bracket, bolts and toggles will be supplied with the unit.
- The bolts will be used to attach bracket to wall in 4 locations. Two of the locations must penetrate the center of the wall studs.
- The toggles are used for stability in drywall and when metal studs are encountered. Lag bolts are used in wood studs.
- In installation opening, measure 82" from floor and draw a horizontal line.
- Locate and mark the wall studs on horizontal line. Verify at least two studs have their centerlines within the center 32-1/2" of installation opening to ensure 2 wall studs are penetrated.
- The bracket will be centered left to right in opening with bottom of bracket on the horizontal line.
- When unit is placed in opening, the bracket tabs will align with openings in back of the unit. The unit will be secured to the bracket using supplied "L" bolts.

See Installation Instructions for detailed instructions.

## ANTI-TIP BRACKET

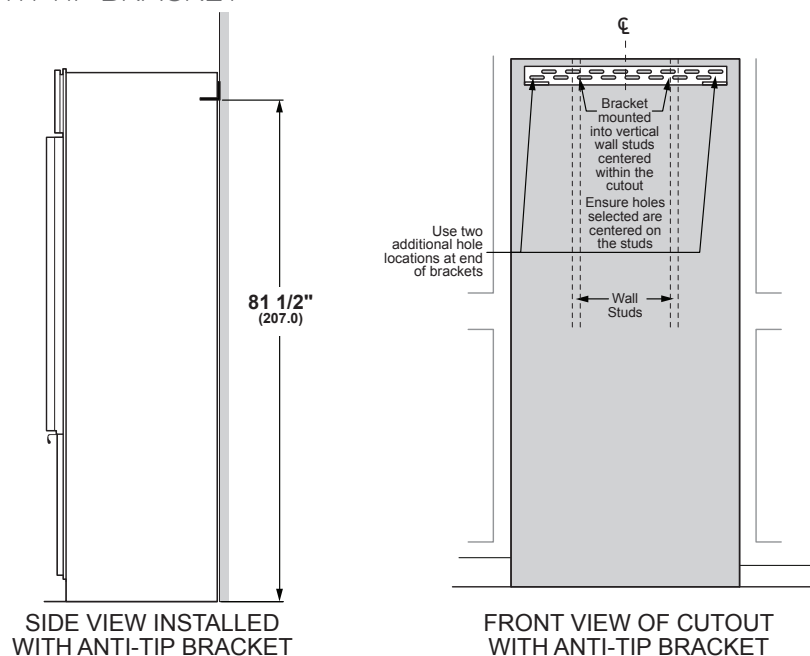

ELEVATE EVERYTHING™

MONOGRAM

FLUSH INSET 1/2" PANEL DIMENSIONS

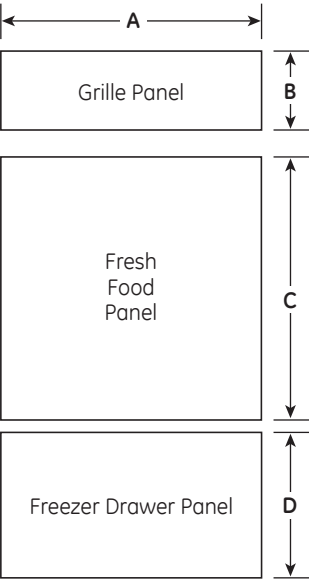

PANEL DIMENSIONS

	A	B	C	D
1/4" Backer Panel	33 7/8"	8 7/8"	46 1/16"	21 7/8"
.10" Space Panel	32 1/2"	7 5/8"	44 11/16"	20 1/2"
1/2" Overlay Panel	38"	10 11/16"	46 9/16"	22 7/16"

FLUSH INSET  
INSTALLATION

NOTES

- The 1/2" overlay panel must be secured to a .10" spacer panel and a 1/4" thick backer panel, which slides into the trim.
- Assemble the panels with glue and screws:
- Center the spacer panel on the backer panel, left to right and top to bottom. Secure the panels with glue.
  - Refer to the chart for locating the backer panel to the overlay panel. Secure the overlay panel to the backer panel with glue and screws. Screws must be countersunk into the backer panel

Order ZUG2: Unified grille kit for dual installation. Maximum total panel weight - 25 lbs.

Note: For panels constructed with rails and stiles (5-panel), the rails must be a minimum of 3" wide and stiles must be a minimum of 4" wide.

1/2" OVERLAY PANEL ROUTING DIMENSIONS

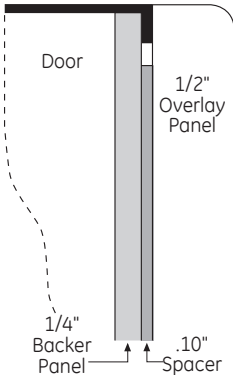
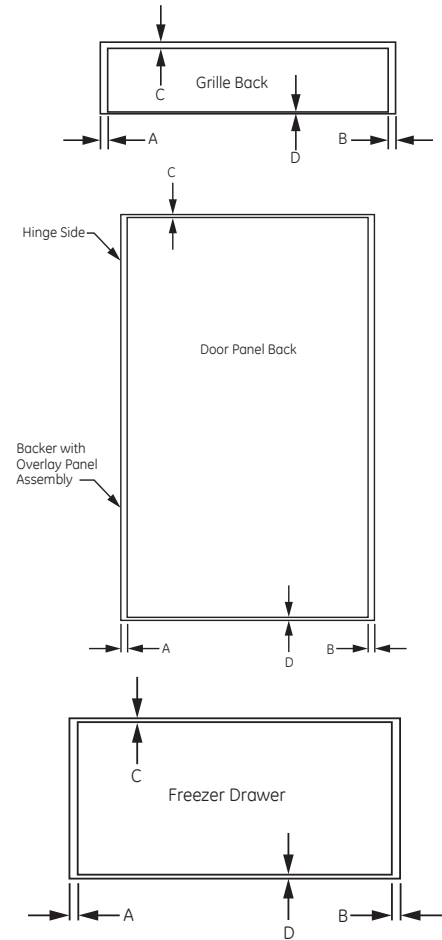

PANEL DIMENSIONS

	A	B	C	D
Fresh Food Panel	2 1/16"	2 1/16"	5/16"	3/16"
Freezer Panel	2 1/16"	2 1/16"	5/16"	3/16"
Grille Panel	2 1/16"	2 1/16"	1 11/16"	3/16"

ELEVATE EVERYTHING™





MONOGRAM 36" BUILT-IN BOTTOM-FREEZER REFRIGERATOR

ZIC360NHRH

3/4" OR 1/2" DUAL INSTALLATIONS

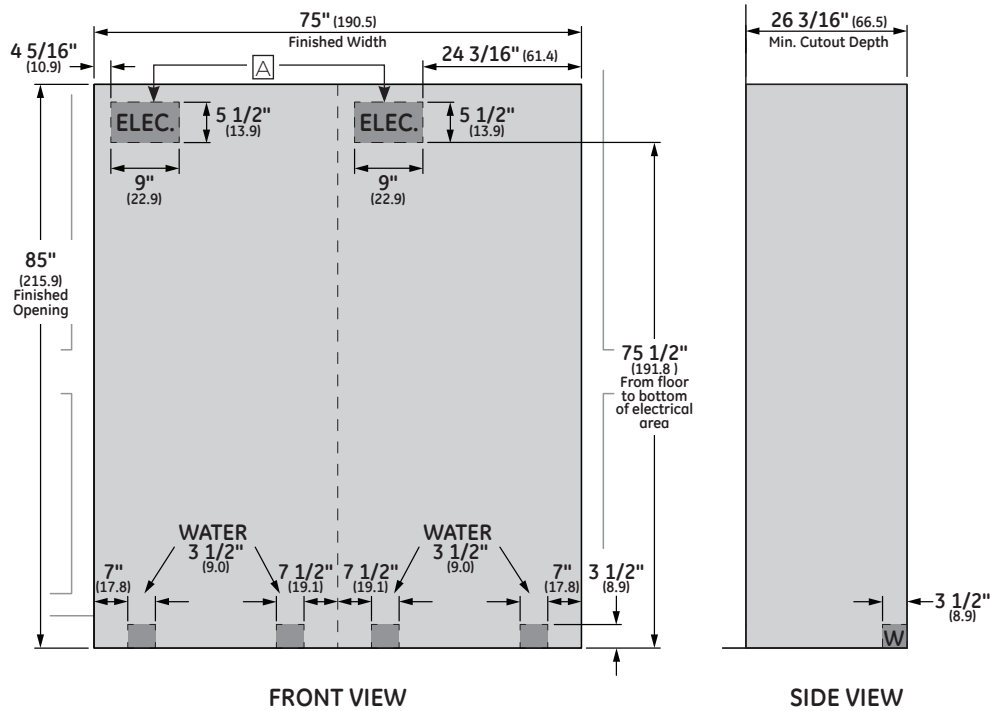

FLUSH INSET 1/2" PANEL DIMENSIONS DUAL INSTALLATION

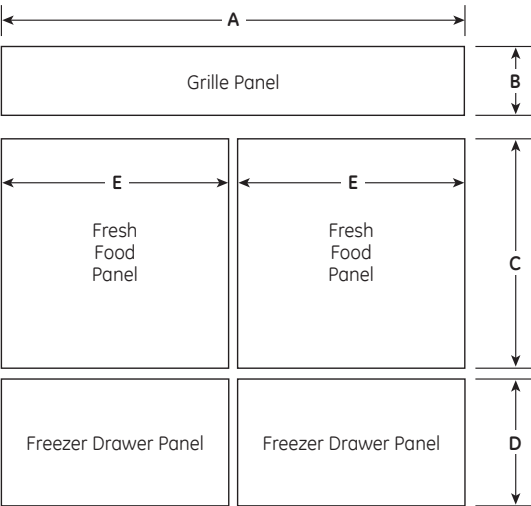

PANEL DIMENSIONS

	A	B	C	D	E
1/4" Backer Panel	69 7/8"	8 7/8"	46 1/16"	21 7/8"	33 7/8"
.10" Space Panel	68 1/2"	7 5/8"	44 11/16"	20 1/2"	32 1/2"
1/2" Overlay Panel	74 1/2"	10 11/16"	46 9/16"	22 7/16"	36 7/8"

ELEVATE EVERYTHING™



FLUSH INSET  
INSTALLATION

NOTES

Trimmed refrigerators are designed to be customized with decorative panels. Field-installed 1/2" or 3/4" custom door, drawer and grille panels are required. For 3/4" raised panels, routing is required. The router depth is 1/4" all the way around the panel's backs. Additional panel width reductions are required per the diagrams shown. This will create "picture frame" routing allowing the panels to slide into the attached door, drawer and grille trims.

- A separate 115V, 60Hz, 15- or 20-amp power supply is recommended for each product.

Maximum total panel weight:

- Fresh food door panels – 58 lbs.
- Freezer drawer panel – 28 lbs.
- Unified grille panel – 25 lbs

**Door Handles**  
Door handles not included. Custom handles supplied by your cabinet maker may be used.

**ZKHPSS1:** Professional tubular stainless steel handle designed to fit custom panels. Kit includes one handle – 30-1/2" long. Order 2 kits from your Monogram supplier.

**ZKHCS2:** Custom European tubular handle designed to fit custom panels. Kit includes 2 handles. Door handle is 44-3/16" and drawer handle is 33-3/16".

Order **ZUG2:** Unified grille kit for dual installation. Maximum total panel weight – 25 lbs.

**ZKHCT:** Handle side trim for left-hand and right-hand door. For use on a custom panel when using a custom handle.

The 1/2" overlay panel must be secured to a .10" spacer panel and a 1/4" thick backer panel, which slides into the trim.

Assemble the panels with glue and screws:

- Center the spacer panel on the backer panel, left to right and top to bottom. Secure the panels with glue.
- Refer to the chart for locating the backer panel to the overlay panel. Secure the overlay panel to the backer panel with glue and screws. Screws must be countersunk into the backer panel



FLUSH INSET 3/4" PANEL DIMENSIONS DUAL INSTALLATION

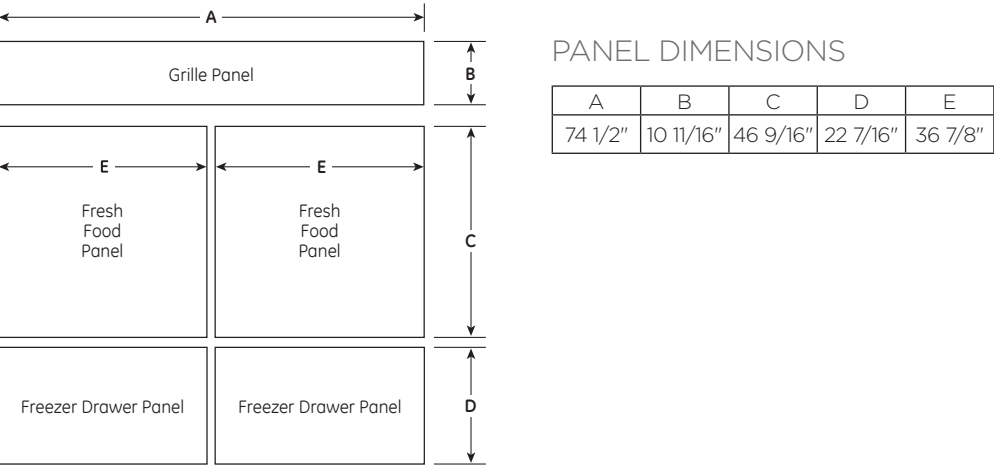

3/4" RAISED DOOR AND DRAWER PANEL ROUTING -  
(SEE PAGE 5 FOR 3/4" GRILLE PANEL ROUTING DIAGRAMS)

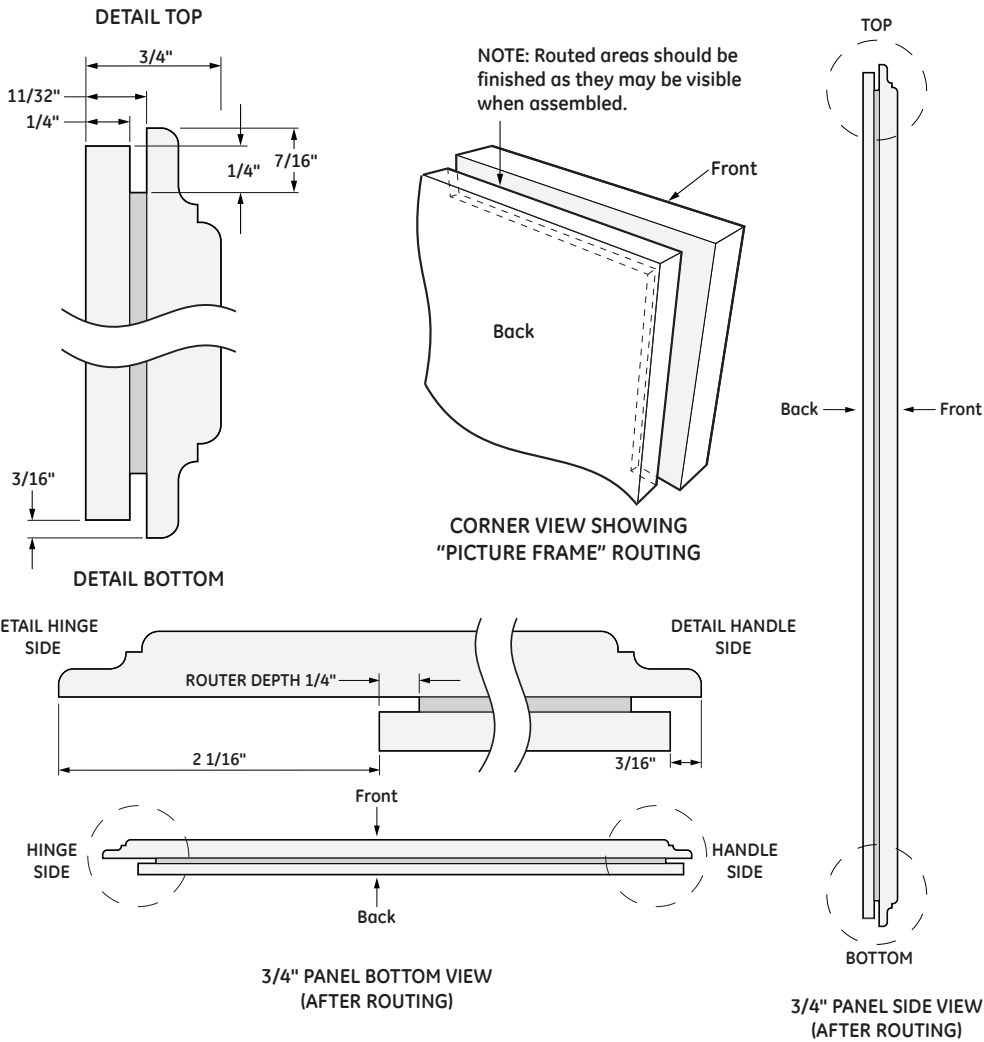

FLUSH INSET  
INSTALLATION

NOTES

Trimmed refrigerators are designed to be customized with decorative panels. Field-installed 1/2" or 3/4" custom door, drawer and grille panels are required. For 3/4" raised panels, routing is required. The router depth is 1/4" all the way around the panel's backs. Additional panel width reductions are required per the diagrams shown. This will create "picture frame" routing allowing the panels to slide into the attached door, drawer and grille trims.

- Maximum total panel weight:
- Fresh food door panels - 58 lbs.
  - Freezer drawer panel - 28 lbs.
  - Unified grille panel - 25 lbs

Door Handles  
Door handles not included. Custom handles supplied by your cabinet maker may be used.

ZKHPSS1: Professional tubular stainless steel handle designed to fit custom panels. Kit includes one handle - 30-1/2" long. Order 2 kits from your Monogram supplier.

ZKHCSS2: Custom European tubular handle designed to fit custom panels. Kit includes 2 handles. Door handle is 44-3/16" and drawer handle is 33-3/16".

Order ZUG2: Unified grille kit for dual installation. Maximum total panel weight - 25 lbs.

ZKHCT: Handle side trim for left-hand and right-hand door. For use on a custom panel when using a custom handle.

ELEVATE EVERYTHING™



3/4" OR 1/2" DUAL PRODUCT CLEARANCES

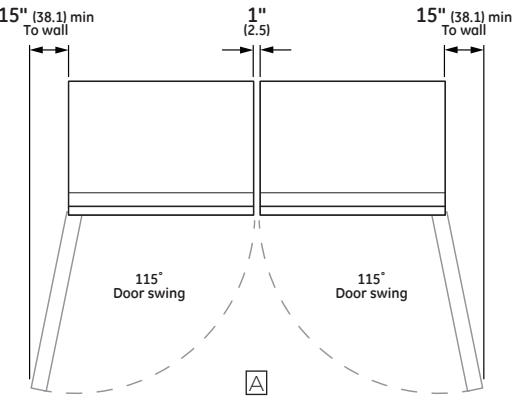

FLUSH INSET  
INSTALLATION

NOTES

- A** In a side-by-side installation of a left-and-right-hand door swing product, 1" clearance between the units is required. Order ZUG2 custom panel unified grille kit for this installation.

ELEVATE EVERYTHING™



# MONOGRAM 36" BUILT-IN BOTTOM-FREEZER REFRIGERATOR ZIC360NHRH

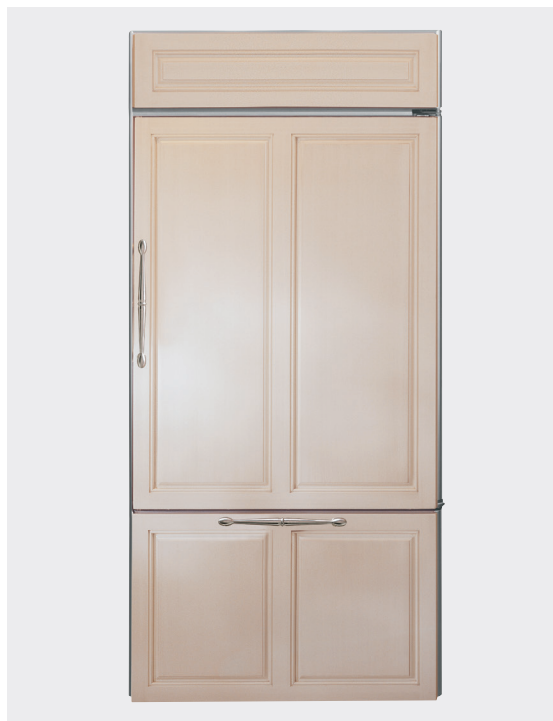

## SPECIFICATIONS

Overall Width	36" (91.4 cm)
Overall Height	84" (213.4 cm)
Overall Depth	25 3/8" (64.5 cm)
Door Clearance	36 3/4" (93.4 cm)
Cutout Width	35 1/2" (90.2 cm)
Cutout Height	83 1/2" - 84 1/2" (212.1 - 214.6 cm)
Cutout Depth	24" (61 cm)
Plumbing Requirements	1/4" OD copper tubing or GE SmartConnect kit
Shipping Weight	640 lb (290.3 kg)

### ATTENTION ELECTRICIAN:

A 115 volt 60Hz., 15 or 20 amp power supply is required. An individual properly grounded branch circuit or circuit breaker is recommended. Install a properly grounded 3-prong electrical receptacle recessed into the back wall.

## OVERALL DIMENSIONS AFTER PANEL INSTALL

## STANDARD INSTALLATION

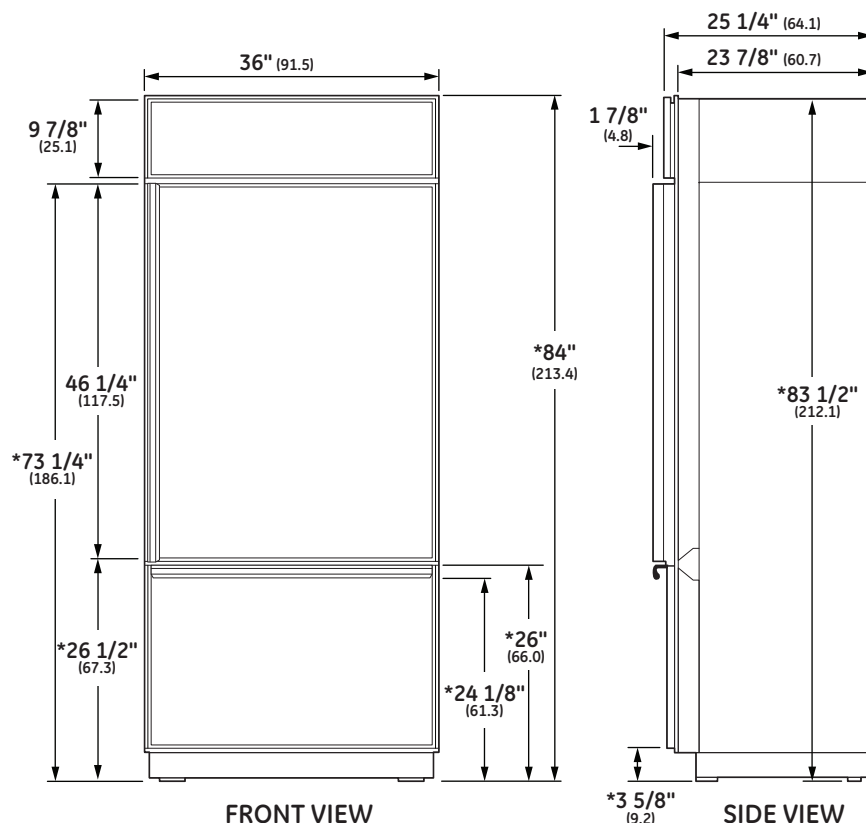

\* Shipping height. Use leveling legs and wheels for maximum 1" height adjustment from shipping height.

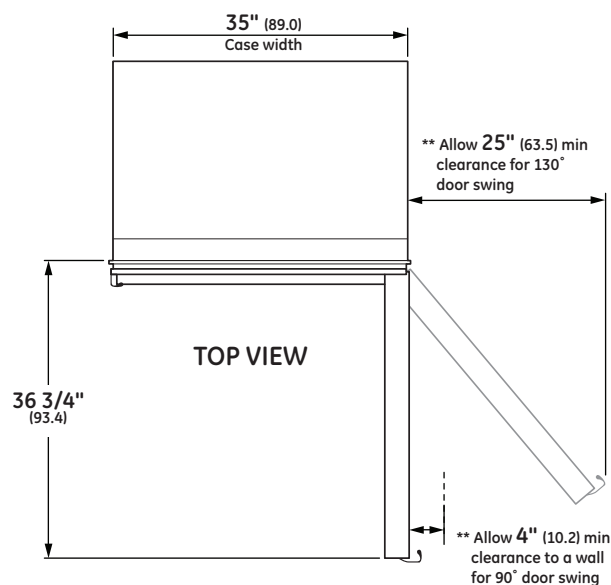

\*\*These refrigerators are equipped with a 3-position door stop. The factory-set 130° door swing can be adjusted to 90° or 130° for standard installation if clearances to adjacent cabinets or walls is restricted. Allow a 15" minimum clearance to wall for pan removal. If the 90° door stop position is used, pan access is maintained, but pan removal is restricted.

Dimensions in parentheses are in centimeters unless otherwise noted. Actual product dimension may vary due to manufacturing tolerances.

ELEVATE EVERYTHING™

**MONOGRAM**

Product Specification Revised 1/18



STANDARD 1/4" FRAMED PANEL DIMENSIONS SINGLE INSTALLATION

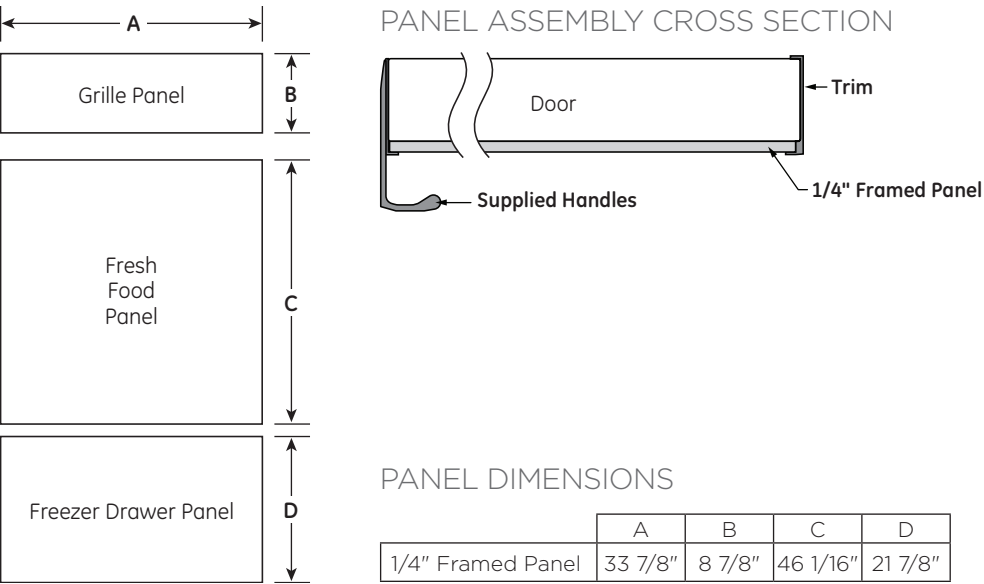

STANDARD  
INSTALLATION

NOTES

Trimmed refrigerators are designed to be customized with decorative panels. Field-installed custom door and grille panels are required.

1/4" Framed Panels:

For 1/4" thick custom panels ordered from your cabinet maker. The decorative panels slide into the trim.

Maximum total panel weight:

- Fresh food door panel – 58 lbs.
- Freezer drawer panel – 28 lbs.
- Grille panel – 11 lbs.

3/4" Overlay Panels:

The decorative panels slide into the trim. The overlay panel must be secured to a 1/4"-thick backer panel which slides into the trim. A spacer panel 0.10" thick must be placed between the overlay and backer panels. Center each panel over the other. Assemble the panels with glue and screws. Screws must be countersunk into the backer panel.

NOTE: Left-to-right offset is not always equal to top-to-bottom offset.

Maximum total panel weight:

- Fresh food door panel – 58 lbs.
- Freezer drawer panel – 28 lbs.
- Grille panel – 11 lbs.

Door Handles:

The supplied handles can be adjusted to accommodate both framed or overlay panels. Custom handles of your choice, supplied by your cabinet maker, can also be installed.

ZKHPSS1: Professional tubular stainless steel handle designed to fit 3/4" overlay panels.

ZKHCS2: European tubular handle designed to fit 3/4" panels. Kit includes 2 handles.

Door handle is 44-3/16" and drawer handle is 33-3/16".

STANDARD 3/4" OVERLAY PANEL DIMENSIONS SINGLE  
INSTALLATION

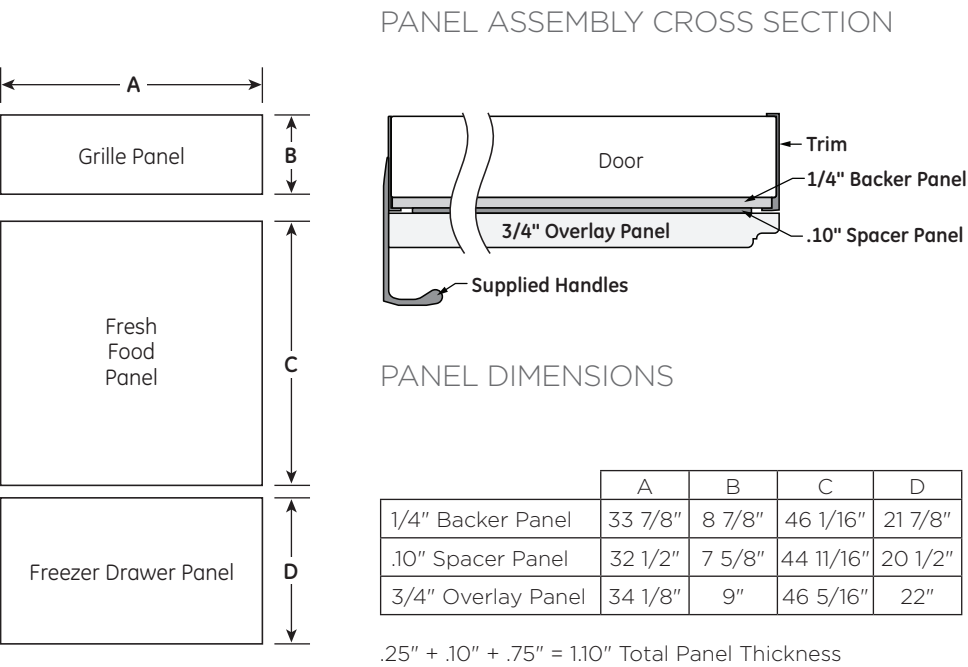

CUSTOM SIDE PANELS

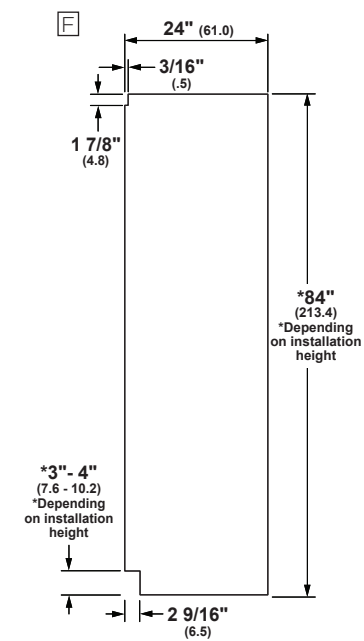

STANDARD  
INSTALLATION

NOTES

- Side panels must be used whenever the sides of the refrigerator will be exposed. The 1/4" side panels will slip into the side case trim. Secure the panels to the refrigerator with stick-on hook and loop fastener strips. Order the side panels from the cabinet manufacturer.

ELEVATE EVERYTHING™



MONOGRAM 36" BUILT-IN BOTTOM-FREEZER REFRIGERATOR    ZIC360NHRH

DUAL INSTALLATIONS

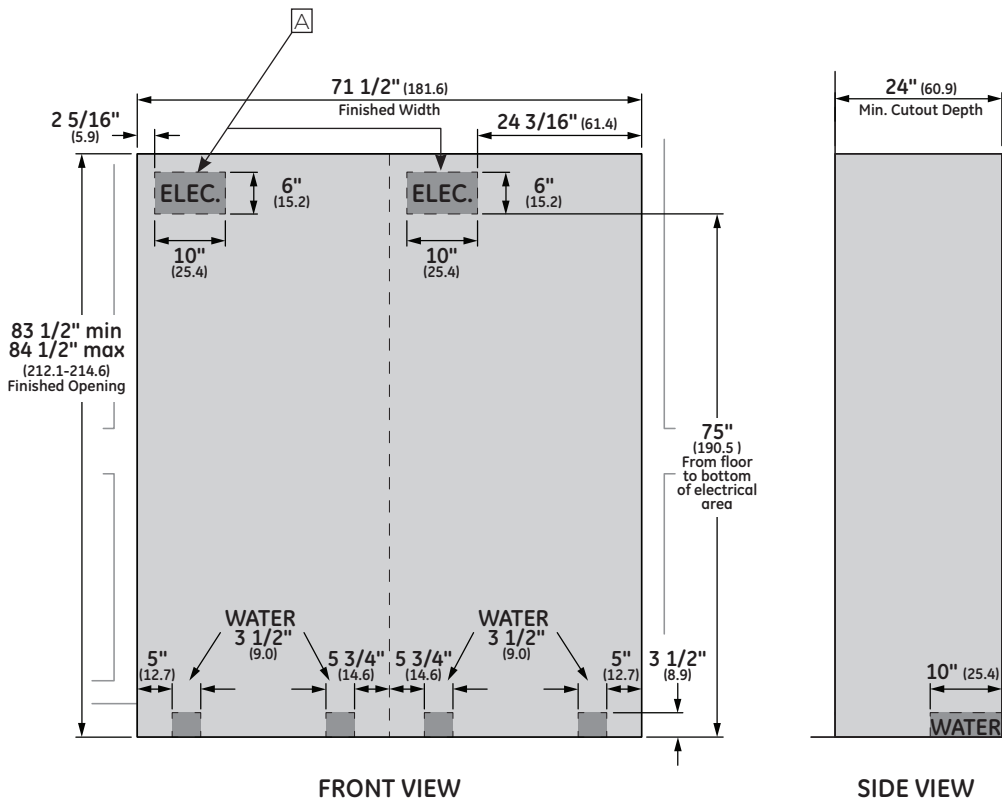

STANDARD  
INSTALLATION

NOTES

- A A separate 115V, 60Hz, 15- or 20-amp power supply is recommended for each product.
- Additional cutout width may be required when side panels are used.

STANDARD 1/4" FRAMED PANEL DIMENSIONS  
DUAL INSTALLATION

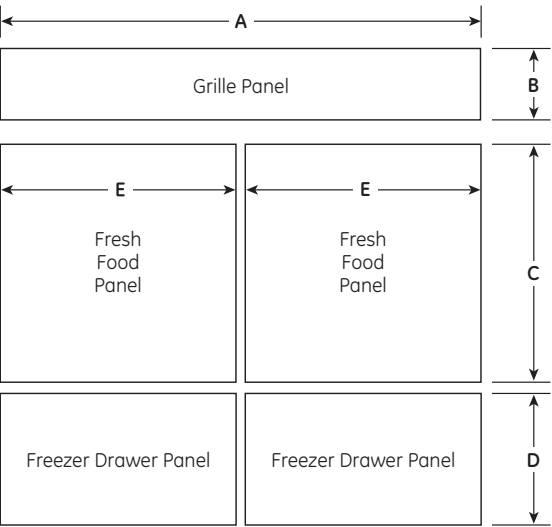

PANEL DIMENSIONS

	1/4" Framed Panel
A	69 7/8"
B	8 7/8"
C	46 1/16"
D	21 7/8"
E	33 7/8"

Trimmed refrigerators are designed to be customized with decorative panels. Field-installed custom door and grille panels are required.

1/4" Framed Panels:

For 1/4" thick custom panels ordered from your cabinet maker. The decorative panels slide into the trim.

- Maximum total panel weight:
- Fresh food door panel – 58 lbs.
  - Freezer drawer panel – 28 lbs.
  - Grille panel – 25 lbs.

Order ZUG2: Unified grille kit for dual installation

PANEL ASSEMBLY  
CROSS SECTION

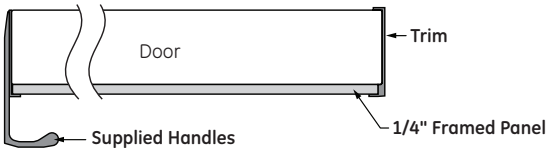

ELEVATE EVERYTHING™

MONOGRAM



STANDARD 3/4" OVERLAY PANEL DIMENSIONS  
DUAL INSTALLATION

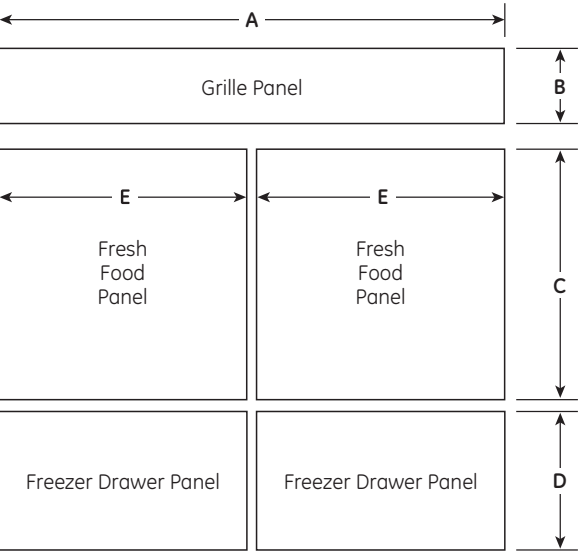

PANEL DIMENSIONS

	1/4" Backer Panel	.10" Spacer Panel	3/4" Overlay Panel
A	69 7/8"	68 1/2"	70 1/8"
B	8 7/8"	7 5/8"	9"
C	46 1/16"	44 11/16"	46 5/16"
D	21 7/8"	20 1/2"	22"
E	33 7/8"	32 1/2"	34 1/8"

.25" + .10" + .75" = 1.10" Total Panel Thickness

PANEL ASSEMBLY CROSS SECTION

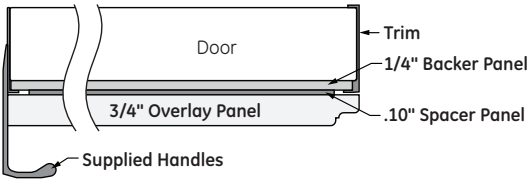

DUAL PRODUCT CLEARANCES

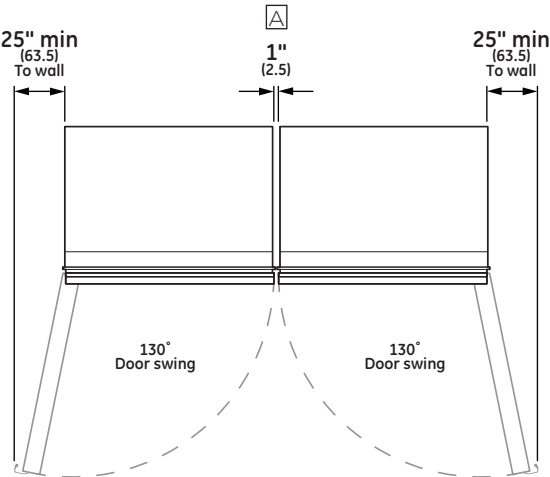

ELEVATE EVERYTHING™



STANDARD  
INSTALLATION

NOTES

3/4" Overlay Panels:

The decorative panels slide into the trim. The overlay panel must be secured to a 1/4"-thick backer panel which slides into the trim. A spacer panel 0.10" thick must be placed between the overlay and backer panels.  
Center each panel over the other.  
Assemble the panels with glue and screws. Screws must be countersunk into the backer panel.

NOTE: Left-to-right offset is not always equal to top-to-bottom offset.

- Maximum total panel weight:
- Fresh food door panel – 58 lbs.
  - Freezer drawer panel – 28 lbs.
  - Grille panel – 25 lbs.

Order ZUG2: Unified grille kit for dual installation

Door Handles:  
The supplied handles can be adjusted to accommodate both framed or overlay panels. Custom handles of your choice, supplied by your cabinet maker, can also be installed.

ZKHPSS1: Professional tubular stainless steel handle designed to fit 3/4" overlay panels.

ZKHCSS2: European tubular handle designed to fit 3/4" panels. Kit includes 2 handles.

Door handle is 44-3/16" and drawer handle is 33-3/16".

**A** In a side-by-side installation of a left-and-right-hand door swing product, 1" clearance between the units is required.

Order ZUG2: custom panel unified grille kit for one continuous grille panel.

# MONOGRAM 36" BUILT-IN BOTTOM-FREEZER REFRIGERATOR ZIC360NHRH

## FEATURES AND BENEFITS

### CUSTOM APPEARANCE

Allows personalization with cabinet-compatible panels and custom handles

### UPFRONT ELECTRONIC CONTROLS WITH DIGITAL READOUT

Allows precise temperature settings and are positioned for maximum ease of use

### HUMIDITY CONTROLLED VEGETABLE COMPARTMENTS AND SEALED SNACK PANS

Help maintain freshness and help preserve foods longer

### ADJUSTABLE, SPILL PROOF GLASS SHELVES

Make it easy to customize storage to handle foods and containers of various sizes

### 2 SEALED DELI PANS WITH FULL-EXTENSION SLIDES

### SIX ADJUSTABLE DOOR BINS

Offer added storage flexibility

### GE WATER™ FILTRATION SYSTEM

Delivers clean, great tasting ice



ELEVATE EVERYTHING®

**MONOGRAM**

Product Specification Revised 1/18