

# GTH18JBP

## GE® ENERGY STAR® 18.0 Cu. Ft. Top Freezer Refrigerator with Icemaker

### Dimensions and Installation Information (in inches)

Overall Dimensions	Height to top of hinge (in.) <b>A</b>	66-5/8
	Height to top of case (in.) <b>B</b>	66-1/8*
	Case depth without door (in.) <b>C</b>	27-1/2
	Case depth less door handle (in.) <b>D</b>	30-1/4
	Case depth with door handle (in.) <b>E</b>	32-1/8
	Depth with fresh food door open 90° (in.) <b>F</b>	58-1/8
	Width (in.) <b>G</b>	29-1/2
	Width with door open 90° less door handle (in.) <b>H</b>	30
Air Clearances	Each side (in.)	1/8
	Top (in.)	1
	Back (in.)	1

\*Height to mid-freezer (in.): 53-15/16

#### Note: All Top-Freezer No-Frost Right-Hand Refrigerator Doors:

As you face the front of the refrigerator, the handle is on your left and the hinges are on your right.

#### All Top-Freezer No-Frost Left-Hand Refrigerator Doors:

As you face the front of the refrigerator, the handle is on your right and the hinges are on your left.

Front View

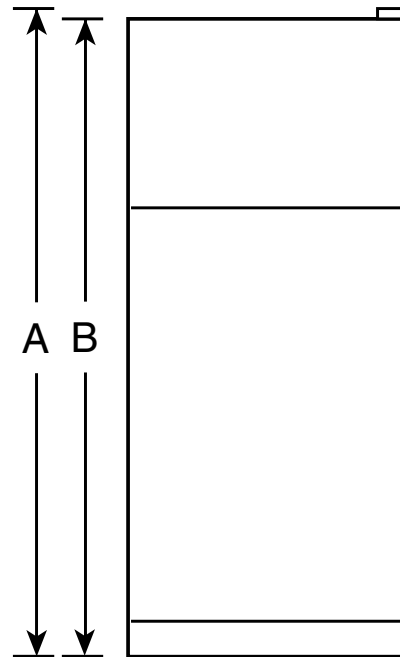

Top View

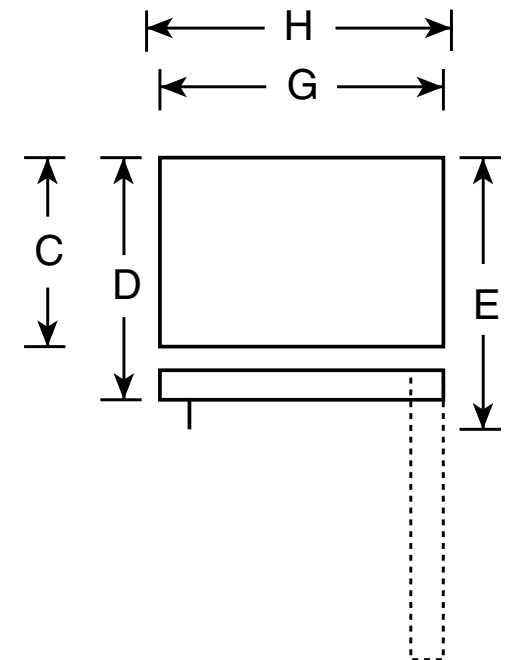

For answers to your Monogram®, GE Profile™ or GE® appliance questions, visit our website at [ge.com](http://ge.com) or call GE Answer Center® service, 800.626.2000.



Total volume and shelf area are calculated by the Association of Home Appliance Manufacturers' standards.



Listed by Underwriters Laboratories



As an ENERGY STAR® partner, GE has determined that this product meets the ENERGY STAR guidelines for energy efficiency.

# GTH18JBP

## GE® ENERGY STAR® 18.0 Cu. Ft. Top Freezer Refrigerator with Icemaker

### Features and Benefits

- Spill Proof Glass Shelves – Shelves slide out, and spills stay put
- Illuminated Upfront Slimline Temperature Controls – Offer maximum style and convenience
- Sealed Vegetable/Fruit Crisper – Provides the ideal storage environment for fruits and vegetables
- Automatic Moisture Control – Electronic sensors automatically control moisture, adjusting to room humidity changes
- Spill Proof Freezer Floor – Seamless design offers easy cleanup
- Gallon Door Storage – Makes room for milk and other gallon-size containers
- NeverClean™ Condenser – Condenser coils are encased, they don't require cleaning in normal operating environments
- Model GTH18JCPWW – White on white
- Model GTH18JCPCC – Bisque on bisque

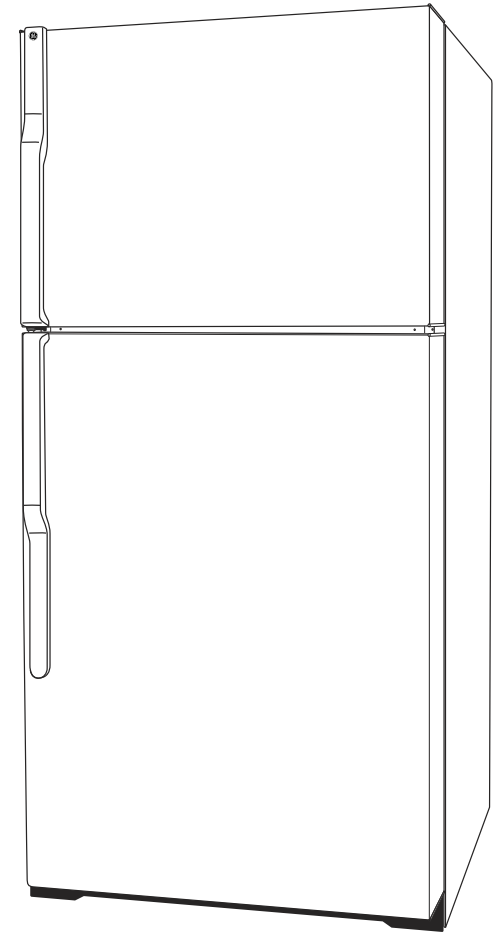

imagination at work



As an ENERGY STAR® partner, GE has determined that this product meets the ENERGY STAR guidelines for energy efficiency.