

GE APPLIANCES

DUCTLESS HVAC



Ductless HVAC products designed with the **PRO** top of mind.



GE APPLIANCES
a Haier company

AIR&WATER
SOLUTIONS

INTRODUCING A FULL DUCTLESS LINE THAT'S

PROCENTRIC

GE Appliances' ductless equipment is designed with the HVAC pro front and center. This full line of products with the GE name is a promise of quality, durability, performance — and, above all, our commitment to you, the pro.



PROMOTION

An iconic brand trusted in 50% of U.S. households* is easy for you to PROMote

PROACTIVE

You'll get PROactive support and training from a dedicated HVAC technical team

PROVIDE

We PROvide a full lineup of ductless HVAC products

PRODUCTIVE

Exclusive features make installation faster and you more PROductive

*Based on major appliances; does not include HVAC products.

PROMOTE AN ICONIC BRAND

A BRAND LIKE **NO OTHER**

GE Appliances' roots run deep — we've got a long history of making top-of-the-line appliances that pros recommend and homeowners trust. That legacy continues with our full line of ductless HVAC built with the HVAC professional in mind.

PROcentric means helping you win at the kitchen table, with a brand that is trusted in 50 percent of US homes.* That kind of equity is invaluable to homeowners who know our reputation for quality, reliability, and innovation.

*Based on major appliances; does not include HVAC products.



CONFIDENCE X3

TRAINING

Our dedicated HVAC training team is here to provide a full curriculum to help you learn the ins and outs of our product. Through GE Appliances' Air & Water Solutions Learning Academy, you'll be able to learn about products across our portfolio and stay up to date on your HVAC knowledge.

WARRANTY

Our ductless products come with a 5 year parts and 5 year compressor warranty. You can turn that into a 10 year limited parts and compressor warranty just by registering your product, giving homeowners extra peace of mind. See warranty documentation for full information.

SUPPORT

PEOPLE

Our full team of HVAC experts support the product and pros like you in the field. From leaders who have real-world field experience to specially trained front-line call-takers, we've got a team of experts to provide exactly the level of support you deserve.

TECHNOLOGY

With our visual support system, our experts can join you in the field, virtually! Our system lets you transmit video and still images of technical issues via the web on a tablet or smartphone, to our experts for quick solutions — no app download required.



PROVIDING A FULL LINEUP OF DUCTLESS SOLUTIONS

COMFORT **MADE CONVENIENT**

SINGLE ZONE SYSTEMS

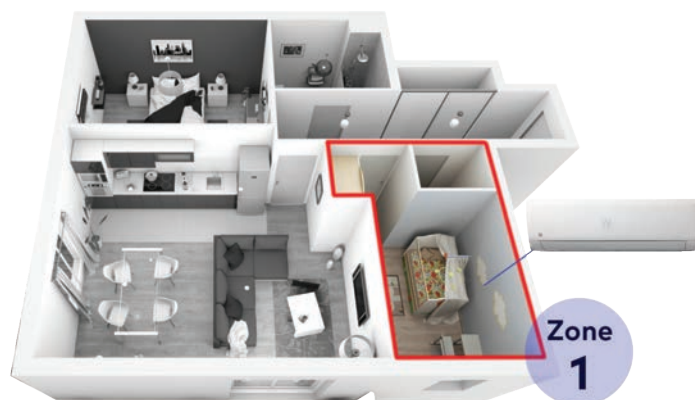

MULTI-ZONE SYSTEMS



CONTROL **MADE SIMPLE**



CONVENIENCE

With SmartHQ, we make your customer's lives easier by simplifying everyday activities and chores, and by helping them stay in control no matter where they are — like allowing them to start their highwall unit on the way home.

PERFORMANCE

Our ductless systems evolve with changing needs — accepting over-the-air (OTA) updates that can improve performance, add new features, or fix potential issues.

VOICE CONTROL

Simply connect one or more GE Appliances smart ductless systems to WiFi for hands-free temperature control.



FEATURES DESIGNED TO MAKE YOU MORE **PRODUCTIVE**

INSTALLATION **MADE EASY**



FEATURES INSTALLERS LOVE

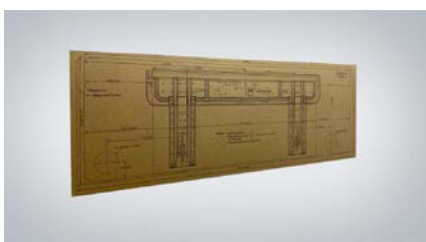

MOUNTING TEMPLATE

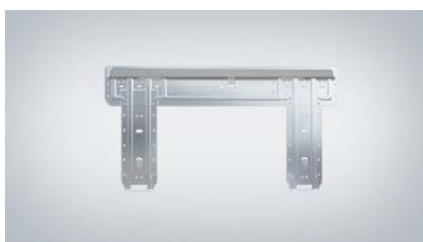

**MOUNTING PLATE
WITH DIMENSIONS**



EXTENDED KICKSTAND



**EASY ACCESS
CONTROL BOARD**

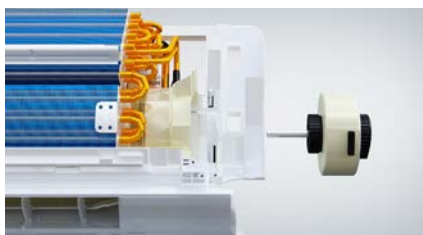

EASY ACCESS FAN MOTOR



DETACHABLE BOTTOM COVER

SERVICE **MADE FASTER**



Revolutionize the way you
diagnose GE Appliances
ductless systems



Communicate digitally with ductless
systems for real-time diagnosis



Identify root cause of issues
quickly and effectively



Extend the life of ductless systems
through proactive maintenance

BENEFITS

- ✓ Increase efficiency
- ✓ Reduce cost
- ✓ Increase first time completes
- ✓ Avoid unnecessary repairs

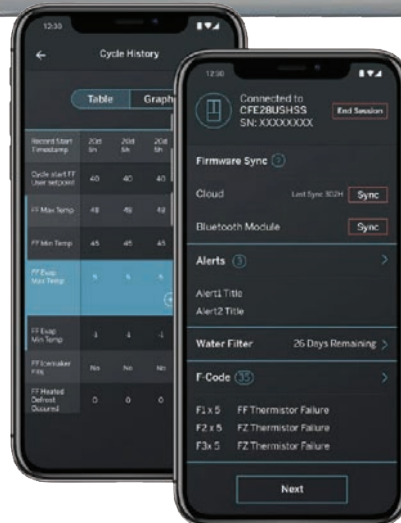

Download from the
App Store or Google Play.



SmartHQ Service Module (separate purchase) required.
SmartHQ connectivity varies by model. See SmartHQ
Compatibility for model compatibility specifications.

SINGLE ZONE SOLUTIONS

EXCEPTIONAL VALUE



- Up to 20 SEER2, 9.5 HSPF2.
- 9K, 12K BTU 115V options and 9K, 12K, 18K, and 24K BTU 230V options available.
- 24K, 30K, and 36K BTU Low Ambient Cooling Options available.

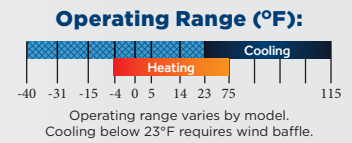

ADVANCED FEATURES



- Up to 23.5 SEER2, 10.5 HSPF2.
- 9K, 12K, 15K, 18K, and 24K BTU options available.

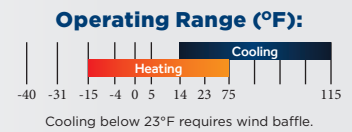

PREMIUM PERFORMANCE



- Up to 30 SEER2, 14 HSPF2.
- 9K, 12K, and 18K BTU highwall, console, cassette, or mid-static ducted options available.
- 24K, 30K, 36K, 42K, and 48K BTU models available.

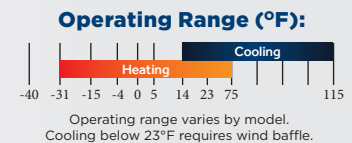

MULTI-ZONE SOLUTIONS

Single zone features, benefits, and performance, available now for multi-zone applications. Highwall, console, cassette, and mid-static ducted options available up to 5 zones.



- Up to 19.5 SEER2, 10.2 HSPF2.
- 2-zone, 3-zone and 4-zone available.

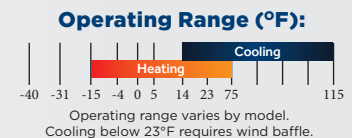

- Up to 22 SEER2, 10 HSPF2.
- 2-zone, 3-zone, 4-zone and 5-zone* available.

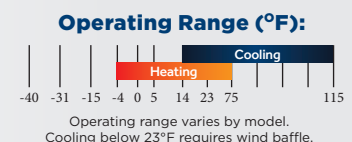

*5-zone MultiLink Series capable of low ambient heating down to -15°F