



GE Appliances

GTR15BBR – GE® 14.9 Cu. Ft. Top-Freezer No-Frost Refrigerator

Dimensions (in inches)

Front View

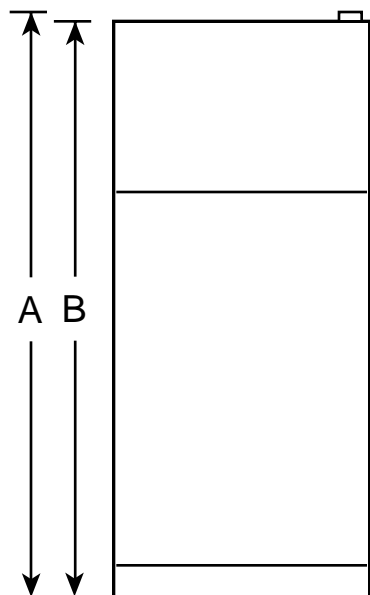

Top View

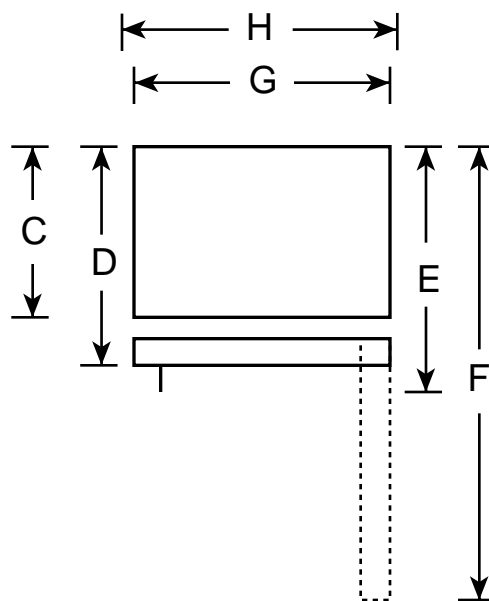

| | | |
|--------------------|---|--------|
| Overall Dimensions | Height to top of hinge (in.) A | 61-3/4 |
| | Height to top of case (in.) B | 61-1/4 |
| | Height to mid-freezer (in.) B | 51-3/8 |
| | Case depth without door (in.) C | 25-7/8 |
| | Case depth less door handle (in.) D | 29-1/8 |
| | Case depth with door handle (in.) E | 29-1/8 |
| | Depth with fresh food door open 90° (in.) F | 54-7/8 |
| | Width (in.) G | 28 |
| | Width with door open 90° with door handle (in.) H | 28-5/8 |
| Air Clearances | Each side (in.) | 3/4 |
| | Top (in.) | 1 |
| | Back (in.) | 1 |

Note: All Top-Freezer No-Frost Right-Hand Refrigerator Doors: As you face the front of the refrigerator, the handle is on your left and the hinges are on your right.
All Top-Freezer No-Frost Left-Hand Refrigerator Doors: As you face the front of the refrigerator, the handle is on your right and the hinges are on your left.



Total volume and shelf area are calculated by the Association of Home Appliance Manufacturers' standards.



Listed by Underwriters Laboratories



For answers to your Monogram®, GE Profile™ or GE® appliance questions, visit our website at GEAppliances.com or call GE Answer Center® service, 800.626.2000.



GE Appliances

GTR15BBR – GE® 14.9 Cu. Ft. Top-Freezer No-Frost Refrigerator

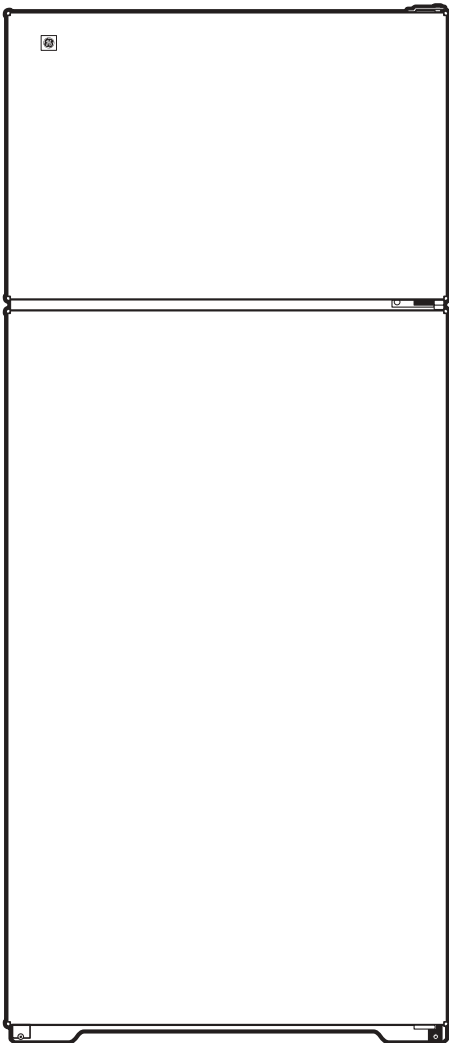

Features and Benefits

- Upfront Temperature Controls – Are positioned up front, close at hand, for maximum convenience and ease of use
- Adjustable Wire Shelves – Provide strong support and slide out with ease
- Vegetable/Fruit Crispers – Provide easy storage for fruits and vegetables
- Tall Bottle Door Storage – Designed to hold upright bottles and containers
- Gallon Door Storage – Makes room for milk and any other gallon size containers
- Recessed handles – Color-matched recessed door handles reflects the latest in European style and appearance
- NeverClean™ Condenser – Condenser coils are encased, so they don't require cleaning in normal operating environments
- Deluxe Quiet Design – Significantly reduces operating noise
- FrostGuard™ Technology – Reduces freezer burn, so foods retain their texture and flavor
- Square Doors – Classic design that's compatible with any kitchen décor
- Model GTR15BBRWW – White on white
- Model GTR15BBRCC – Bisque on bisque