

SECTION 1

FLUSH INSET INSTALLATION



SECTION 2

STANDARD INSTALLATION

1/4" FRAMED PANELS



3/4" OVERLAY PANELS



ELEVATE EVERYTHING[®]

MONOGRAM

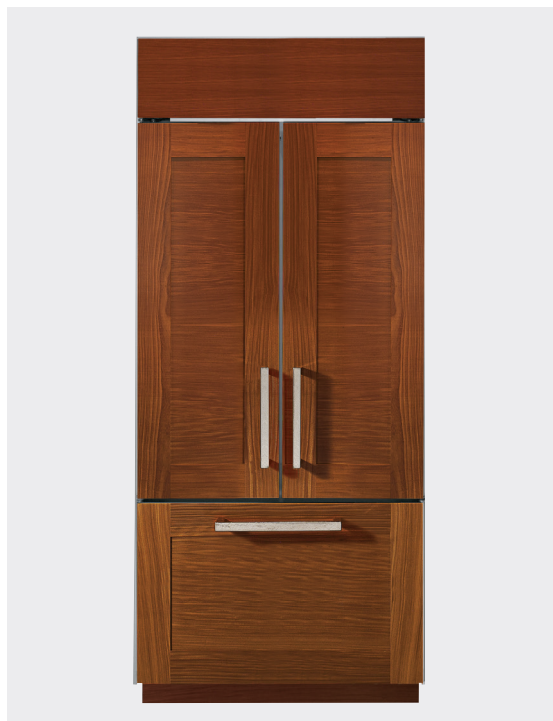

SPECIFICATIONS

Overall Width	38" (96.5 cm)
Overall Height	84 1/2" (214.6 cm)
Overall Depth	25 7/8" (49.5 cm)
Door Clearance	19 1/2" (49.5 cm)
Cutout Width	39" (99.1 cm)
Cutout Height	85" (215.9 cm)
Cutout Depth	26 3/16" (66.5 cm)
Plumbing Requirements	1/4" OD copper tubing or GE SmartConnect kit
Shipping Weight	663 lb (300.7 kg)

ATTENTION ELECTRICIAN:

A 115 volt 60Hz., 15 or 20 amp power supply is required. An individual properly grounded branch circuit or circuit breaker is recommended. Install a properly grounded 3-prong electrical receptacle recessed into the back wall.

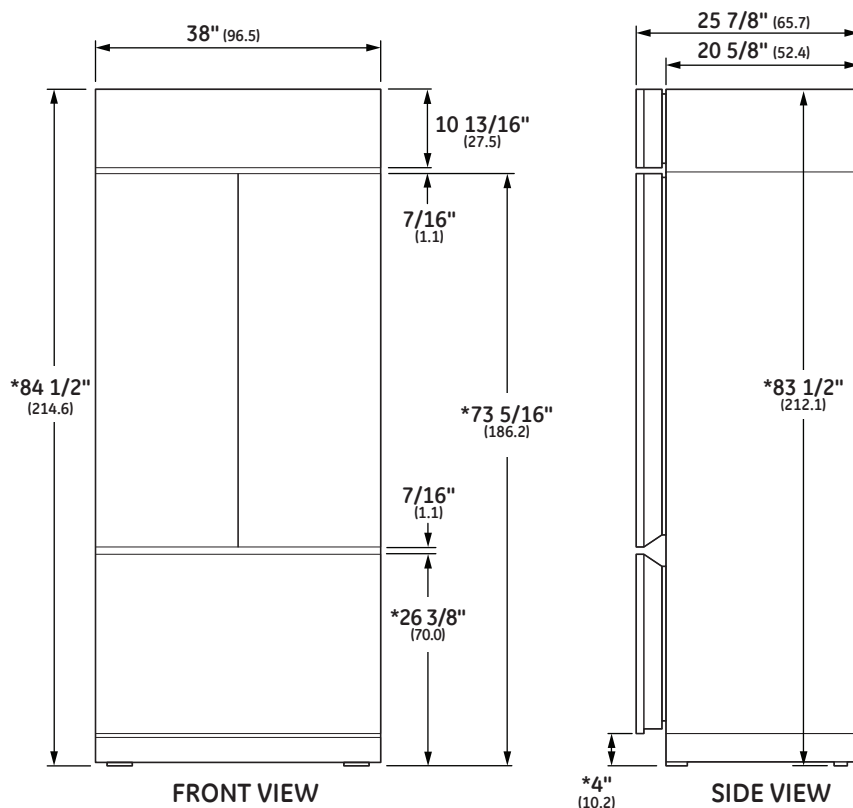
OVERALL DIMENSIONS
AFTER PANEL INSTALLFLUSH INSET
INSTALLATION

* Shipping height. Use leveling legs and wheels for maximum 1" height adjustment from shipping height.

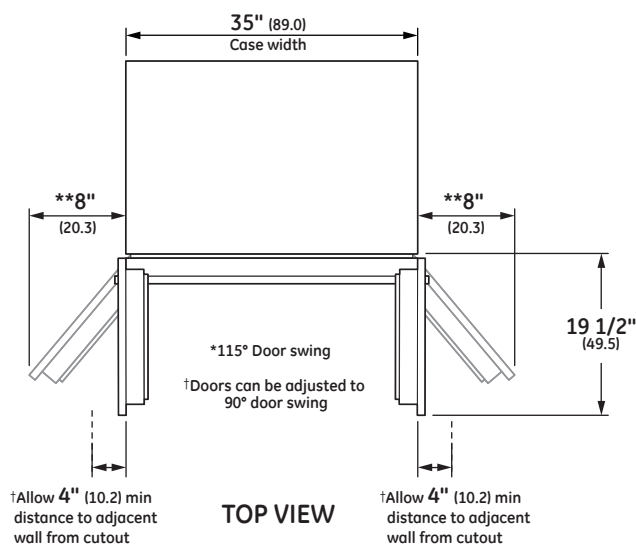

Dimensions in parentheses are in centimeters unless otherwise noted. Actual product dimensions may vary due to manufacturing tolerances.

ELEVATE EVERYTHING™

MONOGRAM

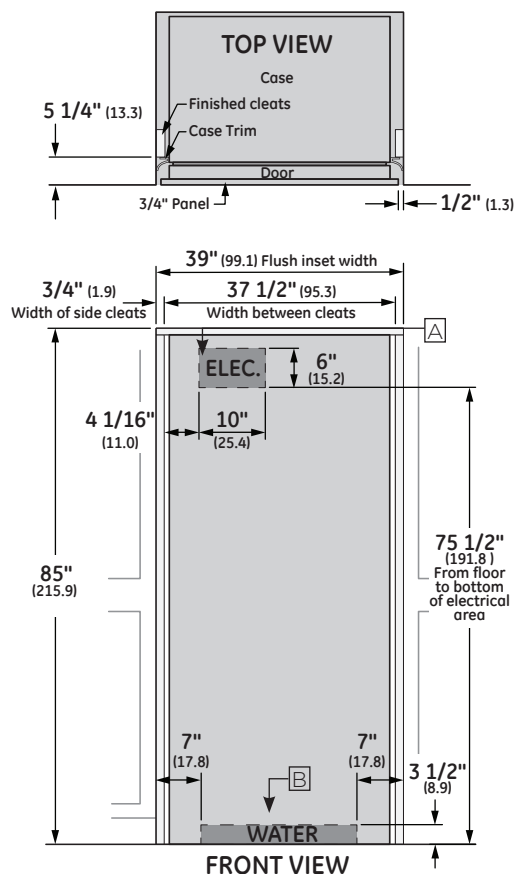
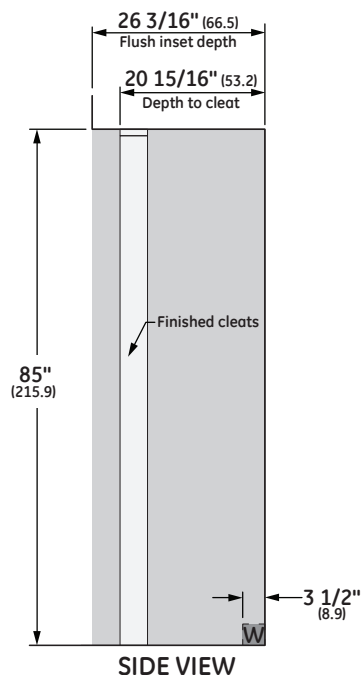
FLUSH INSET INSTALLATION
3/4" PANELSFLUSH INSET
INSTALLATION

NOTES

Ⓐ Mounting the junction box in this location will also allow for front accessibility through access panel.

Ⓑ Water supply area

⚠ WARNING:

The refrigerator is top heavy and must be secured to prevent the possibility of tipping forward. Failure to do so may result in death or serious injury.

The information below is for cabinet design only. When installing the anti-tip system you must use the product installation instructions.

The information below applies to all installation constructions:

- A wall bracket, bolts and toggles will be supplied with the unit.
- The bolts will be used to attach bracket to wall in 4 locations. Two of the locations must penetrate the center of the wall studs.
- The toggles are used for stability in drywall and when metal studs are encountered. Lag bolts are used in wood studs.
- In installation opening, measure 81-1/2" from floor and draw a horizontal line.
- Locate and mark the wall studs on horizontal line. Verify at least two studs have their centerlines within the center 32-1/2" of installation opening to ensure 2 wall studs are penetrated.
- The bracket will be centered left to right in opening with bottom of bracket on the horizontal line.
- When unit is placed in opening, the bracket tabs will align with openings in back of the unit. The unit will be secured to the bracket using supplied "L" bolts.

See Installation Instructions for detailed instructions.

ANTI-TIP BRACKET

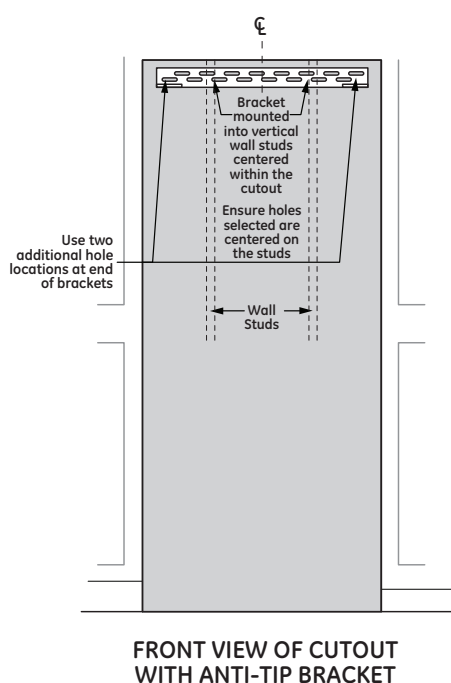
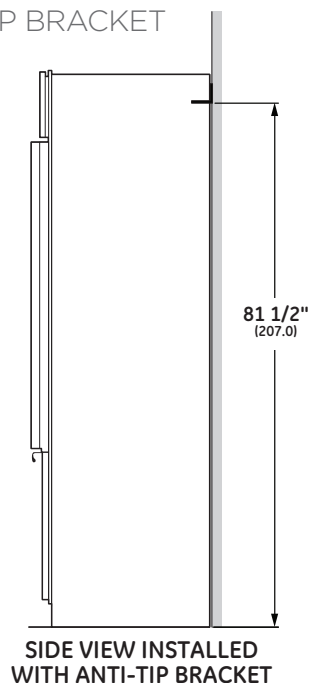

ELEVATE EVERYTHING™

MONOGRAM

FLUSH INSET 3/4" PANEL DIMENSIONS

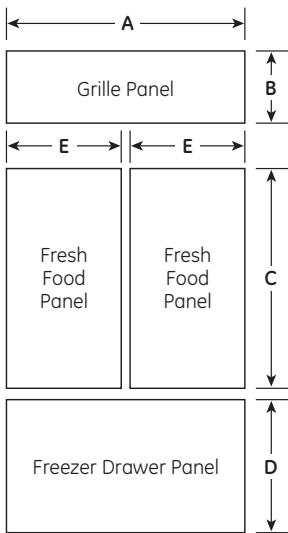

PANEL DIMENSIONS

A	B	C	D	E
38"	10 13/16"	46 7/16"	22 3/8"	18 3/4"

FLUSH INSET
INSTALLATION

NOTES

Trimmed refrigerators are designed to be customized with decorative panels. Field-installed 1/2" or 3/4" custom door, drawer and grille panels are required. For 3/4" raised panels, routing is required. The router depth is 1/4" all the way around the panel's backs. Additional panel width reductions are required per the diagrams shown. This will create "picture frame" routing allowing the panels to slide into the attached door, drawer and grille trims.

- Maximum total panel weight:
- Fresh food door panels – 30 lbs.
 - Freezer drawer panel – 28 lbs.
 - Grille panel – 11 lbs

Note: For panels constructed with rails and stiles (5-panel), the rails must be a minimum of 3" wide and stiles must be a minimum of 4" wide.

Door Handles
Door handles not included. Custom handles supplied by your cabinet maker may be used.

ZKHFD2H: European tubular stainless steel handles designed to fit 3/4" panels. Kit includes three handles.

3/4" RAISED FRESH FOOD DOOR PANELS ROUTING

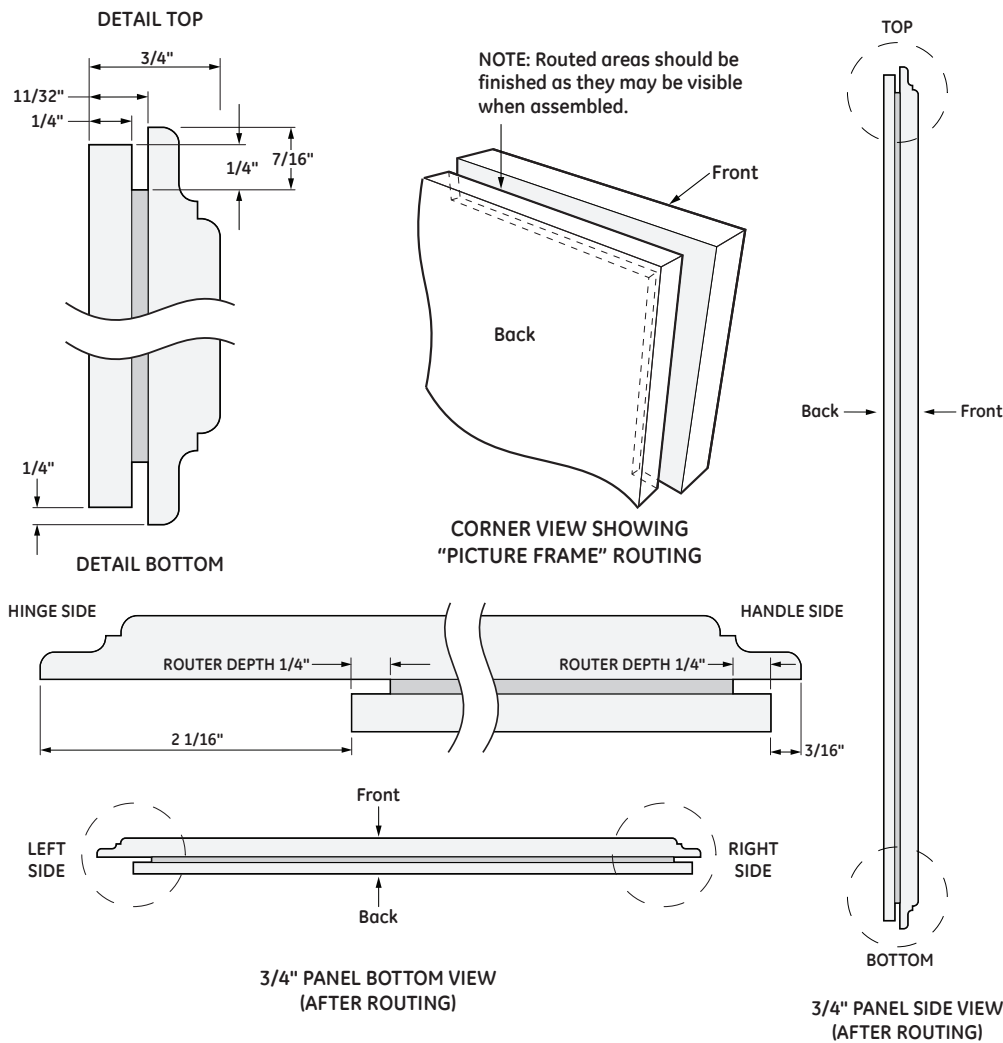

ELEVATE EVERYTHING™

MONOGRAM

3/4" RAISED FREEZER DRAWER PANEL ROUTING

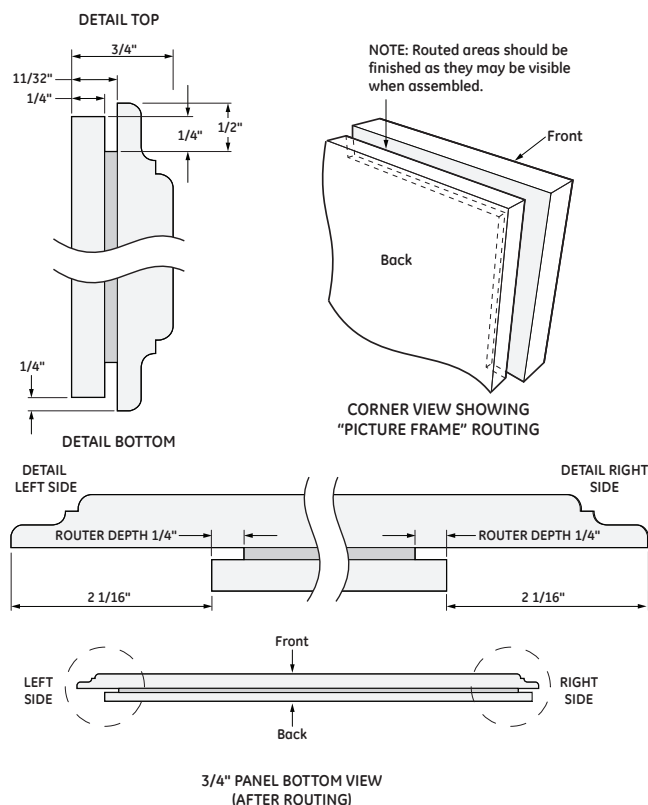

FLUSH INSET INSTALLATION

NOTES

Trimmed refrigerators are designed to be customized with decorative panels. Field-installed 1/2" or 3/4" custom door, drawer and grille panels are required. For 3/4" raised panels, routing is required. The router depth is 1/4" all the way around the panel's backs. Additional panel width reductions are required per the diagrams shown. This will create "picture frame" routing allowing the panels to slide into the attached door, drawer and grille trims.

Maximum total panel weight:

- Fresh food door panels - 30 lbs.
- Freezer drawer panel - 28 lbs.
- Grille panel - 11 lbs

Note: For panels constructed with rails and stiles (5-panel), the rails must be a minimum of 3" wide and stiles must be a minimum of 4" wide.

Door Handles

Door handles not included. Custom handles supplied by your cabinet maker may be used.

ZKHFD2H: European tubular stainless steel handles designed to fit 3/4" panels. Kit includes three handles.

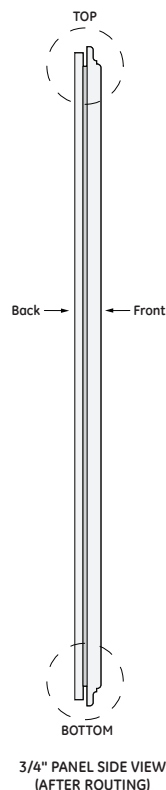

3/4" RAISED GRILLE PANEL ROUTING

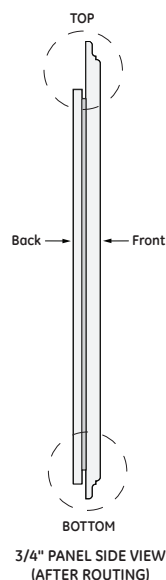
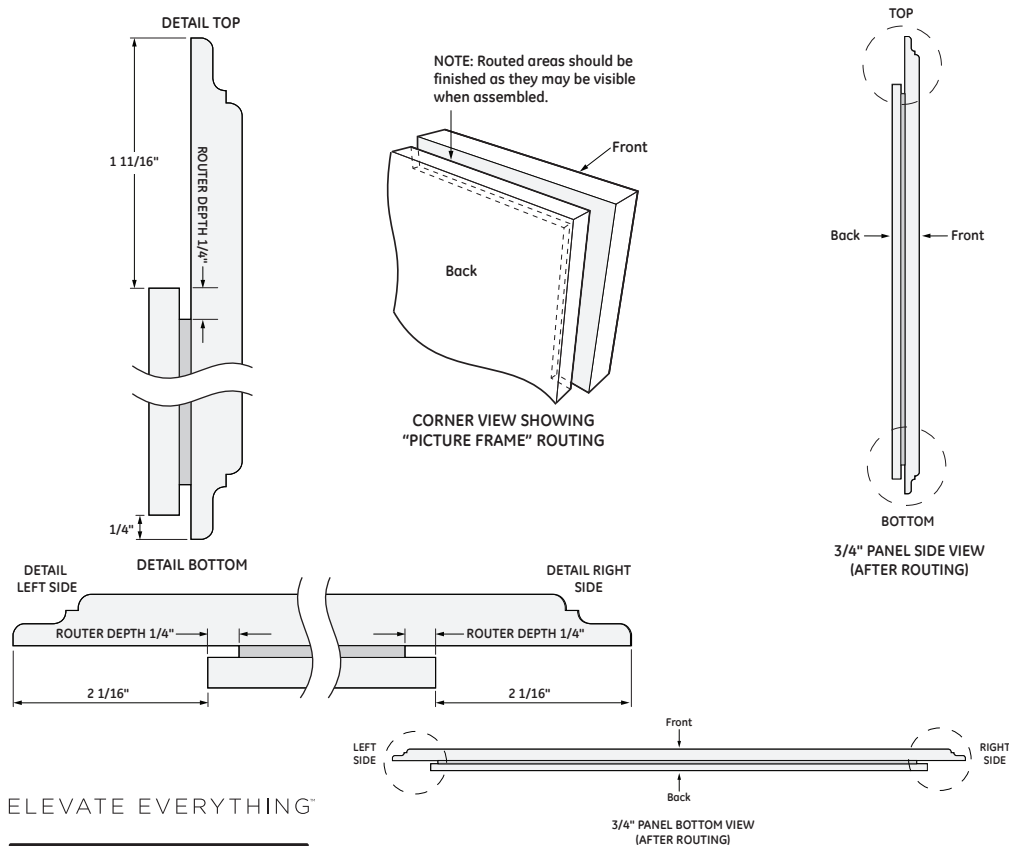

ELEVATE EVERYTHING™

MONOGRAM

FLUSH INSET INSTALLATION 1/2" PANELS

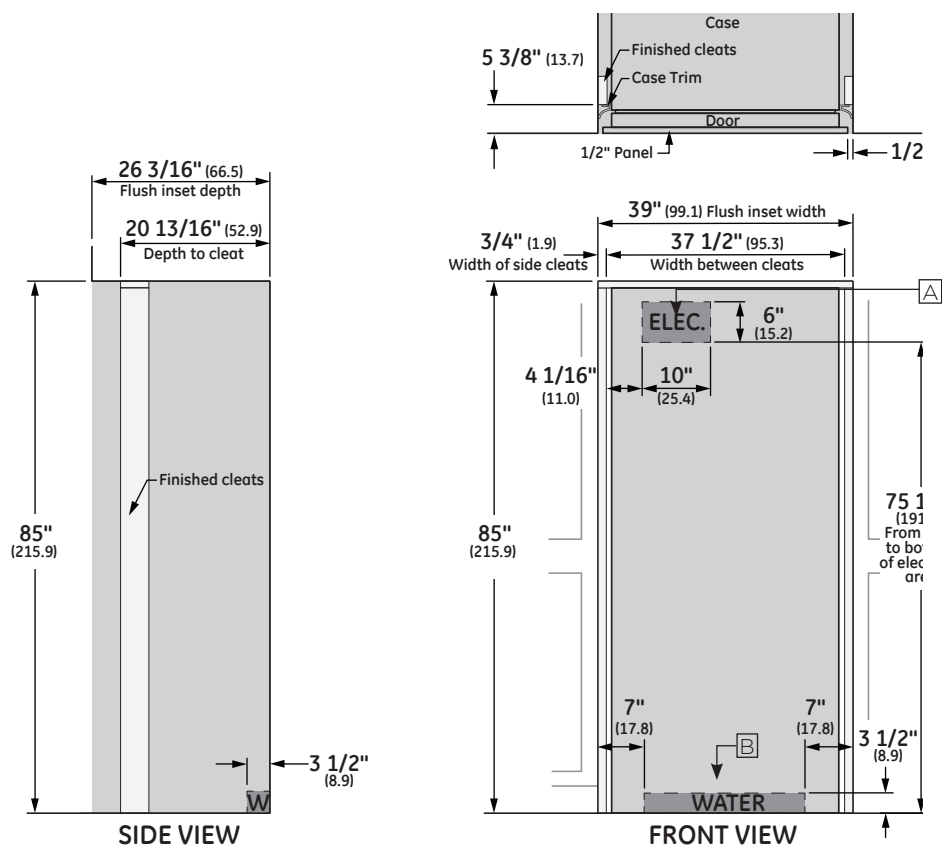

FLUSH INSET INSTALLATION

NOTES

- [A] Mounting the junction box in this location will also allow for front accessibility through access panel.
- [B] Water supply area



WARNING:

The refrigerator is top heavy and must be secured to prevent the possibility of tipping forward. Failure to do so may result in death or serious injury.

The information below is for cabinet design only. When installing the anti-tip system you must use the product installation instructions.

The information below applies to all installation constructions:

- A wall bracket, bolts and toggles will be supplied with the unit.
- The bolts will be used to attach bracket to wall in 4 locations. Two of the locations must penetrate the center of the wall studs.
- The toggles are used for stability in drywall and when metal studs are encountered. Lag bolts are used in wood studs.
- In installation opening, measure 81-1/2" from floor and draw a horizontal line.
- Locate and mark the wall studs on horizontal line. Verify at least two studs have their centerlines within the center 32-1/2" of installation opening to ensure 2 wall studs are penetrated.
- The bracket will be centered left to right in opening with bottom of bracket on the horizontal line.
- When unit is placed in opening, the bracket tabs will align with openings in back of the unit. The unit will be secured to the bracket using supplied "L" bolts.

See Installation Instructions for detailed instructions.

ANTI-TIP BRACKET

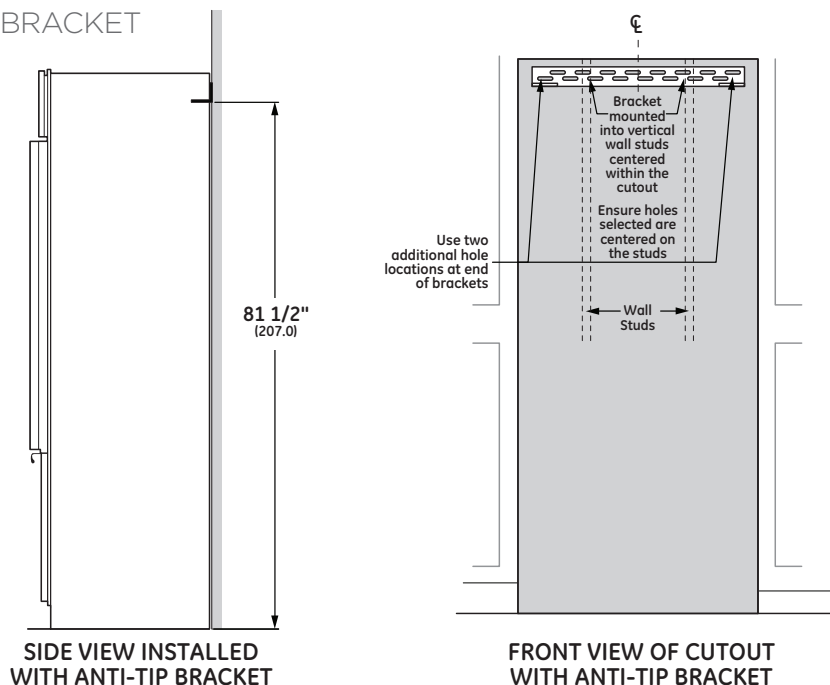

ELEVATE EVERYTHING™

MONOGRAM

FLUSH INSET 1/2" PANEL DIMENSIONS

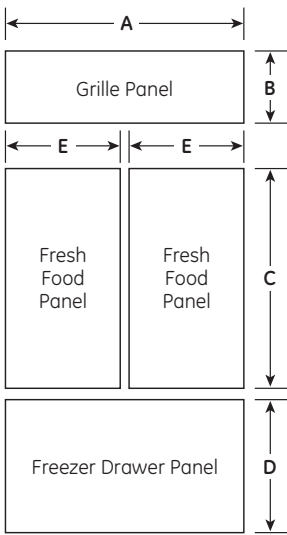

PANEL DIMENSIONS

	A	B	C	D	E
1/4" Backer Panel	33 7/8"	8 7/8"	46 1/16"	21 7/8"	16 1/2"
.10" Space Panel	32 1/2"	7 5/8"	44 11/16"	20 1/2"	15"
1/2" Overlay Panel	38"	10 13/16"	46 7/16"	22 3/8"	18 3/4"

FLUSH INSET INSTALLATION

NOTES

- The 1/2" overlay panel must be secured to a .10" spacer panel and a 1/4" thick backer panel, which slides into the trim.
- Assemble the panels with glue and screws:
- Center the spacer panel on the backer panel, left to right and top to bottom. Secure the panels with glue.
 - Refer to the chart for locating the backer panel to the overlay panel. Secure the overlay panel to the backer panel with glue and screws. Screws must be countersunk into the backer panel.
- Maximum total panel weight:
- Fresh food door panel – 30 lbs.
 - Freezer drawer panel – 28 lbs.
 - Grille panel – 11 lbs.
- Note: For panels constructed with rails and stiles (5-panel), the rails must be a minimum of 3" wide and stiles must be a minimum of 4" wide.

1/4" BACKER ASSEMBLY DIMENSIONS

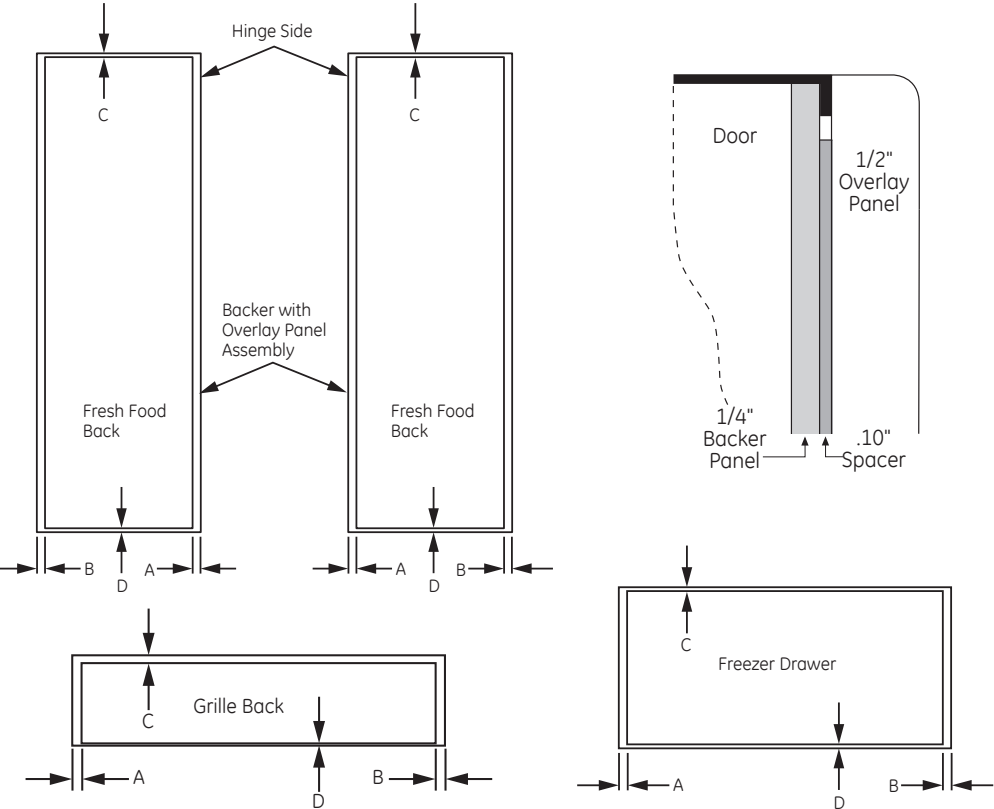

PANEL DIMENSIONS

	A	B	C	D
Fresh Food Door Panels	2 1/16"	3/16"	3/16"	3/16"
Freezer Drawer Panel	2 1/16"	2 1/16"	1/4"	1/4"
Grille Panel	2 1/16"	2 1/16"	11 11/16"	1/4"

⚠ WARNING:



Door Trim Pinch Point
Hazard Improper installation can lead to a finger pinch point hazard between the side door trim and the cabinets when operating the door, especially with children. To minimize this risk you must follow the installation instructions for cabinet dimensions, trim assembly and door stop angle.

ELEVATE EVERYTHING™





SPECIFICATIONS

Overall Width	36" (91.4 cm)
Overall Height	84" (213.4 cm)
Overall Depth	25 3/8" (64.5 cm)
Door Clearance	18 3/16" (46.2 cm)
Cutout Width	35 1/2" (90.2 cm)
Cutout Height	84" (213.4 cm)
Cutout Depth	24" (61 cm)
Plumbing Requirements	1/4" OD copper tubing or GE SmartConnect kit
Shipping Weight	614 lb

ATTENTION ELECTRICIAN:

A 115 volt 60Hz., 15 or 20 amp power supply is required. An individual properly grounded branch circuit or circuit breaker is recommended. Install a properly grounded 3-prong electrical receptacle recessed into the back wall.

OVERALL DIMENSIONS
AFTER PANEL INSTALL

STANDARD
INSTALLATION

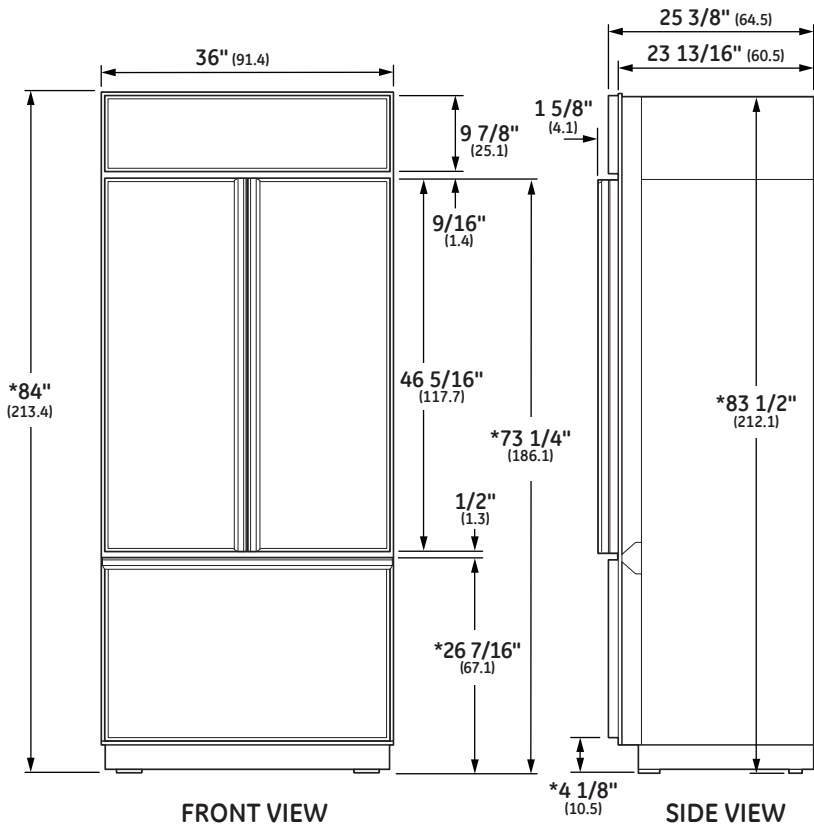

*Shipping height. Use leveling legs and wheels for maximum 1" height adjustment from shipping height.

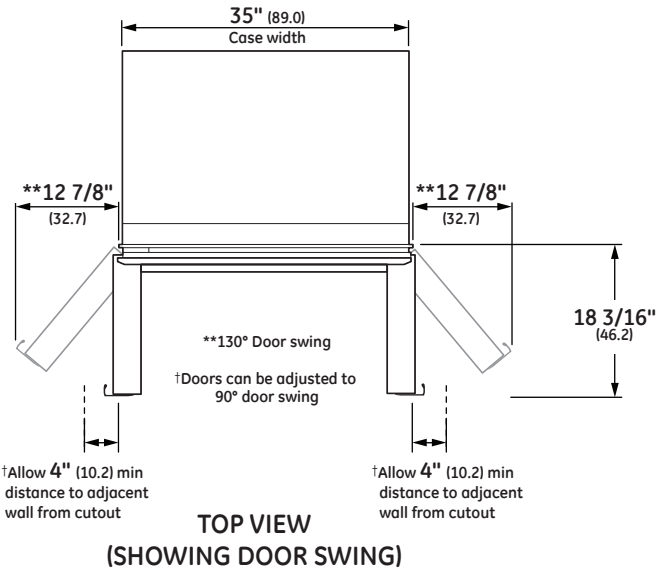

Dimensions in parentheses are in centimeters unless otherwise noted. Actual product dimensions may vary due to manufacturing tolerances.

ELEVATE EVERYTHING™

MONOGRAM

STANDARD INSTALLATION 3/4" PANELS

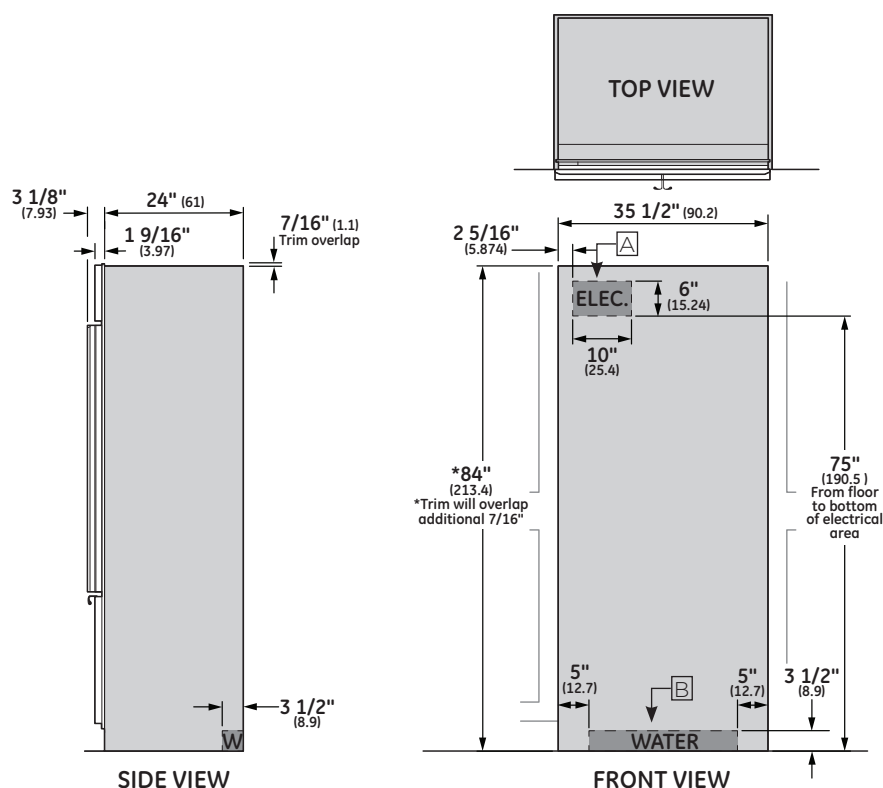

STANDARD INSTALLATION

NOTES

Ⓐ Mounting the junction box in this location will also allow for front accessibility through access panel.

Ⓑ Water supply area

⚠ WARNING:

The refrigerator is top heavy and must be secured to prevent the possibility of tipping forward. Failure to do so may result in death or serious injury.

The information below is for cabinet design only. When installing the anti-tip system you must use the product installation instructions.

The information below applies to all installation constructions:

- A wall bracket, bolts and toggles will be supplied with the unit.
- The bolts will be used to attach bracket to wall in 4 locations. Two of the locations must penetrate the center of the wall studs.
- The toggles are used for stability in drywall and when metal studs are encountered. Lag bolts are used in wood studs.
- In installation opening, measure 81-1/2" from floor and draw a horizontal line.
- Locate and mark the wall studs on horizontal line. Verify at least two studs have their centerlines within the center 32-1/2" of installation opening to ensure 2 wall studs are penetrated.
- The bracket will be centered left to right in opening with bottom of bracket on the horizontal line.
- When unit is placed in opening, the bracket tabs will align with openings in back of the unit. The unit will be secured to the bracket using supplied "L" bolts.

See Installation Instructions for detailed instructions.

ANTI-TIP BRACKET

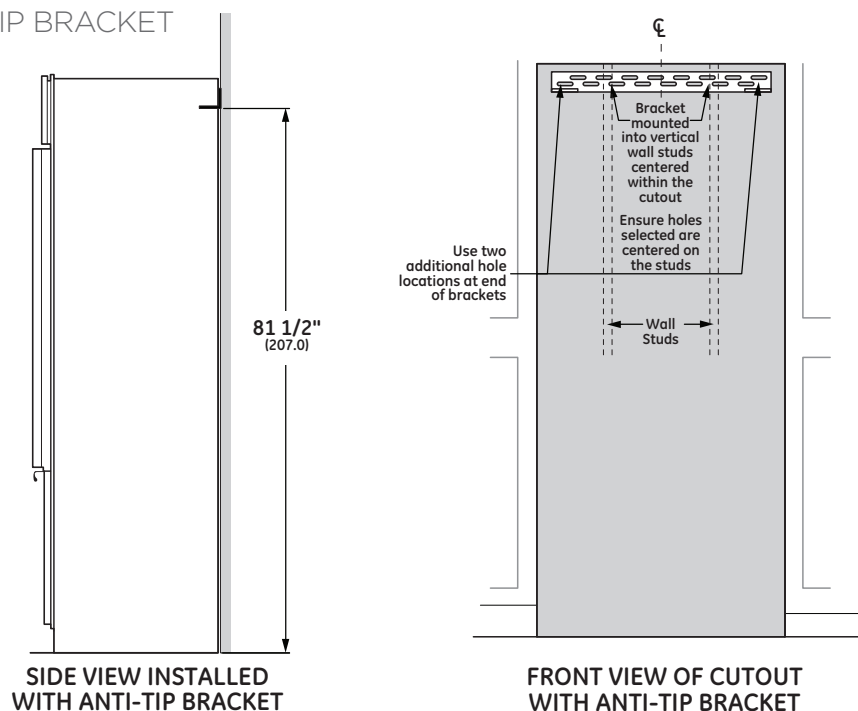

ELEVATE EVERYTHING™

MONOGRAM

STANDARD 1/4" FRAMED PANEL DIMENSIONS

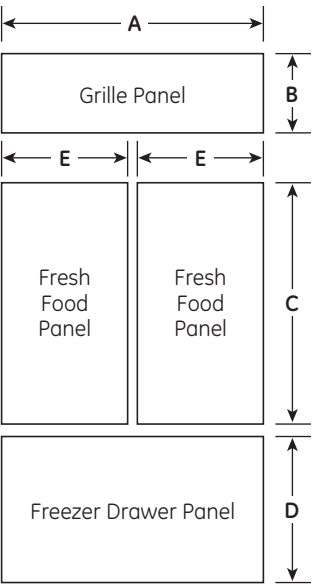

PANEL ASSEMBLY CROSS SECTION



PANEL DIMENSIONS

	A	B	C	D	E
1/4" Framed Panel	33 7/8"	8 7/8"	46 1/16"	21 7/8"	16 1/2"

STANDARD
INSTALLATION

NOTES

Trimmed refrigerators are designed to be customized with decorative panels. Field-installed custom door and grille panels are required.

1/4" Framed Panels:

For 1/4" thick custom panels ordered from your cabinet maker. The decorative panels slide into this trim.

- Maximum total panel weight:
- Fresh food door panel – 30 lbs.
 - Freezer drawer panel – 28 lbs.
 - Grille panel – 11 lbs

Door Handles:
The supplied handles accommodate both framed or overlay panels. Custom handles of your choice, supplied by your cabinet maker, can also be installed.

The diagram illustrates the layout of a refrigerator with the following components and dimensions:

- Grille Panel:** The top panel, with a width of **A** and a height of **B**.
- Fresh Food Panel:** Two side-by-side panels below the grille panel, each with a width of **E**. The combined height of these panels is **C**.
- Freezer Drawer Panel:** The bottom panel, with a height of **D**.

Diagram illustrating the components of a door assembly:

- Trim
- Door
- 1/4" Backer Panel
- .10" Spacer Panel
- 3/4" Overlay Panel
- Supplied Handles

	A	B	C	D	E
1/4" Framed Panel	33 7/8"	8 7/8"	46 1/16"	21 7/8"	16 1/2"
.10" Framed Panel	32 1/2"	7 5/8"	44 11/16"	20 1/2"	15"
3/4" Overlay Panel	34 1/8"	9"	46 5/16"	22"	16 5/8"

The diagram illustrates the assembly of the refrigerator back, showing three main components and their alignment:

- Hinge Side:** The top left section, featuring a vertical panel with a hinge mechanism. It is labeled "Hinge Side" and "Fresh Food Back".
- Backer with Overlay Panel Assembly:** The central section, featuring a vertical panel with an overlay panel. It is labeled "Backer with Overlay Panel Assembly" and "Fresh Food Back".
- Grill Back:** The bottom section, featuring a horizontal panel with a grill. It is labeled "Grill Back".

The diagram shows the alignment of the components, with dimensions A, B, and C indicated. Dimension A is the distance from the center of the hinge to the center of the grill. Dimension B is the distance from the center of the grill to the center of the overlay panel. Dimension C is the distance from the top of the hinge to the top of the overlay panel. The diagram also shows the "Hinge Side" and "Backer with Overlay Panel Assembly" labels pointing to their respective components.

	A	B	C	D
Fresh Food Door Panels	1/8"	0	1/8"	1/8"
Freezer Drawer Panel	1/8"	1/8"	1/16"	1/16"
Grille Panel	1/8"	1/8"	1/16"	1/16"

Product Specification Revised 1/18

FEATURES AND BENEFITS

FRENCH DOOR DESIGN

Gives your wide-open access to every fresh food shelf and bin

FINELY CRAFTED GLASS-FRONT METAL DOOR BINS WITH RIVETED METAL ACCENTS offer easy access to beverages and quick-grab items

LED LIGHTING

positioned throughout the interior and under fresh food drawers spotlights food inside the refrigerator and in the freezer

UPFRONT ELECTRONIC CONTROLS WITH DIGITAL READOUT

Offer a range of precise temperature settings, all within easy reach

LARGE FULL-EXTENSION FREEZER DRAWER has storage bins that slide out independently of one another for easy loading and unloading. An automatic icemaker keeps plenty of filtered ice on hand

PRECISION GLASS-FRONT PRODUCE AND DELI DRAWERS Feature full-extension, soft-close slides

ALUMINUM TRIMMED GLASS SHELVES Allow convenient access to contents in the fresh-food compartment



70 to 90% U.S. content. Product content details at GEAppliances.com/USA



ELEVATE EVERYTHING™

MONOGRAM