



Installation Instructions

Heavy-Duty Water Filtration System GXWH60T

SAFETY PRECAUTIONS

- Check with your state and local public works department for plumbing and sanitation codes. You must follow these guidelines as you install the Heavy-Duty Water Filtration Housing. Using a qualified installer is recommended.
- Be sure the water supply conforms with the Performance Data. If the water supply conditions are unknown, contact your municipal water company.

▲ WARNING

Do not use with water that is microbiologically unsafe or of unknown quality without adequate disinfection before or after the system.

- It is highly recommended that a water shut-off valve be placed directly upstream of your household filter.

PROPER INSTALLATION

This Heavy-Duty Water Filtration System must be properly installed and located in accordance with the Installation Instructions before it is used.

- **Check with your local public works department for plumbing codes. You must follow their guides as you install the Heavy-Duty Water Filtration System.**
- **Use the Heavy-Duty Water Filtration System on a potable, safe-to-drink, home COLD water supply only. The filter cartridge will not purify water or make unsafe water safe to drink.**
- **Protect the Heavy-Duty Water Filtration System and piping from freezing. Water freezing in the housing will damage it.**
- **Your Heavy-Duty Water Filtration System is rated up to 100 psi water pressure. If your house water supply pressure is higher than 80 psi during the day (it may reach higher levels at night), install a pressure-reducing valve before the housing is installed.**

- **Do not install on HOT WATER.** The temperature of the water supply to the Heavy-Duty Filtration System must be between the minimum of 40°F and the maximum of 100°F. See the Performance Data section.
- **Do not install the Heavy-Duty Water Filtration System using copper solder fittings.** The heat from the soldering process will damage the unit.

▲ WARNING

Discard all unused parts and packaging material after installation. Small parts remaining after installation could be a choke hazard.

- **Do not install filter in an outside location or anywhere it will be exposed to sunlight.**

REQUIRED TOOLS AND ACCESSORIES FOR INSTALLATION

- 2 Adjustable wrenches
- Ruler or tape measure
- File
- Screwdriver
- 4 wall mounting fasteners. See below the fastener specification corresponding to your situation
 - When mounting to a poured concrete slab wall - 5/16" x 1-1/2" lag screw with anchor sleeve
 - When mounting to a cinder block wall - 5/16" X 1-1/2" lag screw with anchor sleeve
 - When mounting to a drywall – use heavy duty wall anchors, minimum weight capacity of 75 pounds
 - When mounting to a wall with exposed studs, mount a 2 x 4 length of wood between two studs using 3" wood screws. Then mount bracket to new 2 x 4 length, using 3" wood screws.

- Pipe cutter
- Cordless drill
- Emery paper

- Additional installation parts may be required:
 - 2 fittings to connect household plumbing to 1" female NPTF threads on filter housing
 - UL-approved grounding clamps and 6-gauge copper grounding wire
 - Teflon tape
 - Expansion tank

Optional accessories are available (Visa, MasterCard or Discover cards accepted) by visiting our Website at **GEAppliances.com** or from Parts and Accessories, call 800.952.5039 (US).

CONTENTS INCLUDED WITH PRODUCT

- Filter housing and head
- Product literature
- Housing wrench
- Mounting bracket
- 4 Hex-head screws

For any other type of construction not mentioned above, refer to a licensed contractor.

NOTE: To assure firm mounting of the water system, follow recommendation from the fastener manufacturer for installation.



The GXWH60T is Tested and Certified by NSF International against NSF/ANSI Standard 42 for materials and structural integrity requirements.

CARTRIDGE SPECIFICATIONS

Performance Data – Filtration System GXWH60T Using Filter FXWPT

Performance data sheet is available at gewaterfilters.com

Filter Cartridge Replacement

You should change your filter when the water flow is noticeably reduced or at least every 3 months.

1. Turn off water to filter.
2. Press the red pressure-release button to release pressure.
3. Unscrew the filter housing and discard used filter. Wash the filter housing with mild soap and water. **Do not** use harsh cleaners or hot water.
4. Inspect the filter housing O-ring. Make sure it is lightly lubricated with clean food-grade silicone grease (silicone grease is available through GE Appliances Parts and Accessories: 800.952.5039 (US), part number WS60S10005). Be sure the O-ring is seated in the groove. It is recommended that you replace the O-ring if it is damaged.
5. Place a new filter cartridge into the filter housing, making sure it is centered and completely seated on the bottom seal.
6. Reinstall the filter housing to the unit. Use the canister wrench to tighten the canister. **DO NOT OVERTIGHTEN.**
7. Slowly rotate the control handle to the FILTER position.
8. Turn on water to filter.
9. After installation, open any downstream faucet and flush the cartridge for 10 minutes (40 gallons), wait one hour, then flush again for 10 minutes (40 gallons) before using the water.

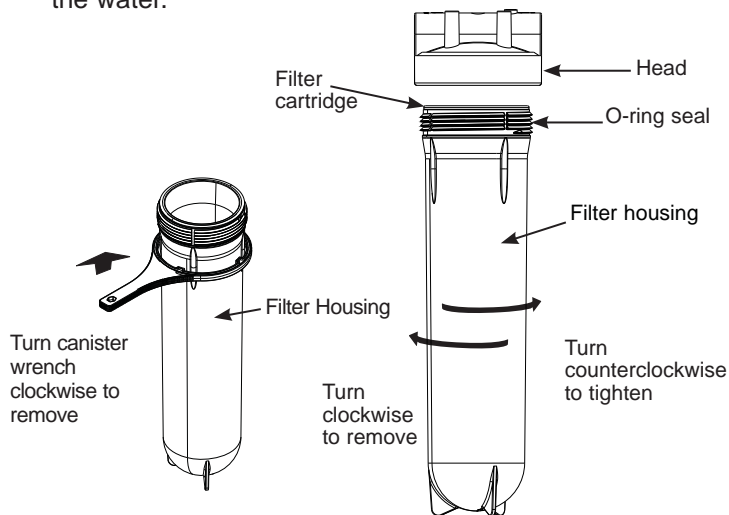

STEP-BY-STEP INSTALLATION INSTRUCTIONS

Installation Overview

NOTE: Be sure to allow a minimum space of 1½"–2" under the filter for removing the filter housing to change the cartridge.

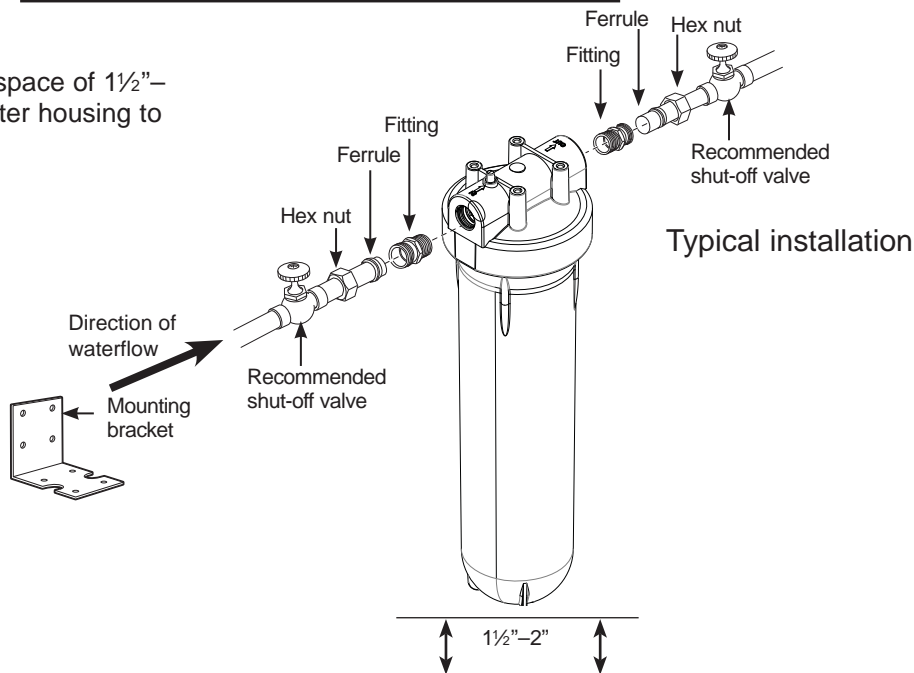

Select Location

Select a location for the filter that is:

- protected from freezing.
- not exposed to direct sunlight.

It is recommended that a shut-off valve be placed on both sides of

the filter.

It is recommended that a mounting bracket be used.

It is recommended to install an expansion tank in the cold water line between the water heater and the filter.

STEP-BY-STEP INSTALLATION INSTRUCTIONS (cont.)

Cut Water Line

⚠ WARNING

A copper or galvanized cold water pipe may be used to ground electrical outlets in the home. Failure to maintain this ground path may result in an electric shock hazard. If the cold water pipe is used to ground electrical outlets, please refer to the Installing the Ground Wire section before cutting the pipe.

1. Turn off the water supply and open a nearby faucet to drain the water out of pipes.
2. Using a tape measure or ruler, measure the distance "D" as shown.
 - **NOTE:** It is recommended that the shut-off valve be placed before and after the filter as shown in the Installation Overview illustration.

- Select a secure location surface to install filter and mounting bracket. The location should align the filter housing with inlet and outlet pipe and should not cause the pipes to bend or damage. Mark the distance "D" on the pipe. D is about 7 $\frac{3}{4}$ ".

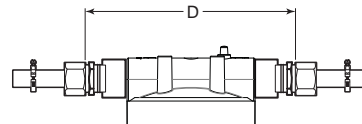

3. Using a pipe cutter, cut pipe. Sand (file) cut ends of pipe to ensure that they are square and smooth.
 - **NOTE:** Have a bucket and towel available to collect excess water.

Install Mounting Bracket and Fittings

Instructions are for installing fittings onto copper plumbing. If the unit is to be installed on any other type of tubing (plastic, PVC, galvanized), consult a qualified plumber for additional hardware.

1. Attach heavy-duty mounting bracket to head assembly with four hex-head screws as shown in illustration.

The bracket can be used as a template for marking the location of the mounting screws.

2. Apply 4 or 5 wraps of Teflon tape, in a clockwise direction, to the pipe threads of each fitting.
DO NOT use joint compound on any parts connecting to filter housing.

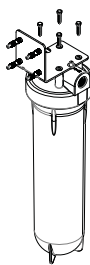

3. Assemble fitting to the inlet and outlet of the head. Start each fitting by hand to make sure they don't cross-thread. Use an adjustable wrench to tighten fittings. **DO NOT OVERTIGHTEN.** About 1–2 thread(s) should remain visible.
4. Ensure the bracket is leveled. Securely mount the filter bracket to the wall (Fasteners not included).
5. Install the head cover. Head cover is reversible for various installations.
6. Install the handle.

Attach Fittings to Water Line

1. Slip a compression nut onto each pipe.
2. Next, slip the brass ferrule onto each pipe.

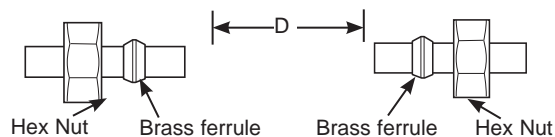

Installing the Unit

1. Align filter assembly with pipe ends making certain that the incoming water supply is going into the filter opening marked "IN." It may be necessary to spread the pipe ends apart to install filter assembly.
2. Using two adjustable wrenches, hold incoming fitting securely with one wrench and tighten nut with second wrench. Repeat this procedure for outgoing fitting.

3. If mounting bracket is not used, support the water pipe on either side of the filter unit.
4. Install a filter and tighten canister to seal (see Filter Cartridge Replacement section).

Installing the Ground Wire

NOTE: If your house plumbing is plastic, it would not be used as a grounding path, and this step should be skipped.

IMPORTANT: A copper or galvanized house cold water pipe is often used to ground electrical outlets in the home. Grounding protects you from electrical shock. The water filter housing may have broken this ground path. To restore connection, install an 18"-long, 6-gauge copper wire across the filter, tightly clamped using UL-approved 1/2"–1" bronze grounding clamps at both ends as shown. Zinc clamps should not be used on copper plumbing. Wire and clamps may be purchased separately from your local hardware store.

1. Clean copper pipe and ends of wire with emery paper. Bare wire is recommended. If insulated wire is used, it should be stripped 3/4" at each end before cleaning with emery paper.
2. Attach bronze clamps to pipe. Tighten screws.
3. Attach wire to clamps as shown. Tighten screws.

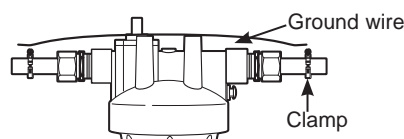

STEP-BY-STEP INSTALLATION INSTRUCTIONS (cont.)

Final Check

1. Install filter, if not already done (see Filter Cartridge Replacement section).
2. Slowly turn on water supply.
3. Check entire system for leaks.
4. If leaking from fittings, shut off water pressure and tighten or reseal fittings. If leaking from the canister, tighten canister with a wrench.
5. After installation, open any downstream faucet and flush the cartridge for 10 minutes (40 gallons), wait one hour, then flush again for 10 minutes (40 gallons) before using the water.

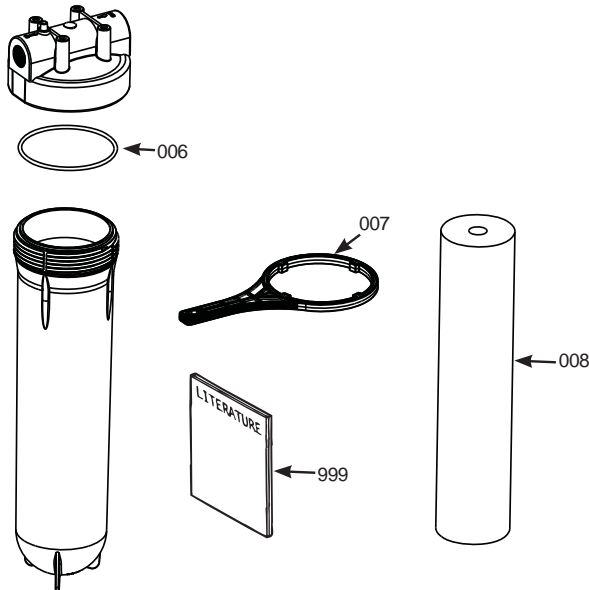

PARTS LIST

Ref. No.	Part No.	Part Description	
006	WS02X23544	O-Ring	1
007	WS02X23545	Canister Wrench	1
008	FXWPT	Filter element	1
999	31-6000259	Installation Instructions	1

To obtain replacement parts, call toll-free 800.952.5039 (US)

LIMITED ONE-YEAR WARRANTY

- What does this warranty cover?
 - Any defect in materials or workmanship in the manufactured product.
 - What does this warranty not cover?
 - Filter Cartridges.
 - Service trips to your home to teach you how to use the product.
 - Improper installation, delivery or maintenance.
 - Failure of the product if it is abused, misused, altered, used commercially or used for other than the intended purpose.
 - Use of this product where water is microbiologically unsafe or of unknown quality, without adequate disinfection before or after the housing*. Housings certified for cyst reduction may be used on disinfected water that may contain filterable cysts.
- *The term "housing" means the combination of the head and filter canister which together form a filter pressure vessel.
- Damage to the product caused by accident, fire, floods or acts of God.
 - **Incidental or consequential damage caused by possible defects with this appliance, its installation or repair.**
 - For how long after the original purchase?
 - One (1) year.

- How do I make a warranty claim?
 - Return to the retailer from which it was purchased, along with a copy of the "Proof of Purchase." A new or reconditioned unit will be provided. This warranty excludes the cost of shipping the product to your home.

EXCLUSION OF IMPLIED WARRANTIES—Your sole and exclusive remedy is product exchange as provided in this Limited Warranty. Any implied warranties, including the implied warranties of merchantability or fitness for a particular purpose, are limited to one year or the shortest period allowed by law.

This limited warranty is extended to the original purchaser and any succeeding owner for products purchased for home or office use within the USA. In Alaska, the limited warranty excludes the cost of shipping or service to your home or office.

Some states do not allow the exclusion or limitation of incidental or consequential damages. This limited warranty gives you specific legal rights, and you may also have other rights, which vary from state to state. To know what your legal rights are, consult your local or state consumer affairs office or your state's Attorney General.

Contact us at GEAppliances.com, or call toll-free at 800.952.5039 (US).