

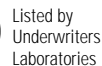

Dimensions (in inches)

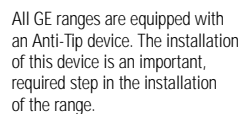

For answers to your Monogram®, GE Profile Performance Series™, GE Profile™, GE, Hotpoint and RCA appliance questions, call GE Answer Center® service, 800.626.2000.



Revised 9/97

Countertop Cutout Top View

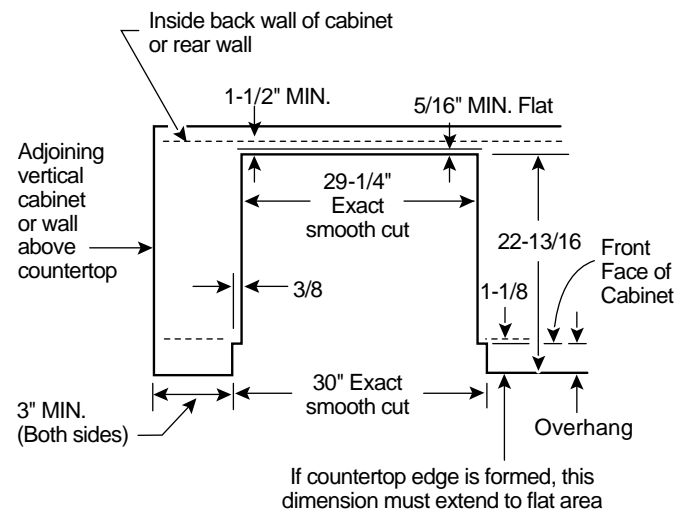

KW Rating	
240V	11.0
208V	8.7

Important: 30" Drop-In Ranges are designed to hang from the countertop. It does not rest on the floor. For installation alternatives, refer to installation instructions packed with product.

Note: 30" Drop-In Electric Ranges conform to U.L. requirements for 3" minimum spacing between range and side walls above countertop.

Installation Information: Before installing, consult installation instructions (Pub. No. 31-10129) packed with product for current dimensional data.



GE Appliances

JDS26BW—30" Drop-In Electric Range

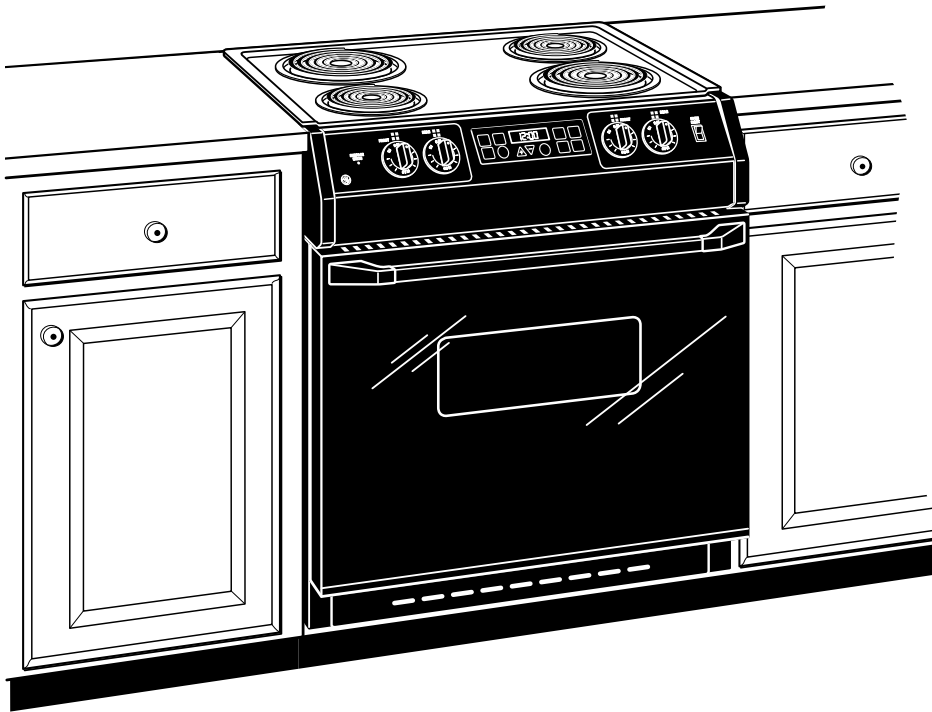

Features and Benefits

- Available In White or Almond Cooktop With Black Glass Oven Door
- Porcelain-Enameled Lift-Up Overhanging Cooktop
- Two 8" and Two 6" Plug-In Heating Elements
- Removable Chrome One-Piece Drip Bowls
- Standard Clean Oven
- SmartSet Electronic Oven Control With Touchpads
- Electronic Clock and Kitchen Timer
- Delay Time Bake Option With Cook and Hold
- Auto Oven Shut-Off With Override
- Broiler Pan With Grid
- 2 Oven Shelves
- Interior Oven Light
- Designer-Style Handle