



Top Freezer Refrigerators

Safety Instructions2, 3

Operating Instructions

Care and Cleaning6, 7
Controls4
Defrost Water Pan6
Ice Trays5
Light Bulb Replacement7
Shelves5

Installation Instructions

Preparing to Install
the Refrigerator8
Reversing the Door Swing . . .9, 10

Troubleshooting Tips11, 12

Consumer Support

Consumer Support . . .Back Cover
Product Registration13, 14
Warranty15

Owner's Manual

Model 10

Write the model and serial numbers here:

Model # _____

Serial # _____

Find these numbers on a label on
the back of the refrigerator.



IMPORTANT SAFETY INFORMATION. READ ALL INSTRUCTIONS BEFORE USING.

⚠ **WARNING!**

Use this appliance only for its intended purpose as described in this Owner's Manual.



SAFETY PRECAUTIONS

When using electrical appliances, basic safety precautions should be followed, including the following:

- This refrigerator must be properly installed and located in accordance with the Installation Instructions before it is used.
- Do not allow children to climb, stand or hang on the shelves in the refrigerator. They could damage the refrigerator and seriously injure themselves.
- Do not touch cold surfaces in the freezer compartment when hands are damp or wet. Skin may stick to these extremely cold surfaces.
- Do not store or use gasoline or other flammable vapors and liquids in the vicinity of this or any other appliance.
- Keep fingers out of the "pinch point" areas; clearances between the doors and between the doors and cabinet are necessarily small. Be careful closing doors when children are in the area.
- Unplug the refrigerator before cleaning and making repairs.
NOTE: We strongly recommend that any servicing be performed by a qualified individual.
- Setting the control to **OFF** does not remove power to the light circuit.
- Don't use an electrical device or sharp instrument in defrosting the frozen food storage compartment.
- Do not refreeze frozen foods which have thawed completely.

⚠ **DANGER! RISK OF CHILD ENTRAPMENT**

PROPER DISPOSAL OF THE REFRIGERATOR

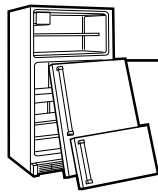

Child entrapment and suffocation are not problems of the past. Junked or abandoned refrigerators are still dangerous...even if they will sit for "just a few days." If you are getting rid of your old refrigerator, please follow the instructions below to help prevent accidents.

Before You Throw Away Your Old Refrigerator or Freezer:

- Take off the doors.
- Leave the shelves in place so that children may not easily climb inside.

CFC Disposal

Your old refrigerator may have a cooling system that used CFCs (chlorofluorocarbons). CFCs are believed to harm stratospheric ozone.

If you are throwing away your old refrigerator, make sure the CFC refrigerant is removed for proper disposal by a qualified servicer. If you intentionally release this CFC refrigerant you can be subject to fines and imprisonment under provisions of environmental legislation.



USE OF EXTENSION CORDS

Because of potential safety hazards under certain conditions, we strongly recommend against the use of an extension cord.

However, if you must use an extension cord, it is absolutely necessary that it be a UL-listed (in the United States) or a CSA-listed (in Canada), 3-wire grounding type appliance extension cord having a grounding type plug and outlet and that the electrical rating of the cord be 15 amperes (minimum) and 120 volts.

⚠ **WARNING!**



HOW TO CONNECT ELECTRICITY

Do not, under any circumstances, cut or remove the third (ground) prong from the power cord. For personal safety, this appliance must be properly grounded.

The power cord of this appliance is equipped with a 3-prong (grounding) plug which mates with a standard 3-prong (grounding) wall outlet to minimize the possibility of electric shock hazard from this appliance.

Have the wall outlet and circuit checked by a qualified electrician to make sure the outlet is properly grounded.

If the outlet is a standard 2-prong outlet, it is your personal responsibility and obligation to have it replaced with a properly grounded 3-prong wall outlet.

The refrigerator should always be plugged into its own individual electrical outlet which has a voltage rating that matches the rating plate.

This provides the best performance and also prevents overloading house wiring circuits which could cause a fire hazard from overheated wires.

Never unplug your refrigerator by pulling on the power cord. Always grip plug firmly and pull straight out from the outlet.

Repair or replace immediately all power cords that have become frayed or otherwise damaged. Do not use a cord that shows cracks or abrasion damage along its length or at either end.

When moving the refrigerator away from the wall, be careful not to roll over or damage the power cord.



USE OF ADAPTER PLUGS *(Adapter plugs not permitted in Canada)*

Because of potential safety hazards under certain conditions, we strongly recommend against the use of an adapter plug.

However, if you must use an adapter, where local codes permit, a **temporary connection** may be made to a properly grounded 2-prong wall outlet by use of a UL-listed adapter available at most local hardware stores.

The larger slot in the adapter must be aligned with the larger slot in the wall outlet to provide proper polarity in the connection of the power cord.

When disconnecting the power cord from the adapter, always hold the adapter in place with one hand while pulling the power cord plug with the other hand. If this is not done, the adapter ground terminal is very likely to break with repeated use.

If the adapter ground terminal breaks, **DO NOT USE** the refrigerator until a proper ground has been established.

Attaching the adapter ground terminal to a wall outlet cover screw does not ground the appliance unless the cover screw is metal, and not insulated, and the wall outlet is grounded through the house wiring. You should have the circuit checked by a qualified electrician to make sure the outlet is properly grounded.



READ AND FOLLOW THIS SAFETY INFORMATION CAREFULLY.

SAVE THESE INSTRUCTIONS

About the controls.

Fresh Food Temperature Control

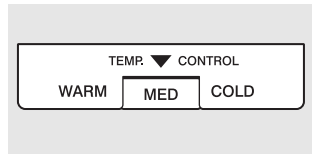

The fresh food compartment temperature control can be set at **OFF**, **MIN**, **MED** or **MAX**. It can also be set any place in between **MIN** and **MAX**.

If the refrigerator is unplugged or turned off, you must allow 3 minutes before starting it or plugging it back in. If you attempt to restart it in less than 3 minutes, it may not start.

MIN is the warmest.

MAX is the coldest.

Initially set the temperature control at **MED**. After using the refrigerator for 24 hours, adjust the temperature control to the setting that is best suited to your needs.

OFF stops cooling in both compartments, but does not shut off power to the refrigerator.

Freezer Temperature Control

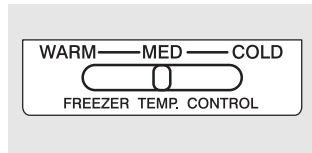

The freezer compartment temperature control can be set at **WARM**, **MED** or **COLD**, or can be set any place in between these settings.

Initially set the temperature control at **MED**. After using the refrigerator for 24 hours, adjust the temperature control to the setting that is best suited to your needs.

Air Discharge Outlets

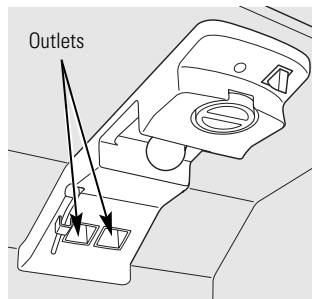

Fresh Food

Outlets are located in both the fresh food and freezer compartments. Since cold air flows from them, avoid blocking them with large items.

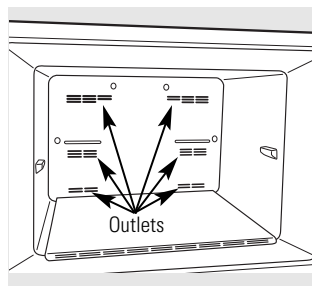

Freezer

Fresh Food Shelves

Shelves can be moved to different levels to suit your varying food storage needs.

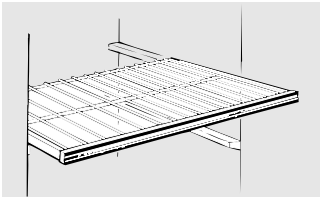

Freezer Compartment Shelf

The shelf may be removed for storage of large items. Pull up on the front of the shelf and lift it out.

About the ice trays.

Ice Trays

To release ice cubes, invert the tray, hold it over the storage bucket or bowl and twist tray at both ends.

For only one or two ice cubes, leave the tray right-side up, twist both ends slightly and remove the desired number of cubes.

Trays can be stacked to save storage space.

Do not put them in the dishwasher.

Wash the ice trays by hand. To remove mineral deposits, soak the trays in a vinegar/water solution (half vinegar and half water). Rinse well before using.

Care and cleaning of the refrigerator.

Outside

The door caps (top and bottom) can be cleaned with a cloth dampened with a solution of mild liquid dishwashing detergent and water. Dry with a soft cloth. Don't use wax on the door caps.

Keep the finish clean. Wipe with a clean cloth lightly dampened with kitchen appliance wax or mild liquid dishwashing detergent. Dry and polish with a clean, soft cloth. Do not wipe the refrigerator with a soiled dishwashing cloth or wet towel. These may leave a residue that can erode the paint. Do not use scouring pads, powdered cleaners, bleach or

cleaners containing bleach because these products can scratch and weaken the paint finish.

Protect the paint finish. With proper care, it will stay new-looking and rust-free for years. Apply a coat of kitchen/appliance wax when the refrigerator is new and then at least twice a year.

Appliance Polish Wax & Cleaner is available from GE Appliance Service and Parts Centers.

Inside

Inside the fresh food and freezer compartments should be cleaned at least once a year. Unplug the refrigerator before cleaning. If this is not practical, wring excess moisture out of sponge or cloth when cleaning around switches, lights or controls.

Apply an appliance wax/polish to the inside surface between the doors.

Use warm water and baking soda solution—about a tablespoon of baking soda to a quart of water. This both cleans and neutralizes odors. Rinse thoroughly with water and wipe dry. Other parts of

the refrigerator, including door gasket, vegetable drawer, ice trays and all plastic parts, can be cleaned the same way. Do not use cleansing powders or other abrasive cleaners.

To help prevent odors, leave an open box of baking soda in the rear of the fresh food compartment, on the top shelf. Change the box every three months. An open box of baking soda in the frozen food storage compartment will absorb stale odors.

Do not wash any plastic parts from your refrigerator in your automatic dishwasher.

Defrost Water Pan

The defrost water pan is on the back of the refrigerator. The pan should be cleaned at least once a year.

To clean the pan:

- 1 Unplug the refrigerator.
- 2 Remove the two screws holding the pan in place.
- 3 Take the pan to the sink and wash by hand using warm water and a mild detergent.
- 4 Screw the pan securely back in place to prevent defrost water from spilling onto the floor.
- 5 Plug the refrigerator back in.

Light Bulb Replacement

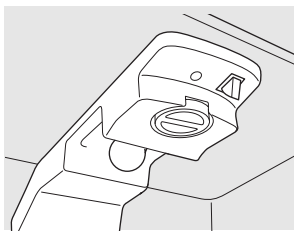

The light bulb is located at the top of the fresh food compartment just behind the temperature control.

To replace the bulb:

- 1 Unplug the refrigerator.
- 2 Unscrew the bulb and replace with a same-size, same-type bulb.
- 3 Plug the refrigerator back in.

CAUTION: Setting the fresh food control to **OFF** does not remove power to the light circuit.

Beneath the Refrigerator

- In the refrigeration process, it is normal that heat be expelled in the area under the refrigerator. Some synthetic floor coverings will discolor at these normal and safe operating temperatures. Your floor covering supplier should be consulted if you object to this discoloration.
- Care should be taken in moving your refrigerator away from the wall. All types of floor coverings can be damaged, particularly cushioned coverings and those with embossed surfaces.
- When pushing the refrigerator back, make sure you don't roll over the power cord.

When You Go on Vacation

For extended vacations or absences, remove food and unplug the refrigerator. Clean the interior with a baking soda solution of one tablespoon of soda to one quart of water. Leave doors open.

For shorter vacations, remove perishable foods and leave the control at your regular setting. However, if room temperature is expected to drop below 60°F, follow the same instructions as for extended vacations.

When You Move

Secure all loose items such as shelves, storage drawers and ice trays by taping them securely in place to prevent damage, and raise the leveling legs.

Be sure refrigerator stays in upright position during moving. Protect outside of refrigerator with blanket.

Preparing to install the refrigerator.

Location

Do not install the refrigerator where the temperature will be below 60°F. At these temperatures the refrigerator will operate, but it will not cool foods properly.

The refrigerator must be installed on a floor strong enough to support it when fully loaded.

Clearances

Allow the following clearances for ease of installation, door opening and proper air circulation:

Top: 3"
Back: 1"
Sides: 1"

Leveling Legs

Adjustable legs at the front corners of the refrigerator should be set so the refrigerator is firmly positioned on the floor, and the front is raised or tilted just enough that the doors close easily when opened about halfway.

To adjust the leveling legs, turn legs ***counterclockwise*** to raise the refrigerator, ***clockwise*** to lower it.

Installation Instructions

REVERSING THE DOOR SWING

These instructions are for changing the hinges from the right side to the left side.

If you ever want to change the hinges back to the right side, follow these same instructions (merely reverse all references to left and right).

BEFORE YOU BEGIN

- Read these instructions all the way through before starting.
- Unplug the refrigerator from its electrical outlet.
- Empty all door shelves.
- Provide a non-scratching work surface for the doors and cabinet.

ONCE YOU BEGIN

- Handle parts carefully to avoid scratching paint and losing parts.
- Set screws down by their related parts to avoid using them in the wrong places.
- When reinstalling door hinges, be sure to use the same number of washers and spacers as were originally used.

TOOLS REQUIRED

- Blade screwdriver
- Phillips screwdriver
- 5/16" socket wrench

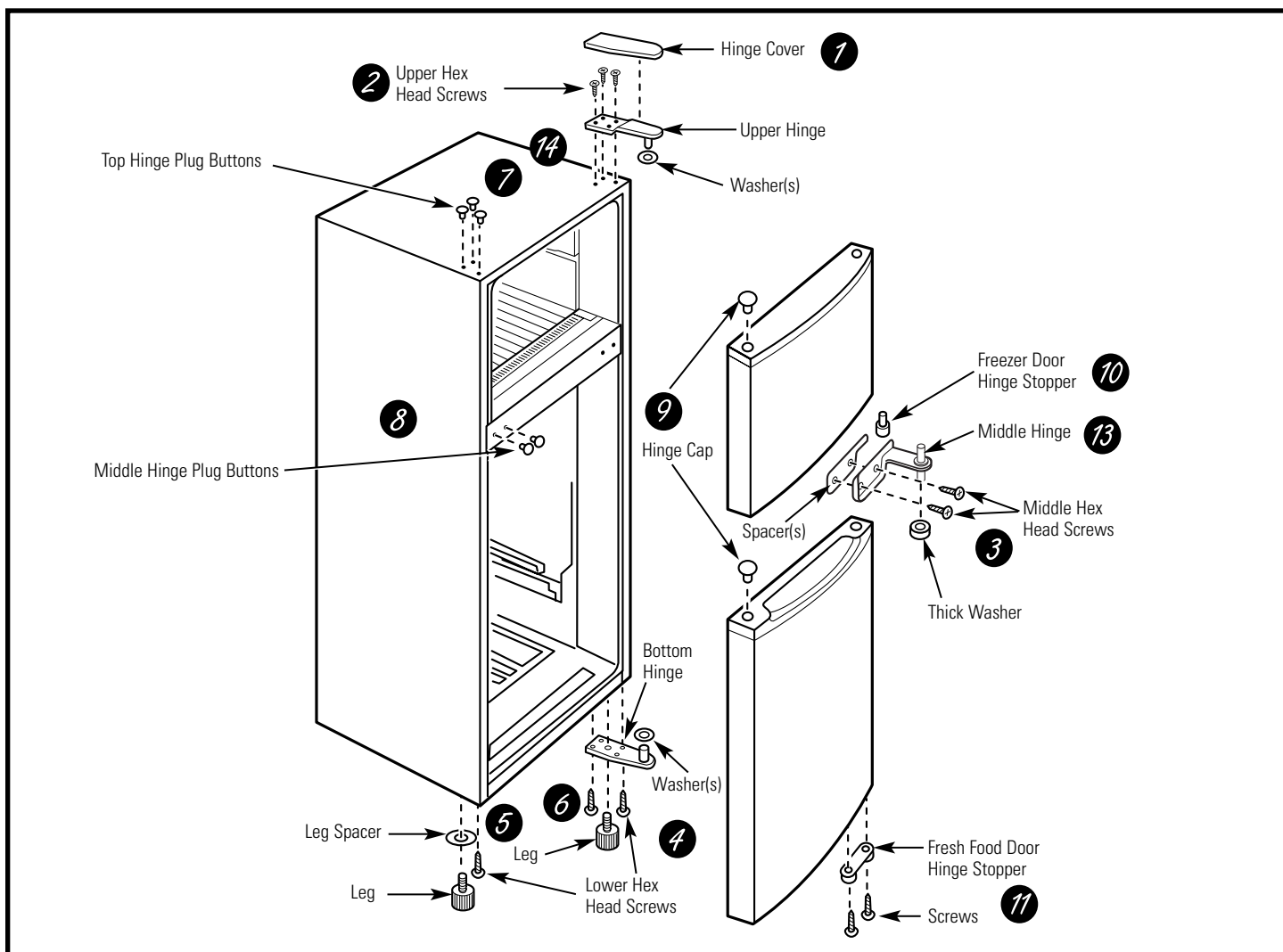

Installation Instructions

REVERSING THE DOOR SWING (CONT.)

The numbered steps below correspond to the numbers in the illustration on the previous page.

1. Lift off the hinge cover.
2. Remove the upper hex head screws and lift off the upper hinge and washer(s). Set these parts aside for reinstallation later. The freezer door can now be removed.
3. Remove the middle hex head screws and lift off the middle hinge, spacer(s) and thick washer. Set these parts aside for reinstallation later. The fresh food door can now be removed.
Tilt the refrigerator back or lay it on its side for steps 4, 5 and 6. Use a pad or blanket to protect the floor and to avoid scratching the painted finish.
4. Remove the lower hex head screws holding the bottom hinge in place. Then remove the leveling leg by turning it counterclockwise.
5. On the opposite side, remove the leveling leg and spacer by turning the leg counterclockwise. Remove the lower hex head screw that was next to the leveling leg. Install the leveling leg, spacer and screw on the opposite side.
6. Attach the bottom hinge to the opposite side using the lower hex head screws and the leveling leg. Stand the refrigerator upright.

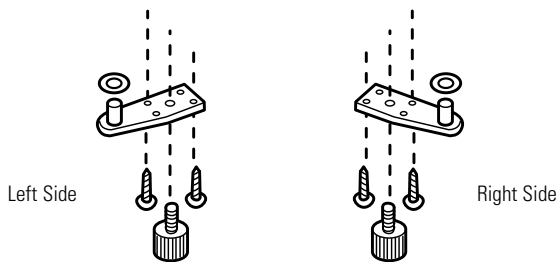

7. Remove the upper hinge plug buttons and insert them into the holes from which the screws were removed in Step 2.
8. Remove the middle hinge plug buttons and insert them into the holes from which the screws were removed in Step 3.
9. Remove the hinge caps using a thin flat blade screwdriver and insert them into the hinge holes on the opposite side.
10. Remove the freezer door hinge stopper and install it in the other side.
11. Remove the fresh food door hinge stopper and the hinge stopper screws and install them on the other side.
12. Position the fresh food door on the bottom hinge.

13. Flip the middle hinge 180°. Insert the hinge pin into the hinge hole on the top of the fresh food door, making sure the spacer(s) and thick washer are in place. Attach the hinge to the cabinet with the middle hex head screws. (Do not tighten the screw completely.)

CAUTION: If the door gasket rubs or interferes with middle hinge, remove washers on bottom hinge, one at a time, until there is no interference.

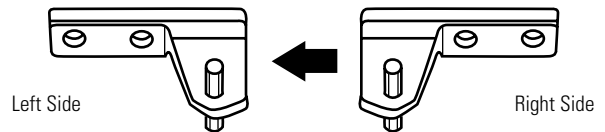

14. Position the freezer door on the middle hinge pin. Insert the hinge pin from the top hinge into the hinge hole on the top of the freezer door, making sure the washer is in place. Attach the hinge to the top of the cabinet with the upper hex head screws. (Do not tighten the screws completely.)

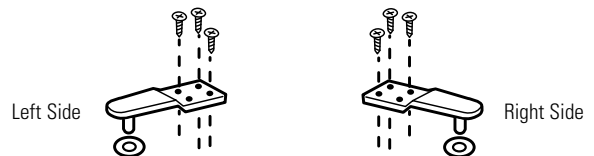

15. The door swing reversal is now complete. Before tightening screws on the top and middle hinges, check the following:

- Make sure both doors are on straight.
- Make sure that there is no space between the door gaskets and the refrigerator unit itself when the doors are closed.
- Make sure that the gasket on the hinge side is not caught between the door and the unit when the door is opened or closed. (If the door is forced closed when the gasket is caught, the gasket may be damaged.)

16. Tighten all screws and replace the top hinge cover.

When checking the above points, if it is discovered that the doors are not installed properly (this is apt to happen at the first try), loosen the screws holding the upper and middle hinges, straighten the doors and tighten the screws slowly with the socket wrench. After making sure that the doors are installed correctly, tighten all the screws holding the hinges.

If they are not tightened, the doors may slip out of position or there may be an opening between the doors and the unit.



Troubleshooting Tips
 Save time and money! Review the charts on the following pages first and you may not need to call for service.

Problem	Possible Causes	What To Do
Refrigerator does not operate	Temperature control set to OFF .	• Set the control to a temperature setting.
	Refrigerator is unplugged.	• Push the plug completely into the outlet.
	The fuse is blown/circuit breaker is tripped.	• Replace fuse or reset the breaker.
	Refrigerator is in defrost cycle.	• Wait about 30 minutes for the defrost cycle to end.
Vibration or rattling (slight vibration is normal)	Leveling legs need adjustment.	• See <i>Leveling Legs</i> .
	Floor is weak.	• Install on a floor strong enough to support the refrigerator fully loaded.
	Floor is uneven.	• Leveling legs need adjusting. See <i>Leveling Legs</i> .
Motor operates for long periods or cycles on and off frequently.	Normal when refrigerator is first plugged in.	• Wait 24 hours for the refrigerator to completely cool down.
	Often occurs when large amounts of food are placed in refrigerator.	• This is normal.
	Door left open.	• Check to see if package is holding door open. • Door not closing. Make sure refrigerator is tilted properly. See <i>Leveling Legs</i> .
	Hot weather or frequent door openings.	• This is normal.
	Temperature controls set improperly.	• See <i>About the controls</i> .
Fresh food compartment too warm	Temperature control not set cold enough.	• See <i>About the controls</i> .
	Warm weather or frequent door openings.	• Set the temperature control one step colder. See <i>About the controls</i> .
	Door left open.	• Check to see if package is holding door open.
	Air discharge outlets obstructed by large items.	• Rearrange items so outlets are not obstructed.
Fresh food compartment too cold	Temperature control set too cold.	• Set the temperature control one step warmer. See <i>About the controls</i> .
Frost or ice crystals on frozen food (frost within package is normal)	Door left open.	• Check to see if package is holding door open.
	Too frequent or too long door openings.	
Slow ice cube freezing	Temperature control not set cold enough.	• See <i>About the controls</i> .
	Door left open.	• Check to see if package is holding door open.

Before you call for service...

Problem	Possible Causes	What To Do
Ice cubes have odor/taste	Food transmitting odor/taste to ice cubes.	• Wrap foods well.
	Interior of refrigerator needs cleaning.	• See <i>Care and cleaning</i> .
Refrigerator has odor	Foods transmitting odor to refrigerator.	• Foods with strong odors should be tightly wrapped. • Keep an open box of baking soda in the refrigerator; replace every three months.
	Interior needs cleaning.	• See <i>Care and cleaning</i> .
	Defrost water pan needs cleaning.	• See <i>Care and cleaning</i> .
Moisture forms on outside of refrigerator	Not unusual during periods of high humidity.	• Wipe surface dry.
Moisture collects inside the refrigerator	In humid weather, air carries moisture into the refrigerator when doors are opened.	• Prevent too frequent or too long door openings.
Interior light does not work	No power at outlet.	• Replace fuse or reset the breaker.
	Light bulb burned out.	• See <i>Replacing the light bulbs</i> .
	Light bulb is loose.	• Make sure light bulb is screwed all the way in.

GE Service Protection Plus™

GE, a name recognized worldwide for quality and dependability, offers you Service Protection Plus™—comprehensive protection on all your appliances—**No Matter What Brand!**

Benefits Include:

- Backed by GE
- All brands covered
- Unlimited service calls
- All parts and labor costs included
- No out-of-pocket expenses
- No hidden deductibles
- One 800 number to call

***We'll Cover Any Appliance.
Anywhere. Anytime.****

You will be completely satisfied with our service protection or you may request your money back on the remaining value of your contract. No questions asked. It's that simple.

Protect your refrigerator, dishwasher, washer and dryer, range, TV, VCR and much more—**any brand!** Plus there's no extra charge for emergency service and low monthly financing is available. Even icemaker coverage and food spoilage protection is offered. You can rest easy, knowing that all your valuable household products are protected against expensive repairs.

Place your confidence in GE and call us in the U.S. toll-free at **800.626.2224** for more information.

*All brands covered, up to 20 years old, in the continental U.S.

 Cut here

Please place in envelope and mail to:

General Electric Company
Warranty Registration Department
P.O. Box 32150
Louisville, KY 40232-2150

Consumer Product Ownership Registration

Dear Customer:

Thank you for purchasing our product and thank you for placing your confidence in us. We are proud to have you as a customer!

Follow these three steps to protect your new appliance investment:

1

Complete and mail your Consumer Product Ownership Registration today. Have the peace of mind of knowing we can contact you in the unlikely event of a safety modification.

2

After mailing the registration below, store this document in a safe place. It contains information you will need should you require service. Our service number is 800.GE.CARES (800.432.2737).

3

Read your Owner's Manual carefully. It will help you operate your new appliance properly.

Model Number

Serial Number

Important: If you did not get a registration card with your product, detach and return the form below to ensure that your product is registered, or register online at GEAppliances.com.

 Cut here

Consumer Product Ownership Registration



Model Number

Serial Number

Mr. Ms. Mrs. Miss

First Name

Last Name

Street Address

Apt. #

E-mail Address*

City

State

Zip Code

Date Placed In Use
Month

Day

Year

Phone Number --

* Please provide your e-mail address to receive, via e-mail, discounts, special offers and other important communications from GE Appliances (GEA).

Check here if you do not want to receive communications from GEA's carefully selected partners.



GE Appliances

General Electric Company
Louisville, Kentucky
GEAppliances.com

Refrigerator Warranty.



All warranty service provided by our Factory Service Centers, or an authorized Customer Care® technician. To schedule service, on-line, 24 hours a day, visit us at GEAppliances.com, or call 800.GE.CARES (800.432.2737).

Staple your receipt here.
Proof of the original purchase date is needed to obtain service under the warranty.

For The Period Of: GE Will Replace:

One Year

From the date of the original purchase

Any part of the refrigerator which fails due to a defect in materials or workmanship. During this **full one-year warranty**, GE will also provide, **free of charge**, all labor and in-home service to replace the defective part.

Five Years

From the date of the original purchase

Any part of the sealed refrigerating system (the compressor, condenser, evaporator and all connecting tubing) which fails due to a defect in materials or workmanship. During this **additional four-year limited warranty**, GE will also provide, **free of charge**, all labor and in-home service to replace the defective part in the sealed refrigerating system.

What GE Will Not Cover:

- Service trips to your home to teach you how to use the product.
- Improper installation.
- Failure of the product if it is abused, misused, or used for other than the intended purpose or used commercially.
- Loss of food due to spoilage.
- Replacement of house fuses or resetting of circuit breakers.
- Damage to the product caused by accident, fire, floods or acts of God.
- Incidental or consequential damage caused by possible defects with this appliance.

This warranty is extended to the original purchaser and any succeeding owner for products purchased for home use within the USA. In Alaska, the warranty excludes the cost of shipping or service calls to your home.

Some states do not allow the exclusion or limitation of incidental or consequential damages. This warranty gives you specific legal rights, and you may also have other rights which vary from state to state. To know what your legal rights are, consult your local or state consumer affairs office or your state's Attorney General.

Warrantor: General Electric Company, Louisville, KY 40225

Safety Instructions

Operating Instructions

Installation Instructions

Troubleshooting Tips

Consumer Support

Consumer Support.



GE Appliances Website

GEAppliances.com

Have a question or need assistance with your appliance? Try the GE Appliances Website 24 hours a day, any day of the year! For greater convenience and faster service, you can now download Owner's Manuals, order parts, catalogs, or even schedule service on-line. You can also "Ask Our Team of Experts™" your questions, and so much more...



Schedule Service

GEAppliances.com

Expert GE repair service is only one step away from your door. Get on-line and schedule your service at your convenience 24 hours any day of the year! Or call 800.GE.CARES (800.432.2737) during normal business hours.



Real Life Design Studio

GEAppliances.com

GE supports the Universal Design concept—products, services and environments that can be used by people of all ages, sizes and capabilities. We recognize the need to design for a wide range of physical and mental abilities and impairments. For details of GE's Universal Design applications, including kitchen design ideas for people with disabilities, check out our Website today. For the hearing impaired, please call 800.TDD.GEAC (800.833.4322).



Extended Warranties

GEAppliances.com

Purchase a GE extended warranty and learn about special discounts that are available while your warranty is still in effect. You can purchase it on-line anytime, or call 800.626.2224 during normal business hours. GE Consumer Home Services will still be there after your warranty expires.

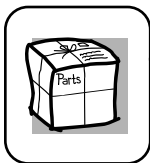

Parts and Accessories

GEAppliances.com

Individuals qualified to service their own appliances can have parts or accessories sent directly to their homes (VISA, MasterCard and Discover cards are accepted). Order on-line today, 24 hours every day or by phone at 800.626.2002 during normal business hours.

Instructions contained in this manual cover procedures to be performed by any user. Other servicing generally should be referred to qualified service personnel. Caution must be exercised, since improper servicing may cause unsafe operation.

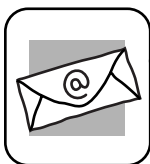

Contact Us

GEAppliances.com

If you are not satisfied with the service you receive from GE, contact us on our Website with all the details including your phone number, or write to: General Manager, Customer Relations
GE Appliances, Appliance Park
Louisville, KY 40225



Register Your Appliance

GEAppliances.com

Register your new appliance on-line—at your convenience! Timely product registration will allow for enhanced communication and prompt service under the terms of your warranty, should the need arise. You may also mail in the pre-printed registration card included in the packing material.