



GE 30" and Spacemaker™ 27" Drop-In Electric Ranges



We bring good things to life.

GE 30" And Spacemaker™ 27" Drop-In Electric Ranges Provide A True Built-In Look And Innovative Features



Lift-Up Overhanging Porcelain-Enameled Cooktop

Lift-up cooktop stays up for access to easy clean subtop. Overhanging design provides a true, built-in look.



Frameless Glass Oven Door With Window

Check food as it cooks without opening oven door and allowing valuable heat to escape. Oven lights for easy viewing. The frameless glass oven door has a designer-style handle, Soft Sure Grip on Profile™ models, that provides a strong, durable and convenient grip; and doubles as a towel bar handle.

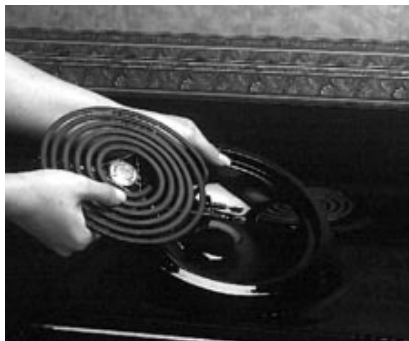

Plug-In Calrod® Heating Elements With One-Piece Drip Bowls

The removable Calrod® surface elements assure fast, clean cooking and even heat distribution. Elements unplug easily for removal of one-piece drip bowls for cleaning and access to subtop. (Calrod® heating elements available on Spacemaker™ 27" models.)

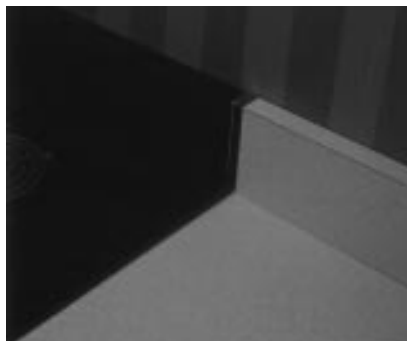

Spacemaker™ 27" Optional Backguard Kit

Optional backguard kit in white, almond or black painted finish is available at additional cost for all models.

JX27RWH—White

JX27RBK—Black

JX27RAD—Almond



Model JMP29GV



Model JDP37GV

Electronic Oven Control With Automatic Oven Timer

Easy-to-use, electronic touchpads allow you to select cooking function, oven temperature and cooking time with a touch of a finger. The digital display shows selected function and simultaneously displays oven temperature and time. Electronic clock gives time of day, serves as a minute timer, and controls automatic oven operation including delayed cooking.

Quality GE 30" Drop-In Electric Ranges



JDP39WV

- White on white • Self-cleaning oven with automatic oven door lock
- Electronic oven control with touchpads
- Electronic digital clock and automatic oven timer
- Removable one-piece drip bowls • Lift-up overhanging porcelain-enameled cooktop • Two 8" and two 6" plug-in heating elements • Lift-off frameless glass oven door with window • Interior oven light • Designer-style handle • Auto oven shut-off



JDP37GV

- Black on black • Self-cleaning oven with automatic oven door lock • Electronic oven control with touchpads • Electronic digital clock and automatic oven timer • Removable one-piece drip bowls • Lift-up overhanging porcelain-enameled cooktop • Two 8" and two 6" plug-in heating elements • Lift-off frameless glass oven door with window • Interior oven light • Designer-style handle • Auto oven shut-off



JDP36GV

- Self-cleaning oven with automatic oven door lock • Electronic oven control with touchpads • Electronic digital clock and automatic oven timer • Removable one-piece drip bowls • Lift-up overhanging white or almond porcelain-enameled cooktop • Two 8" and two 6" plug-in heating elements • Lift-off frameless glass oven door with window • Interior oven light • Designer-style handle • Auto oven shut-off



JDS26GV

- Standard clean oven • Electronic oven control with touchpads • Electronic digital clock and automatic oven timer • Removable one-piece drip bowls • Lift-up overhanging white or almond porcelain-enameled cooktop • Two 8" and two 6" plug-in heating elements • Lift-off frameless glass oven door with window • Interior oven light • Designer-style handle • Auto oven shut-off



JDC27GV

- Continuous clean oven • Electronic oven control with touchpads • Electronic digital clock and automatic oven timer • Removable one-piece drip bowls • Lift-up overhanging brushed-chrome cooktop • Two 8" and two 6" plug-in heating elements • Lift-off frameless glass oven door with window • Interior oven light • Designer-style handle • Auto oven shut-off

■ GE Profile™ Spacemaker™ 27" Drop-In Electric Ranges



The GE Profile™ Spacemaker™ 27" Drop-In Electric Ranges provide a sophisticated and stylish alternative to ordinary kitchen upgrades. The custom look and integrated appearance of these models brings convenience, flexibility, and elegance to nearly any rejuvenation project.

Whether as a collection or standing alone, Profile appliances make a striking addition and are available in energizing White on white, or sleek Black on black. While contemporary favorites, they are also classics that will stand up to the pressure of fashion over time.

■ Profile™ Model JMP31WW

- White on white • Self-cleaning oven with automatic oven door lock • Electronic oven control with automatic oven timer • Electronic clock and minute timer • Touchpad controls • Frameless glass oven door with window • Chrome drip bowls • Soft Sure Grip handle • Auto oven shut-off



■ Profile™ Model JMP29GV

- Black on black • Self-cleaning oven with automatic oven door lock • Electronic oven control with automatic oven timer • Electronic clock and minute timer • Touchpad controls • Frameless glass oven door with window • Porcelain-enameled drip bowls • Soft Sure Grip handle • Auto oven shut-off

Quality GE Spacemaker™ 27" Drop-In Electric Ranges



JMP28GV

- Self-cleaning oven with automatic oven door lock
- White or almond cooktop
- Electronic oven control with automatic oven timer
- Electronic clock and minute timer
- Touchpad controls
- Frameless glass oven door with window
- Porcelain-enameled drip bowls
- Designer-style handle
- Auto oven shut-off



JMS08GV

- Standard clean oven
- White or almond cooktop
- Rotary oven controls
- Frameless glass oven door with window
- Chrome drip bowls
- Designer-style handle

GE 30" Drop-In Electric Ranges

Features	JDP39WW	JDP37GV	JDP36GV	JDC27GV	JDS26GV
Oven cleaning	Self-Clean	Self-Clean	Self-Clean	Continuous Clean	Standard Clean
Color appearance	WW	BB	AD/WH*	BC	AD/WH*
Overall oven interior dimensions (WxHxD in inches)	22-3/4 x 15-3/4 x 17				
Oven shelves	2	2	2	2	2
Broiler pan with grid	•	•	•	•	•
Lift-off oven door	•	•	•	•	•
Automatic self-clean oven door lock	•	•	•	•	•
Frameless oven door with window	White Glass	Black Glass	Black Glass	Black Glass	Black Glass
Designer-style handle	•	•	•	•	•
Electronic oven control	•	•	•	•	•
Automatic oven timer	Electronic	Electronic	Electronic	Electronic	Electronic
Auto oven shut-off	•	•	•	•	•
Clock and minute timer	Electronic w/12-Hr. Timer	Electronic w/12-Hr. Timer	Electronic w/12-Hr. Timer	Electronic w/12-Hr. Timer	Electronic w/12-Hr. Timer
Infinite heat controls	•	•	•	•	•
Touchpad oven controls	•	•	•	•	•
Interior oven light	•	•	•	•	•
Lift-up overhanging cooktop	White Porcelain-Enameled	Black Porcelain-Enameled	White or Almond Porcelain-Enameled	Brushed-Chrome	White or Almond Porcelain-Enameled
8" heating elements	2	2	2	2	2
6" heating elements	2	2	2	2	2
Heating elements	Plug-in	Plug-in	Plug-in	Plug-In	Plug-In
Removable one-piece drip bowls	Chrome	Black Porcelain-Enameled	Chrome	Chrome	Chrome
Heating element "ON" indicator light	•	•	•	•	•
KW rating @ 240V	11.6	11.6	11.6	11.6	11.0
208V	8.7	8.7	8.7	8.7	8.7
Approx. shipping weight (lbs.)	144	144	144	125	128

WW = White, BB = Black on black, AD = Almond, WH = White, BC = Chrome

*Almond or white cooktop with black glass door.

Dimensions (in inches)

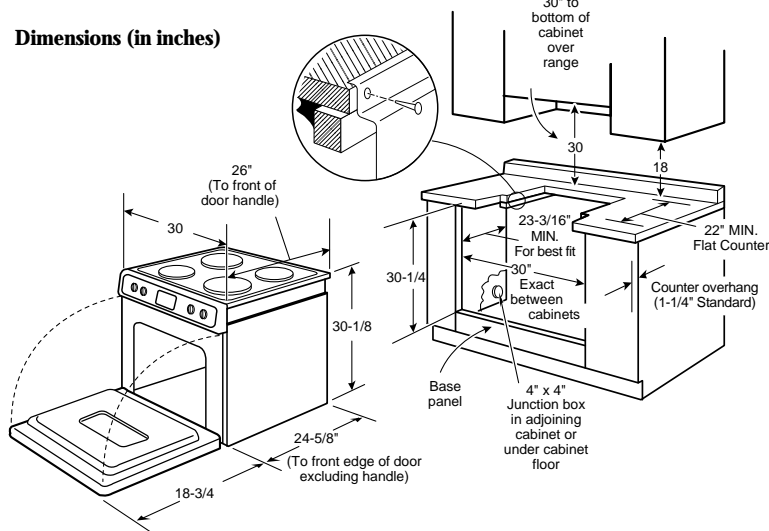

Warranty Information

Full One-Year Warranty (parts and labor free of charge) applies to the entire oven. See written warranty for details.

Countertop Cutout Top View

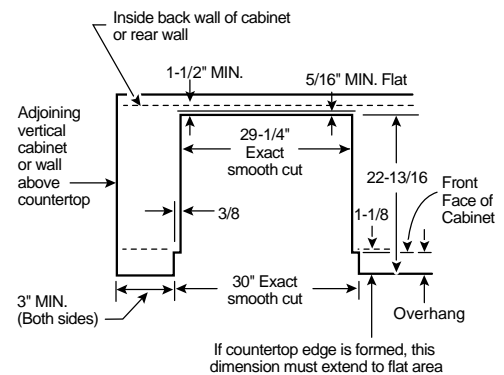

Important: 30" Drop-In Ranges are designed to hang from the countertop. It does not rest on the floor. For installation alternatives, refer to installation instructions packed with product.

Installation Information: Before installing, consult installation instructions (Pub. No. 31-10129) packed with product for current dimensional data.

Note: 30" Drop-In Ranges conform to requirements for 3" minimum spacing between range and adjacent side walls above countertop.

GE Spacemaker™ 27" Drop-In Electric Ranges

Features	GE Profile™ Models		JMP28GV	JMS08GV
	JMP31WV	JMP29GV		
Color appearance	WW	BB	AD/WH*	AD/WH*
Oven cleaning	Self-cleaning	Self-cleaning	Self-cleaning	Standard clean
Overall oven interior dimensions (WxHxD in inches)	19x15x18			
Oven shelves	2	2	2	2
Broiler pan with grid	•	•	•	•
Lift-off oven door	•	•	•	•
Automatic self-clean oven door lock	•	•	•	•
Frameless oven door with window	White Glass	Black Glass	Black Glass	Black Glass
Designer-style handle	Soft Sure Grip	Soft Sure Grip	•	•
Electronic oven control	•	•	•	•
Automatic oven timer	Electronic	Electronic	Electronic	•
Clock and minute timer	Electronic Digital	Electronic Digital	Electronic Digital	•
Auto oven shut-off	•	•	•	•
Infinite heat controls	•	•	•	•
Touchpad oven controls	•	•	•	•
Interior oven light	•	•	•	•
Lift-up overhanging cooktop	White Porc.-Enam.	Black Porc.-Enam.	Almond or White Porcelain-Enameled	Almond or White Porcelain-Enameled
8" heating elements	1	1	1	1
6" heating elements	3	3	3	3
Plug-in Calrod® heating elements	•	•	•	•
Removable one-piece drip bowls	Chrome	Porcelain-Enameled	Porcelain-Enameled	Chrome
Heating element "ON" indicator light	•	•	•	•
KW rating @ 240V	9.8	9.8	9.8	10.1
208V	7.3	7.3	7.3	7.6
Approx. shipping weight (lbs.)	119	119	119	119

WW = White on white, BB = Black on black, WH = White, AD = Almond

*Almond or White cooktop with black glass door.

Optional backguard in white, black or almond is available at additional cost for all models. JX27RWH = White, JX27RBK = Black or JX27RAD = Almond.

Dimensions (in inches)

Important: This range is designed to hang from the countertop. It does not rest on the floor.

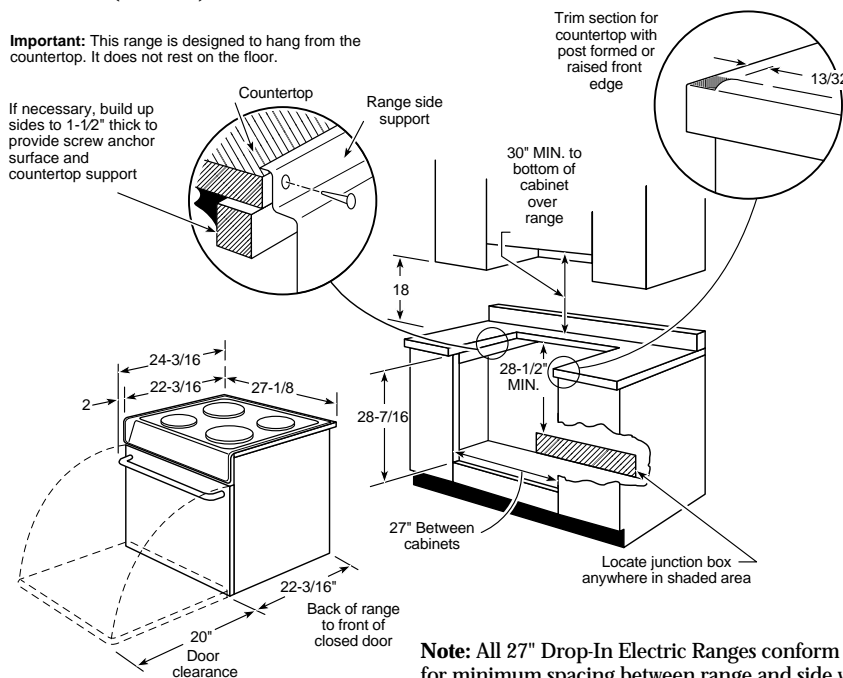

Countertop Cutout Top View

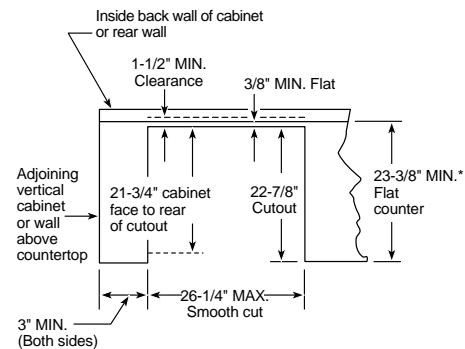

*If countertop edge is formed, this dimension must extend to flat area

In replacement installation, use JX27R optional backguard, if required

Note: All 27" Drop-In Electric Ranges conform to U.L. requirements for minimum spacing between range and side wall above countertop.

Note: Before installing, consult installation instructions (Pub. No. 31-10116) packed with product for current dimensional data.

Optional Backguard

(Available at additional cost)

JX27RBK = Black

JX27RWH = White

JX27RAD = Almond

GE Consumer Service.

No matter what major appliance you buy from GE, you always get more than a quality product. You receive the added assurance that, should you ever need our help, we'll be there.



Provide Expert In-Home Repair Service

When you need service for your GE, Hotpoint or RCA appliance, a GE Consumer Service or authorized Customer Care® professional will be there. Many GE Consumer Service company-operated locations offer you service today or tomorrow, or at your convenience:
Weekdays 6 a.m. to 11 p.m. EST
Saturday 7 a.m. to 8 p.m. EST
Sunday 9 a.m. to 7 p.m. EST
For local service in your area, call 1-800-GE-CARES (1-800-432-2737).



Answer Your Questions

Have a question about a GE major appliance? GE Answer Center® consumer information service is there to help, 24 hours a day, every day of the year. **Call 800.626.2000.**



GE Appliances

General Electric Company
Louisville, Kentucky 40225

GE has a policy of continuous improvement on its products and reserves the right to change materials and specifications without notice.



Listed by
Underwriters Laboratories

Pub. No. 3-S175
Printed in U.S.A.
PG3800