

HOTPOINT®

HTS18BCP – Hotpoint 18.0 Cu. Ft. Top-Freezer Refrigerator with Icemaker

Front View

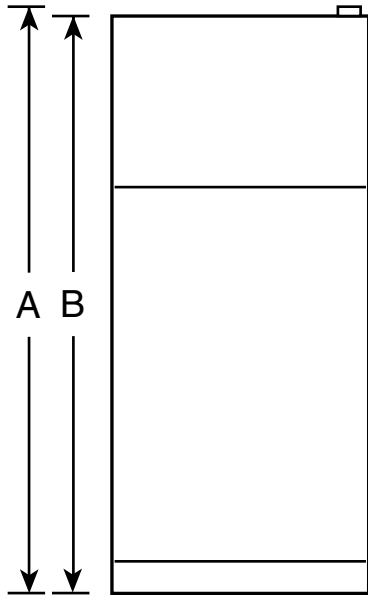

Top View

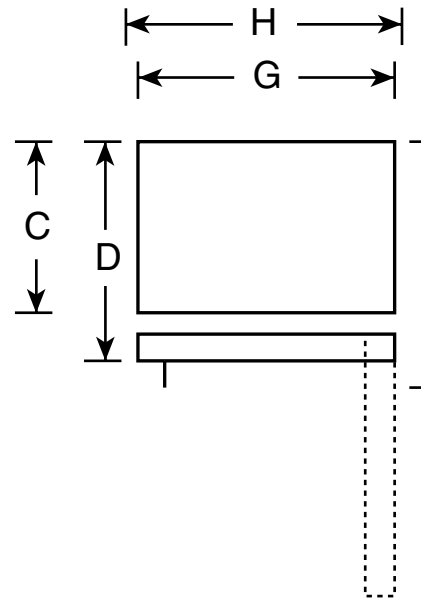

Overall Dimensions	Height to top of hinge (in.) A	66-5/8
	Height to top of case (in.) B	66-1/8
	Case depth without door (in.) C	27-1/2
	Case depth less door handle (in.) D	30-1/4
	Case depth with door handle (in.) E	32-1/8
	Depth with fresh food door open 90° (in.) F	58-1/8
	Width (in.) G	29-1/2
Air Clearances	Width with door open 90° with door handle (in.) H	32
	Each side (in.)	1/8
	Top (in.)	1
	Back (in.)	1

Note: Before installing, consult installation instructions packed with product for current dimensional data.

Note: All Top-Freezer No-Frost Right-Hand Refrigerator Doors: As you face the front of the refrigerator, the handle is on your left and the hinges are on your right.

All Top-Freezer No-Frost Left-Hand Refrigerator Doors: As you face the front of the refrigerator, the handle is on your right and the hinges are on your left.



Total volume and shelf area are calculated by the Association of Home Appliance Manufacturers' standards.



Listed by Underwriters Laboratories



HOTPOINT®

HTS18BCP – Hotpoint 18.0 Cu. Ft. Top-Freezer Refrigerator with Icemaker

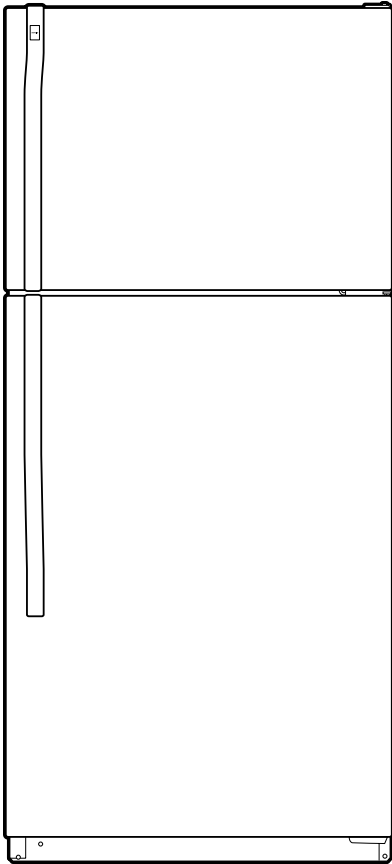

Features and Benefits

- Upfront Temperature Controls – Are positioned up front, close at hand, for maximum convenience and ease of use.
- Vegetable/Fruit Crisper – Provides the ideal storage environment for your fruits and vegetables.
- Electronic Icemaker – Makes ice automatically, ensuring a ready supply.
- Gallon Door Storage – Makes room for milk and any other gallon size containers.
- Contoured Doors – Create a high-fashion look with gently rounded doors and edges.
- NeverClean™ Condenser – Condenser coils are encased, so they don't require cleaning in normal operating environments.
- Model HTS18BCPWW – White on white

