

HUF13LTRWW

Hotpoint® 13.0 Cu. Ft. Frost-Free Upright Freezer

DIMENSIONS AND INSTALLATION INFORMATION (IN INCHES)

FRONT VIEW

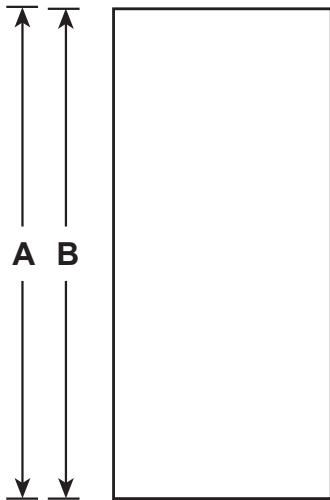

TOP VIEW

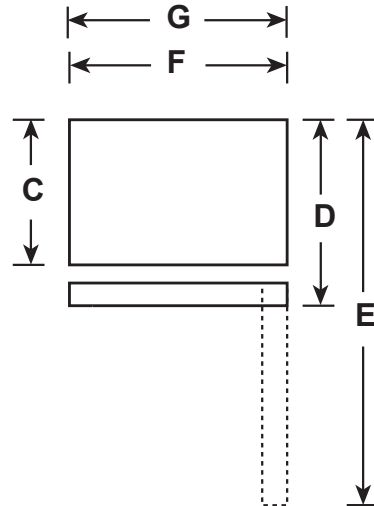

OVERALL DIMENSIONS	Height to top of hinge (in.) A	65
	Height to top of case (in.) B	64-1/2
	Case depth without door (in.) C	23
	Case depth no handle (in.) D	26-1/2
	Depth with door open 90° (in.) E	52
	Width (in.) F	27-4/5
	Width with door open 90° no handle (in.) G	29
AIR CLEARANCES	Each side (in.)	3
	Top (in.)	3
	Back (in.)	2

Hotpoint®

For answers to your Monogram, GE Café™, GE Profile™ or GE Appliances product questions, visit our website at geappliances.com or call GE Answer Center® Service, 800.626.2000.

Specification Revised 8/22

HUF13LTRWW

Hotpoint® 13.0 Cu. Ft. Frost-Free Upright Freezer

FEATURES AND BENEFITS

Total Capacity: 13.0 Cu. Ft.

ADA Compliant: Yes

Energy Star: No

Door Swing: Right

Door Exterior Style: High Gloss Smooth Steel

Shelves: Glass

Control Type: Interior Electronic

Internal Lighting: LED

Colors Available: White

Case Color: Textured Steel, White

Warranty: Limited 1-year entire appliance

Model HUF13LTRWW - White

